



Product Selection Guide

Size and Performance Data ..... AW-IR-2

Sound Transmission Class and Outdoor-Indoor Transmission Class..... AW-IR-2

Glazing Performance ..... AW-IR-3

Combination Assemblies ..... AW-IR-4

Grille Types

Grille Profiles ..... AW-IR-5

Typical Grille Patterns ..... AW-IR-6

Size Tables

Awning—Clad ..... AW-IR-7

Detailed Product Descriptions

Pella® Reserve™ Traditional..... AW-IR-10

Pella® Reserve™ Contemporary ..... AW-IR-11

Unit Sections

Pella® Reserve™ Traditional..... AW-IR-12

Pella® Reserve™ Contemporary ..... AW-IR-13

**Abbreviations:**

P = Pending. Data not available at time of publication. Go to [www.Pella.com](http://www.Pella.com) for most current technical data.

PVB = Polyvinyl butyral. This is a laminate material used in Pella Impact-Resistant glazing and is the same material traditionally used in car windshield applications.

SGP = SentryGlas® Plus from DuPont®. This is a stiffer laminate material which is optional in select impact-resistant glazing products.

HA = High Altitude Glass.

SentryGlas Plus and DuPont are registered trademarks of E.I. du Pont de Nemours & Company.

**Supporting documents for this product:**

- CSI Specs (readable using Microsoft Word or other text editing application):  
[https://media.pella.com/professional/adm/Wood-CSI\\_Specs/08551-HIG.rtf](https://media.pella.com/professional/adm/Wood-CSI_Specs/08551-HIG.rtf)
- AIA Masterspec (readable using Microsoft Word or other text editing application):  
[https://media.pella.com/professional/adm/Wood-CSI\\_Specs/Masterspec/085200\\_fl.doc](https://media.pella.com/professional/adm/Wood-CSI_Specs/Masterspec/085200_fl.doc)
- Detailed Product Description (readable using Microsoft Word or other text editing application):  
Pella Reserve Traditional: <https://media.pella.com/professional/adm/Clad-Wood/PR-ImpactResistant-Awning-C.rtf>  
Pella Reserve Contemporary: <https://media.pella.com/professional/adm/Clad-Wood/PRC-Awning-C.rtf>
- Size Tables (requires appropriate CAD software to read and use):  
[https://media.pella.com/professional/adm/Clad-Wood/ASCAWE\\_D.dwg](https://media.pella.com/professional/adm/Clad-Wood/ASCAWE_D.dwg)
- CAD cross sections (requires appropriate CAD software to read and use):  
Traditional: [https://media.pella.com/professional/adm/Clad-Wood/PR-AW-Detail\\_D.dwg](https://media.pella.com/professional/adm/Clad-Wood/PR-AW-Detail_D.dwg)  
Contemporary: [https://media.pella.com/professional/adm/Clad-Wood/PRC-AW-Detail\\_D.dwg](https://media.pella.com/professional/adm/Clad-Wood/PRC-AW-Detail_D.dwg)
- 3D & BIM (requires appropriate software to read and use):  
<https://media.pella.com/professional/adm/RevitFiles/PR-Revit/Window-Awning-Pella-Reserve-Traditional.zip>
- Sketchup (requires appropriate software to read and use):  
[https://media.pella.com/professional/adm/Clad-Wood/PellaSKP\\_PellaReserve\\_Traditional\\_Awning.zip](https://media.pella.com/professional/adm/Clad-Wood/PellaSKP_PellaReserve_Traditional_Awning.zip)
- Installation Details:  
[https://media.pella.com/professional/adm/Clad-Wood/F\\_InstallationDetails.pdf](https://media.pella.com/professional/adm/Clad-Wood/F_InstallationDetails.pdf)

The information published in this document is believed to be accurate at the time of publication. However, because we are constantly working to improve our products, specifications are subject to change without notice. Consult your local Pella representative for up-to-date product information.

Microsoft and Microsoft Word are registered trademarks of Microsoft Corp.



# Pella® Reserve™ Impact-Resistant Awning Window

## Size and Performance Data

	Clad
<b>Sizes</b>	
Standard Vent/Fixed Sizes	●
Standard Fixed Sizes	●
Special Sizes Available	●
<b>Impact-Resistant Performance<sup>1</sup></b>	
Meets or Exceeds AAMA/WDMA Ratings	LC75 - LC+75/-85 Hallmark Certified
Air Infiltration (cfm/ft <sup>2</sup> of frame @ 1.57 psf wind pressure)	0.05
Water Resistance	11.25 psf
Design Pressure	+/-75 - +75/-85 psf
<b>Other Performance Criteria</b>	
Forced Entry Resistance Level (Minimum Security Grade) <sup>2</sup>	10
Operating Force (lb) Initiate Motion / Maintain Motion (of Hallmark tested size and glazing) <sup>3</sup>	15/6

(1) Maximum performance for single unit when glazed with the appropriate glass thickness. See Design Data pages in this section for specific product performance class and grade values.

(2) The higher the level, the greater the product's ability to resist forced entry.

(3) Glazing configurations may result in higher operational forces.



# Pella® Reserve™ Impact-Resistant Awning Window

## Glazing Performance - Total Unit

Glazing Thickness	Type of Glazing	NFRC Certified Product #	Glass (mm)		Gap Fill	Performance Values <sup>1</sup>				Shaded Areas Meet ENERGY STAR® Performance Criteria in Zones Shown				
			Ext.	Int.		U-Factor	SHGC	VLT	CR	U. S.		Canada <sup>2</sup>		
										Zone			ER	
<b>Laminated Impact-Resistant Glass</b>										N	NC	SC	S	CA
11/16"	Clear	PEL-N-30-14475-00001	3	8	air	0.48	0.53	0.58	40					
	with grilles-between-the-glass	PEL-N-30-14476-00001				0.49	0.48	0.52	40					
	with integral grilles	PEL-N-30-14477-00001				0.49	0.48	0.52	40					
11/16"	Advanced Low-E IG	PEL-N-30-14603-00001	3	8	argon	0.34	0.27	0.49	52					
	with grilles-between-the-glass	PEL-N-30-14604-00001				0.35	0.25	0.44	52					
	with integral grilles	PEL-N-30-14605-00001				0.35	0.25	0.44	52					
11/16"	SunDefense™ Low-E IG	PEL-N-30-14599-00001	3	8	argon	0.33	0.20	0.45	52					
	with grilles-between-the-glass	PEL-N-30-14600-00001				0.35	0.19	0.41	52					
	with integral grilles	PEL-N-30-14601-00001				0.34	0.19	0.41	52					
1"	Clear	PEL-N-30-14523-00001	5	10	air	0.45	0.52	0.57	42					
	with grilles-between-the-glass	PEL-N-30-14524-00001				0.44	0.47	0.52	42					
	with integral grilles	PEL-N-30-14525-00001				0.44	0.47	0.52	42					
1"	Advanced Low-E IG	PEL-N-30-14683-00001	5	10	argon	0.29	0.26	0.48	54					
	with grilles-between-the-glass	PEL-N-30-14684-00001				0.29	0.24	0.44	54					
	with integral grilles	PEL-N-30-14685-00001				0.29	0.24	0.44	54					
1"	SunDefense Low-E IG	PEL-N-30-14679-00001	5	10	argon	0.28	0.20	0.45	54			SC	S	
	with grilles-between-the-glass	PEL-N-30-14680-00001				0.29	0.19	0.41	54				S	
	with integral grilles	PEL-N-30-14681-00001				0.29	0.19	0.41	54				S	
<b>Tinted Glazing Laminated Impact-Resistant</b>														
11/16"	Bronze Advanced Low-E IG	PEL-N-30-14603-00002	3	8	argon	0.34	0.25	0.29	52					
	with grilles-between-the-glass	PEL-N-30-14604-00002				0.35	0.23	0.26	52					
	with integral grilles	PEL-N-30-14605-00002				0.35	0.23	0.26	52					
1"	Bronze IG	PEL-N-30-14523-00002	5	10	air	0.45	0.39	0.37	42					
	with grilles-between-the-glass	PEL-N-30-14524-00002				0.44	0.36	0.33	42					
	with integral grilles	PEL-N-30-14525-00002				0.44	0.36	0.33	42					
11/16"	Gray Advanced Low-E IG	PEL-N-30-14603-00003	3	8	argon	0.34	0.25	0.23	52					
	with grilles-between-the-glass	PEL-N-30-14604-00003				0.35	0.23	0.21	52					
	with integral grilles	PEL-N-30-14605-00003				0.35	0.23	0.21	52					
1"	Gray IG	PEL-N-30-14523-00003	5	10	air	0.45	0.36	0.32	42					
	with grilles-between-the-glass	PEL-N-30-14524-00003				0.44	0.32	0.29	42					
	with integral grilles	PEL-N-30-14525-00003				0.44	0.32	0.29	42					
11/16"	Green Advanced Low-E IG	PEL-N-30-14526-00003	3	8	argon	0.45	0.30	0.26	42					
	with grilles-between-the-glass	PEL-N-30-14604-00004				0.35	0.24	0.36	52					
	with integral grilles	PEL-N-30-14605-00004				0.35	0.24	0.36	52					
1"	Green IG	PEL-N-30-14523-00004	5	10	air	0.45	0.38	0.50	42					
	with grilles-between-the-glass	PEL-N-30-14524-00004				0.44	0.35	0.46	42					
	with integral grilles	PEL-N-30-14525-00004				0.44	0.35	0.46	42					

R-Value = 1/U-Factor  
 SHGC = Solar Heat Gain Coefficient  
 VLT % = Visible Light Transmission  
 CR = Condensation Resistance  
 ER = Canadian Energy Rating

(1) Glazing performance values are calculated for Pine using NFRC 100, NFRC 200 and NFRC 500. Thermal performance of other wood species may vary. ENERGY STAR® values are updated to 2023 (Version 7) criteria.

(2) The values shown are based on Canada's updated ENERGY STAR® 2020 initiative.

See the Product Performance section for more detailed information or visit [www.energystar.gov](http://www.energystar.gov) for Energy Star guidelines.

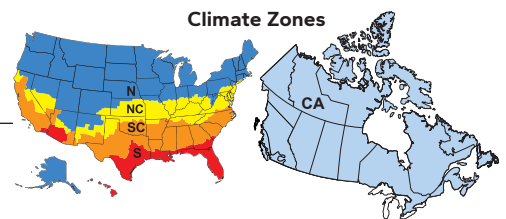



Combination Assemblies

Combinations are a great way to create visual interest in any project. A combination is an assembly formed by two or more separate windows or doors whose frames are mullioned together by a combination or reinforcing mullion. Refer to local restrictions and installation instructions when mulling units.

See the Combinations Section for requirements and limitations.

Contact your local Pella sales representative for more information.

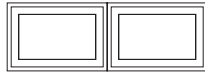

Two-Wide



Three-Wide

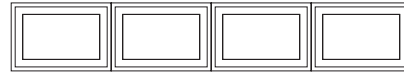

Four-Wide

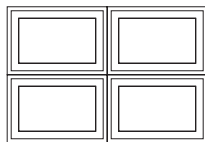

Two-Wide  
Two-High

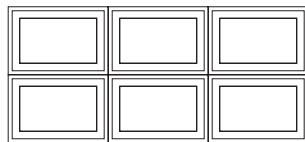

Three-Wide  
Two-High

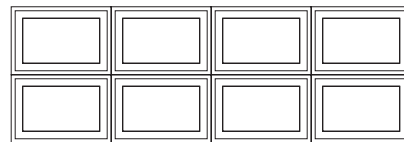

Four-Wide  
Two-High



Clad Frame over  
Single-Wide

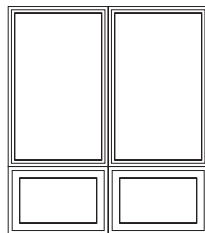

Two-Wide Clad Frame  
over Two-Wide

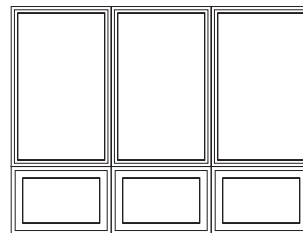

Three-Wide Clad Frame  
over Three-Wide

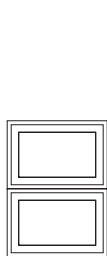

Two-High



Three-High

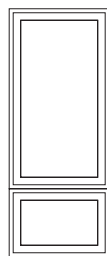

Casement over  
Single

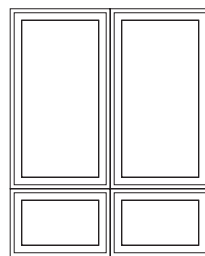

Two-Wide Casement over  
Two-Wide Awning

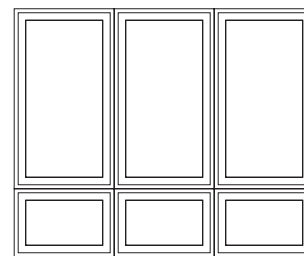

Three-Wide Casement over  
Three-Wide Awning

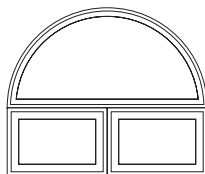

Half Circle over  
Two-Wide



# Pella® Reserve™ Impact-Resistant Awning Window

## Grille Profiles

### Traditional Style Collection - Integral Light Technology

### Contemporary Style Collection - Integral Light Technology®

Putty Glaze and Ogee Grilles  
Clad Exterior - Wood Interior

Square Grilles  
Clad Exterior - Wood Interior

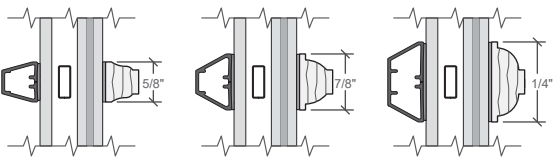
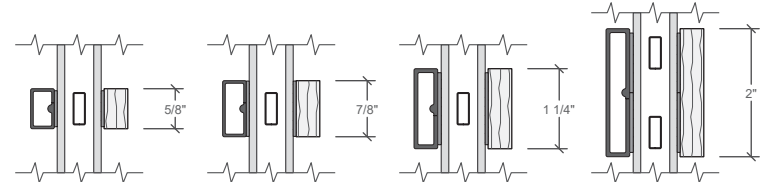
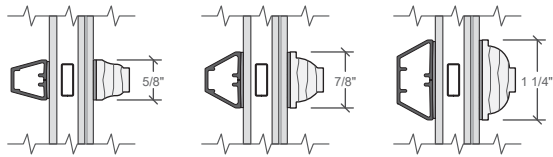

5/8" Regular      7/8" Regular      1 1/4" Regular

Ogee Grilles  
Clad Exterior - Wood Interior

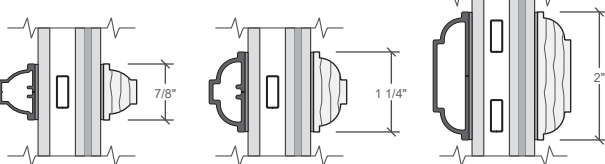
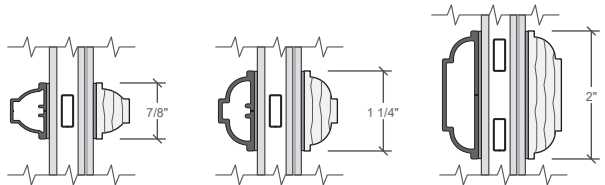

7/8" Regular      1 1/4" Regular      2" Regular

Grilles-Between-the-Glass

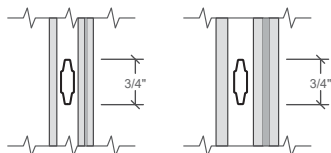

3/4" Contoured      3/4" Contoured

Interior wood ILT grilles available in Pine, Mahogany or Douglas Fir to match complete unit.



Grille Patterns

Integral Light Technology® Grille Patterns

Prairie Lite Patterns

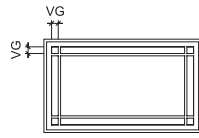

9-Lite

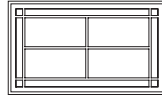

12-Lite

(Traditional Only)

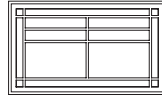

14-Lite

(Traditional Only)

Standard corner lite dimension for Prairie patterns = 2-1/2" VG.

9-Lite

- Available in all standard and special sizes.

12-Lite

- Available in units ≥ 1'9" and ≤ 2'11" in width, and ≥ 1'9" in height.

14-Lite

- Available in units ≥ 1'9" in width and ≥ 2'11" in height.

Other Available ILT Grille Patterns

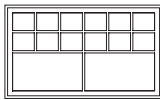

New England

(Traditional Only)

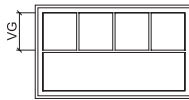

Top Row

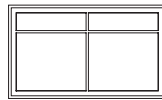

Cross

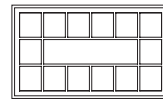

Victorian

(Traditional Only)

New England

- Standard visible glass to separator bar dimension = half of total visible glass height.

Top Row

- Standard visible glass to separator bar dimension = 14" or half of total visible glass height if frame height is < 2'11".

Cross

- Standard visible glass to separator bar dimension = one-quarter of total visible glass height.

Grilles-Between-the-Glass Patterns

Prairie Lite Patterns

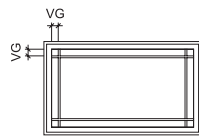

9-Lite Prairie

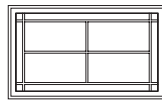

12-Lite Prairie

(Traditional Only)

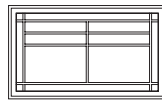

14-Lite Prairie

(Traditional Only)

Top Row

- Standard visible glass to separator bar = 14" for frame heights > 35".

- Standard visible glass to separator bar = 12" for 35" frame heights and optional for 41" frame height.

- Separator bar at 12" or 16" optional for frames heights > 41".

Other Available GBG Grille Patterns

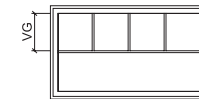

Top Row



Cross

Cross

- Available for units with frame heights ≥ 17".

- Standard visible glass to separator bar = 1/4 of total visible glass height.

For traditional patterns, see size tables.

VG = Visible Glass

Lite dimensions noted can vary.

Custom configurations are also available, for details contact your local Pella sales representative.



Size Tables

Vent Units

	(552) (533)	(603) (584)	(654) (635)	(756) (737)
Opening	1' 9 <sup>3</sup> / <sub>4</sub> "	1' 11 <sup>3</sup> / <sub>4</sub> "	2' 1 <sup>3</sup> / <sub>4</sub> "	2' 5 <sup>3</sup> / <sub>4</sub> "
Frame	1' 9"	1' 11"	2' 1"	2' 5"
2' 5 <sup>3</sup> / <sub>4</sub> "	(756) (737)	(654) (635)	(603) (584)	(552) (533)
2' 1 <sup>3</sup> / <sub>4</sub> "				
1' 11 <sup>3</sup> / <sub>4</sub> "				
1' 9 <sup>3</sup> / <sub>4</sub> "				

Vent Units

	(908) (889)	(908) (889)	(1 060) (1 041)	(1 213) (1 194)	(1 365) (1 346)	(1 518) (1 499)
Opening	2' 11 <sup>3</sup> / <sub>4</sub> "	3' 5 <sup>3</sup> / <sub>4</sub> "	3' 11 <sup>3</sup> / <sub>4</sub> "	4' 5 <sup>3</sup> / <sub>4</sub> "	4' 11 <sup>3</sup> / <sub>4</sub> "	
Frame	2' 11"	3' 5"	3' 11"	4' 5"	4' 11"	
2' 11 <sup>3</sup> / <sub>4</sub> "	(908) (889)	(908) (889)	(1 060) (1 041)	(1 213) (1 194)	(1 365) (1 346)	(1 518) (1 499)
2' 5 <sup>3</sup> / <sub>4</sub> "						
2' 1 <sup>3</sup> / <sub>4</sub> "						
1' 11 <sup>3</sup> / <sub>4</sub> "						
1' 9 <sup>3</sup> / <sub>4</sub> "						
1' 5"						

Special Size Frame Dimensions\*

	Minimum	Maximum
Vent	1'9" W x 1'5" H (533 x 432)	4'11" W x 2'11" H (1346 x 737)

\* Available within size range shown.

Keep frame dimensions to the nearest 1/4" increment. Frame height cannot exceed frame width on special size vent units.

Opening Dimensions

Clad exterior units: Dimensions shown in standard size tables are rough opening dimensions.

For clad and wood units with impact-resistant glass, see the product installation instructions or refer to local building code requirements.

Not to scale.

(1) Available within size range shown.

Traditional grille patterns shown. See Grille Types page for additional patterns and profiles.

Keep frame dimensions to the nearest 1/4" increment. Frame height cannot exceed frame width on special size vent units.

Contact your local Pella representative for the availability of custom sizes smaller or larger than the parameters shown or other custom fixed shapes.



Design Data

Vent Units

Unit	11/16" Insulated Glass PVB		
	Design Pressure	Florida Product Approval System	Hallmark Certified
2121v	75	10026.1	411-H-1339
2525v	75	10026.1	411-H-1339
2929v	75	10026.1	411-H-1339
3517	75	10026.1	411-H-1339
3521	75	10026.1	411-H-1339
3525	75	10026.1	411-H-1339
3529	75	10026.1	411-H-1339
3535	75	10026.1	411-H-1339
4117	75	10026.1	411-H-1339
4121	75	10026.1	411-H-1339
4125	75	10026.1	411-H-1339
4129	75	10026.1	411-H-1339
4717	75	10026.1	411-H-1339
4721	75	10026.1	411-H-1339
4725	75	10026.1	411-H-1339
4729	75	10026.1	411-H-1339
4735	75	10026.1	411-H-1339
5317	75	10026.1	411-H-1339
5321	75	10026.1	411-H-1339
5325	75	10026.1	411-H-1339
5329	75	10026.1	411-H-1339
5335	75	10026.1	411-H-1339
5917	75	10026.1	411-H-1339
5921	75	10026.1	411-H-1339
5925	75	10026.1	411-H-1339
5929	75	10026.1	411-H-1339
5935	75	10026.1	411-H-1339

Continued on next page

Miscellaneous Formulas

Vent area ft <sup>2</sup>	$(FW - 4.125) \times 5 \div 144$
---------------------------	----------------------------------

V = Vent Only  
 (-) = Not Applicable  
 All vent sizes and glass types are tested for air/water/structural and impact-resistance, and are certified for wind zone 4, large missile rating D. Florida Product Approval System number not needed if Miami-Dade County approved.  
 See Casement section for fixed unit performance data.





Design Data

Vent Units			
Unit	1" Insulated Glass SGP		
	Design Pressure	Florida Product Approval System	Hallmark Certified
2121v	+75 / -85	10026	411-H-1339
2525v	+75 / -85	10026	411-H-1339
2929v	+75 / -85	10026	411-H-1339
3517	+75 / -85	10026	411-H-1339
3521	+75 / -85	10026	411-H-1339
3525	+75 / -85	10026	411-H-1339
3529	+75 / -85	10026	411-H-1339
3535	+75 / -85	10026	411-H-1339
4117	+75 / -85	10026	411-H-1339
4121	+75 / -85	10026	411-H-1339
4125	+75 / -85	10026	411-H-1339
4129	+75 / -85	10026	411-H-1339
4717	+75 / -85	10026	411-H-1339
4721	+75 / -85	10026	411-H-1339
4725	+75 / -85	10026	411-H-1339
4729	+75 / -85	10026	411-H-1339
4735	+75 / -85	10026	411-H-1339
5317	+75 / -85	10026	411-H-1339
5321	+75 / -85	10026	411-H-1339
5325	+75 / -85	10026	411-H-1339
5329	+75 / -85	10026	411-H-1339
5335	+75 / -85	10026	411-H-1339
5917	75	10026	411-H-1339
5921	75	10026	411-H-1339
5925	75	10026	411-H-1339
5929	75	10026	411-H-1339
5935	75	10026	411-H-1339

V = Vent Only

(-) = Not Applicable

All vent sizes and glass types are tested for air/water/structural and impact-resistance, and are certified for wind zone 4, large missile rating D.

Florida Product Approval System number not needed if Miami-Dade County approved.

See Casement section for fixed unit performance data.



### Frame

- Select softwood, immersion treated with Pella's EnduraGuard® wood protection formula in accordance with WDMA I.S.-4. The EnduraGuard formula includes three active ingredients for protection against the effects of moisture, decay, stains from mold and mildew. Plus, an additional ingredient adds protection against termite damage.
- Interior exposed surfaces are [clear pine] [mahogany].
- Exterior surfaces are clad with aluminum.
- Components are assembled with screws, staples and concealed corner locks.
- Overall frame depth is 5" (127mm) for a wall depth of 3-11/16" (94mm).
- Optional factory-applied jamb extensions available between 3-13/16" (97mm) and 9-3/16" (233mm).
- Optional factory-installed fold-out installation fins with flexible fin corners.
- Optional factory-applied EnduraClad® exterior trim.

### Sash

- Select softwood, immersion treated with Pella's EnduraGuard wood protection formula in accordance with WDMA I.S.-4. The EnduraGuard formula includes three active ingredients for protection against the effects of moisture, decay, stains from mold and mildew. Plus, an additional ingredient adds protection against termite damage.
- Corners are mortised and tenoned, glued and secured with metal fasteners.
- Interior exposed surfaces are: [clear pine] [mahogany].
- Exterior surfaces are clad with extruded aluminum butt-jointed at all corners of the sash with through-stile construction and sealed.
- Sash thickness is [1-13/16" (46mm) for 11/16" [2-1/8" (54mm) for 1" glazing.
- Exterior sash profile is [ogee] [putty glaze], interior sash profile is ogee.

### Weatherstripping

- Dual weatherstripping.
  - Flexible santoprene material compressed between frame and sash for positive seal on all four sides.
  - Secondary thermoplastic vulcanizate (TPV) leaf-type weatherstrip between edge of sash and frame.

### Glazing System

- Quality float glass complying with ASTM C 1036.
- Impact-Resistant
  - Silicone-glazed 1" dual-seal impact-resistant insulating glass<sup>1</sup> [SGP]. [[tempered] [annealed]] exterior light is [[Advanced Low-E] [SunDefense] [clear] [bronze] [gray] [green]]. Laminated clear interior light.
    - or –
  - Silicone-glazed 11/16" dual-seal impact-resistant insulating glass<sup>1</sup> [PVB]. [[tempered] [annealed]] exterior light is [[Advanced Low-E] [SunDefense] [clear]]. Laminated [clear] interior light, or [[tempered] [annealed]] exterior light is [[multi-layer Low-E]]. Laminated [[bronze] [gray] [green]] interior light.

### Exterior

- Aluminum clad exteriors shall be finished with EnduraClad® protective finish, in a multi-step, baked-on finish.
  - Color is [Standard] [custom]<sub>2</sub>.
    - or –
- Aluminum clad exteriors shall be finished with EnduraClad Plus protective finish with 70% fluoropolymer resin in a multi-step, baked-on finish.
  - Color is [Standard] [custom]<sub>2</sub>.

### Interior

- [Unfinished, ready for site finishing] [factory primed with one coat acrylic latex] [factory prefinished [paint] [stain]<sub>2</sub>].

### Hardware

- Roto operator assembly
  - Steel worm gear sash operator with hardened gears.
  - Operator base is zinc die cast with painted finish.
  - Operator linkage is stainless steel.
  - Exposed fasteners are stainless steel.
  - Hardware will exceed 1,000 hours salt spray exposure per ASTM B 117.
  - Hinge slide and hinge arms are wash hinges.
- All vent units are available with operator located on the bottom center of the unit.
- SureLock® System—A single handle locking system operates positive-acting arms that reach out and pull the sash into a locked position; one operating lock installed on units with frame widths 29" and less, two unison operating locks installed on units with frame widths over 29".
- Style of hardware is [Standard integrated fold-away crank and standard lock handle with [baked enamel [Champagne] [White] [Brown] [Matte Black]] [bright brass] [satin nickel] [oil-rubbed bronze] hardware finish]
- [Antiek fold-away crank and Antiek lock handle with [baked enamel [Champagne] [White] [Brown] [Matte Black]] [Bright Brass] [Satin Nickel] [Oil-rubbed Bronze] [Antique Brass] [Distressed Bronze] [Distressed Nickel] hardware finish].

### Optional Products

#### Grilles

- Integral Light Technology® Grilles
  - Interior grilles are [5/8" [7/8" [1-1/4" [2" ogee profile that are solid [Pine] [mahogany]. Interior surfaces are [unfinished, ready for site finishing] [factory primed] [pine: factory prefinished [paint] [stain]<sub>2</sub>].
  - Exterior grilles are [5/8" putty glaze profile] [7/8" [putty glaze] [ogee] profile] [1-1/4" [putty glaze] [ogee] profile] [2" ogee profile] that are extruded aluminum.
  - Patterns are [Traditional] [Prairie] [Top Row] [Cross] [New England] [Victorian] [Simulated French (fixed units only)].
  - Insulating glass contains non-glare spacer between the panes of glass.
  - Grilles are adhered to both sides of the insulating glass with VHB acrylic adhesive tape and aligned with non-glare spacer.
    - or –
- Grilles-Between-the-Glass<sup>3</sup>
  - Insulating glass contains 3/4" contoured aluminum grilles permanently installed between two panes of glass (exterior air-space on triple-pane insulating glass).
  - Patterns are [Traditional] [Prairie] [Cross] [Top Row] [Custom – Equally Divided].
  - Interior color is [White] [Tan<sub>4</sub>] [Brown<sub>4</sub>] [Putty<sub>4</sub>] [Black] [Morning Sky Gray] [Ivory] [Sand Dune] [Harvest] [Cordovan] [Brickstone].
  - Exterior color<sub>5</sub> is [Standard<sub>2</sub>].

#### Screens

- InView™ Screens
  - Vinyl-coated 18/18 mesh fiberglass screen cloth complying with the performance requirements of SMA 1201, set in aluminum frame fitted to inside of window, supplied complete with all necessary hardware.
  - Screen frame finish is [baked enamel [Champagne] [Artisan Greige] [Skyline Gray] [White] [Brown] [Black]] [Wrapped in wood veneer, finished to match interior finish].

#### Hardware

- Optional factory applied limited opening hardware available for vent units in stainless steel; nominal 3" opening.

(1) Low-E coated insulating glass is argon-filled (except high altitude). All other insulating glass (including high altitude Low-E) is air-filled.

(2) Contact your local Pella sales representative for current designs and color options.

(3) Available in clear or Low-E insulating glass only.

(4) Tan, Brown or Putty Interior GBG colors are available in single-tone (Brown/Brown, Tan/Tan or Putty/Putty). Other interior colors are also available with tan or brown exterior.

(5) Appearance of exterior grille color will vary depending on Low-E coating on glass.



Frame

- Select softwood, immersion treated with Pella's EnduraGuard® wood protection formula in accordance with WDMA I.S.-4. The EnduraGuard formula includes three active ingredients for protection against the effects of moisture, decay and stains from mold and mildew. Plus, an additional ingredient adds protection against termite damage.
Interior exposed surfaces are [clear pine] [mahogany] [douglas fir].
Exterior surfaces are clad with aluminum.
Components are assembled with screws, staples and concealed corner locks.
Overall frame depth is 5" (127mm) for a wall depth of 3-11/16" (94mm).
Optional factory-applied jamb extensions available between 3-13/16" (97mm) and 9-3/16" (233mm).
Optional factory-installed fold-out installation fins with flexible fin corners.
Optional factory-applied EnduraClad® exterior trim.

Sash

- Select softwood, immersion treated with Pella's EnduraGuard wood protection formula in accordance with WDMA I.S.-4. The EnduraGuard formula includes three active ingredients for protection against the effects of moisture, decay and stains from mold and mildew. Plus, an additional ingredient adds protection against termite damage.
Corners are mortised and tenoned, glued and secured with metal fasteners.
Interior exposed surfaces are: [clear pine] [mahogany] [douglas fir]].
Exterior surfaces are clad with extruded aluminum butt-jointed at all corners of the sash with through-stile construction and sealed.
Sash thickness is [1-13/16" (46mm) for 11/16" [2-1/8" (54mm) for 1" glazing.

Weatherstripping

- Dual weatherstripping.
Continuous, flexible santoprene material in dual durometer design with welded corners, compressed between frame and sash for positive seal on all four sides.
Secondary thermoplastic vulcanizate (TPV) leaf-type weatherstrip between edge of sash and frame.

Glazing System 1

- Quality float glass complying with ASTM C 1036.
Impact-Resistant
Silicone-glazed 1" dual-seal impact-resistant insulating glass; SGP. [[tempered] [annealed]] exterior light is [[Advanced Low-E] [SunDefense] [clear] [bronze] [gray] [green]]. Laminated clear interior light.
- or -
Silicone-glazed 11/16" dual-seal impact-resistant insulating glass; [PVB]. [[tempered] [annealed]] exterior light is [[Advanced Low-E] [SunDefense] [clear]]. Laminated [clear] interior light, or [[tempered] [annealed]] exterior light is [[multi-layer Low-E]]. Laminated [[bronze] [gray] [green]] interior light.

Exterior

- Aluminum clad exteriors shall be finished with EnduraClad® protective finish, in a multi-step, baked-on finish.
Color is [Standard] [custom]2.
- or -
Aluminum clad exteriors shall be finished with EnduraClad Plus protective finish with 70% fluoropolymer resin in a multi-step, baked-on finish.
Color is [Standard] [custom]2.

Interior

- [Unfinished, ready for site finishing] [factory primed with one coat acrylic latex] [factory prefinished [paint] [stain]2].

Hardware

- Roto operator assembly
Steel worm gear sash operator with hardened gears.
Operator base is zinc die cast with painted finish.
Operator linkage is stainless steel.
Exposed fasteners are stainless steel.
Hardware will exceed 1,000 hours salt spray exposure per ASTM B 117.
Hinge slide and hinge arms Stainless steel.
All vent units are available with operator located on the [Awning: left or right side as viewed from the exterior] [Large Awning: bottom center of the unit].
SureLock® System—A single handle locking system operates positive-acting arms that reach out and pull the sash into a locked position: [Awning: one operating lock installed on units with frame widths 29" and less, two unison operating locks installed on units with frame widths over 29"] [Large Awning: one operating lock installed on units with frame heights 41" and less, two unison operating locks installed on units with frame height over 41"].
Hardware Style is Saldo. Hardware Finish is [baked enamel [champagne] [white] [brown] [matte black]] [bright brass] [satin nickel] [oil-rubbed bronze] [polished chrome] [polished nickel].

Optional Products

Grilles

- Integral Light Technology® grilles
Interior grilles are [5/8" [7/8" [1-1/4" [2" square profile that are solid [pine] [mahogany] [douglas fir]. Interior surfaces are [unfinished, ready for site finishing] [factory primed] [pine: factory prefinished [paint] [stain] 2].
Exterior grilles are [5/8" [7/8" [1-1/4" [2" square profile that are extruded aluminum.
Patterns are [Traditional] [Prairie] [Top Row] [Cross] [Custom - Equally Divided].
Insulating glass contains non-glare spacer between the panes of glass.
Grilles are adhered to both sides of the insulating glass with VHB acrylic adhesive tape and aligned with non-glare spacer.
- or -

- Grilles-Between-the-Glass 3
Insulating glass contains 3/4" contoured aluminum grilles permanently installed between two panes of glass.
Patterns are [Traditional] [Prairie] [Cross] [Top Row] [Custom - Equally Divided].
Interior color is Interior color is [White] [Tan 4] [Brown 4] [Putty 4] [Black] [Morning Sky Gray] [Ivory] [Sand Dune] [Harvest] [Cordovan] [Brickstone] 2.
Exterior color 5 is [Standard]2.

Screens

- InView™ screens
Vinyl-coated 18/18 mesh fiberglass screen cloth complying with the performance requirements of SMA 1201, set in aluminum frame fitted to inside of window, supplied complete with all necessary hardware.
Insect screen frame finish is baked enamel [Champagne] [Artisan Greige] [Skyline Gray] [White] [Brown] [Black].

Hardware

- Optional factory applied limited opening hardware available for vent units in stainless steel; nominal 3" opening.

Sensors

- Optional factory installed integrated security sensors available in vent units.

(1) Low-E coated insulating glass is argon-filled (except high altitude). All other insulating glass (including high altitude Low-E) is air-filled.

(2) Contact your local Pella sales representative for current designs and color options.

(3) Available in clear or Low-E insulating glass with argon, and obscure insulated glass.

(4) Tan, Brown or Putty Interior GBG colors are available in single-tone (Brown/Brown, Tan/Tan or Putty/Putty). Other interior colors are also available with tan or brown exterior.

(5) Appearance of exterior grille color will vary depending on Low-E coating on glass.



# Pella® Reserve™ Impact-Resistant Awning Window

Unit Sections - 1" Laminated Glass  
Pella® Reserve™ Traditional Large Awning

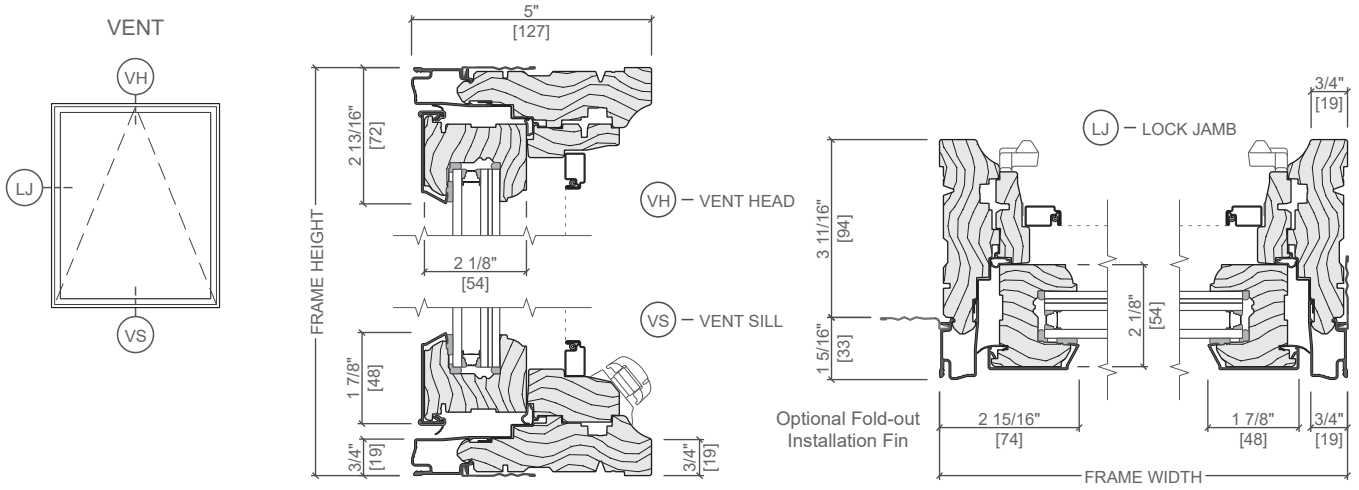

Scale 3" = 1' 0"  
All dimensions are approximate.



# Pella® Reserve™ Impact-Resistant Awning Window

## Unit Sections - 1" Laminated Glass Pella® Reserve™ Contemporary

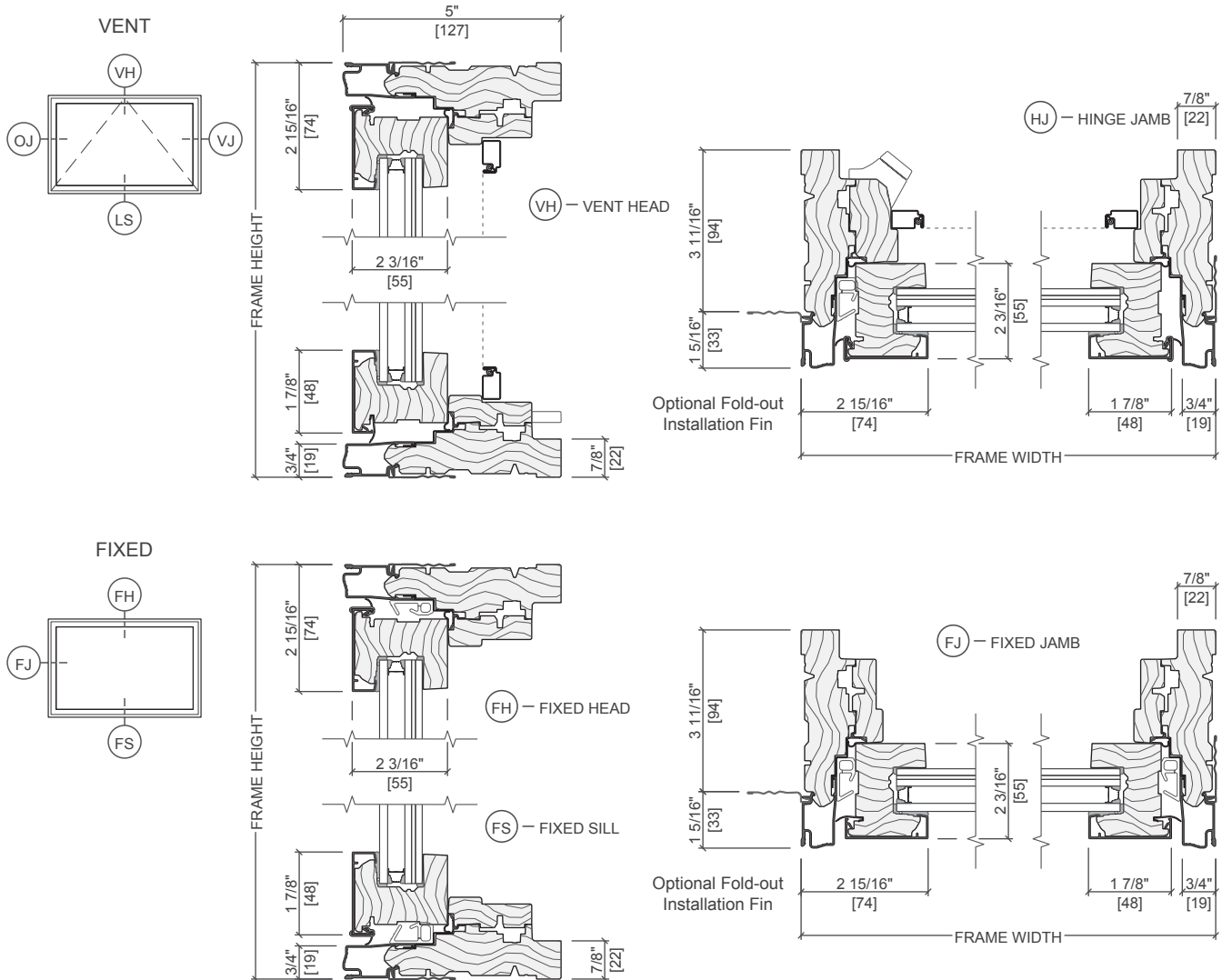

Scale 3" = 1' 0"

All dimensions are approximate.