



SLIDING DOOR INTERIOR AND EXTERIOR HANDLES INSTALLATION INSTRUCTION

TOOLS REQUIRED:

- #1 Phillips screwdriver
- #2 Phillips screwdriver
- #2 Phillips screwdriver with 8" shaft
- Hammer & Punch (Pella® ProLine Only)

HANDLE KIT CONTENTS:

- Thumbturn (except OXXO joining handle)
- Exterior handle
- Interior handle
- Interior handle insert
- #10 x 3" pan head screws (2)

(Key cylinder shown in illustration is sold separately)

- #6 x 1/2" flat head, pointed tip screw (1) (Champagne, White and Brown only)
- #6 x 3/8" flat head, flat tip screw (1) (Brass, Satin Nickel and Oil-Rubbed Bronze only)
- Spacer washer
- Gasket (2)

1 INSTALL THE HANDLES

Note: ProLine® exterior doors have a cylinder plug installed in the handle. This plug may be replaced with a keylock cylinder, if desired. If a keylock is not being installed on ProLine Sliding Door, go to Step 1C. Steps 1A thru 1K do not apply to the OX section of an OXXO door. To remove the ProLine cylinder plug; Tap the plug out using a hammer and a punch or nail set.

- A. **Remove the key from the key cylinder** (sold separately). Insert the cylinder into the round hole on the exterior handle making sure the key slot is visible through the hole in the front of the handle and the key shaft points away from the handle as shown.

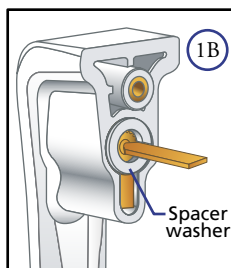
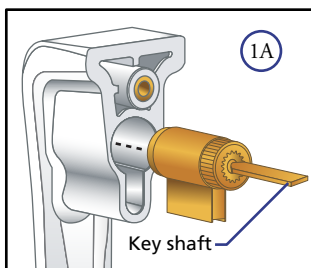

- B. **Install the spacer washer** over the key cylinder shaft as shown.

- C. **Install the thumbturn** on the interior of the door. With the thumbturn pointing toward the glass, insert the shaft into the second hole from the top of the lock stile.

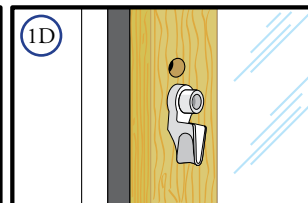
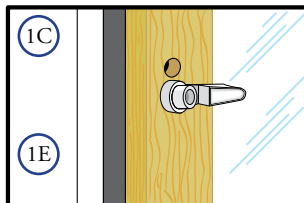

- D. **Test the operation of the thumbturn.** Close the door and rotate the thumbturn downward to the vertical position. The door should be locked.

Note: If the thumbturn cannot be rotated when the door is fully closed, the door roller height or the strike location may need to be adjusted. See Steps 2A - B and 2E for height adjustment instructions.
ProLine only: The thumbturn cannot be rotated to the locked position unless the door is fully closed.

- E. **Rotate the thumbturn to the unlocked position**, which is pointing toward the glass.

Note: Rotate the thumbturn clockwise if the glass is to the left, or counter-clockwise if the glass is to the right.

- F. **Rotate the key cylinder shaft** (if the exterior handle has a keylock) to the horizontal position.

- G. **Place an exterior handle gasket** on the bottom of the exterior handle.

Note: Remove the punchout from the gasket to allow the gasket to be placed over the handle locating post.

- H. **Place an exterior handle gasket** on the top of the exterior handle.

Note: The punchout of the upper gasket must align with the punchout of the lower gasket. If it does not align, remove the top gasket and flip it over.

- I. **Install the exterior handle** making sure that the key cylinder tail shaft engages the thumbturn shaft in the second hole from the top.

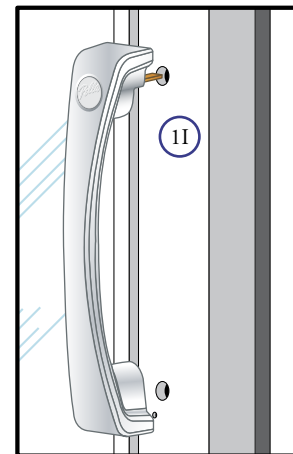
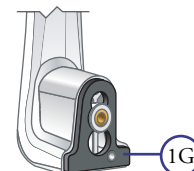
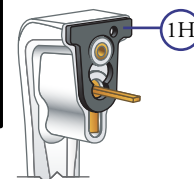
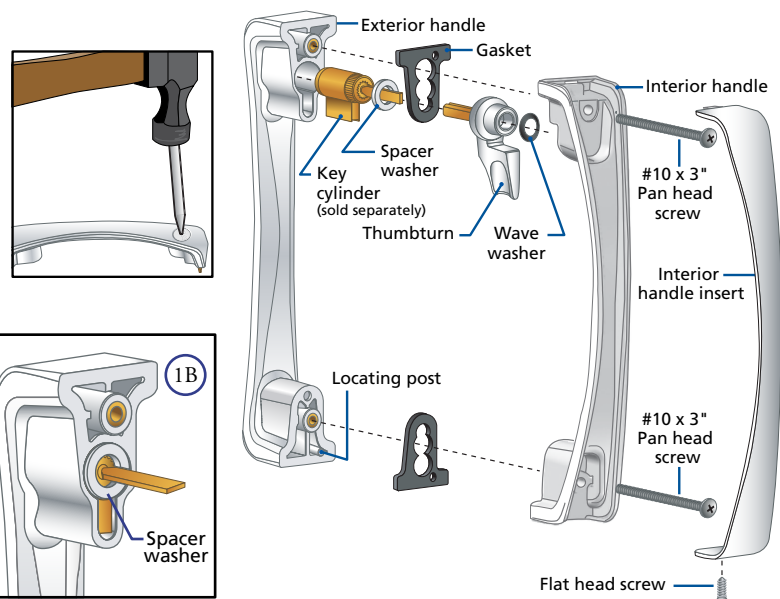

1 INSTALL THE HANDLES (continued)

- J. **Position the exterior handle on the door.** Insert the 1/8" locating post at the bottom of the handle into the 1/4" hole on the stile.

Note: If the post does not fit into the stile, the handle is for the wrong hand.

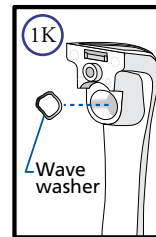

- K. **Insert the wave washer into the thumbturn hole** of the interior handle (except OXXO joining handle).

- L. **Position the interior handle over the thumbturn** (except OXXO joining handle). Insert the 1/8" locating post at the bottom of the handle into the 1/4" hole on the stile.

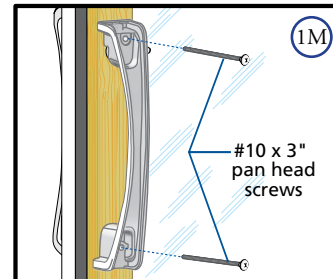
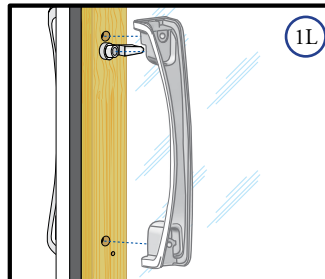

- M. **Using a screwdriver, install the two #10 x 3" pan head screws** through the interior handle into the threads in the exterior handle. Tighten each screw until both handles are secure.

Note: DO NOT over tighten the screws. DO NOT use a power drill.

- N. **Install the interior handle insert.** Place the tab at the top into the groove at the top of the handle. Press the insert into the center of the handle. Insert the flat head screw at the bottom of the insert to hold it in place. Use the #6 x 1/2" pointed tip screw for champagne, white, or brown interior handles. Use the #6 x 3/8" flat tip screw for brass, satin nickel or oil-rubbed bronze interior handles.

Note: Hold the insert tightly in place to align the parts while inserting the screw. DO NOT over tighten the screw. DO NOT use a power drill.

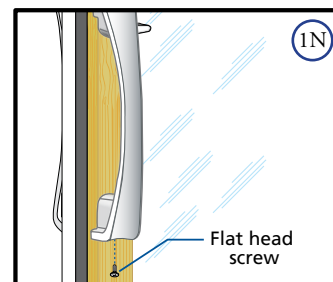
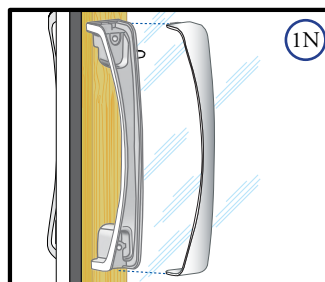

2 TEST THE OPERATION OF THE SLIDING DOOR

- A. **Open and close the door a few times** to check for proper operation. Make sure the door slides easily and latches.

Note: If there are any problems with the door travel, recheck and adjust for plumb and square. If the lock does not align with the strike, go to Step E, then return to Step B.

- B. **Adjust the height of the door rollers.** Remove the plastic caps from the adjusting holes located in the bottom movable panel. Use a 8" long #2 Phillips screwdriver to rotate the roller adjustment screw clockwise to raise, or counter-clockwise to lower that edge of the door. Slide the movable panel to within 1/2" of the lock jamb of the door frame, then check for equal reveal at the top and bottom of the door. If the reveal is not equal, adjust either roller to make reveal equal. Turn both adjustment screws clockwise until the top of the movable panel is within 1/32" of the top of the frame head channel.

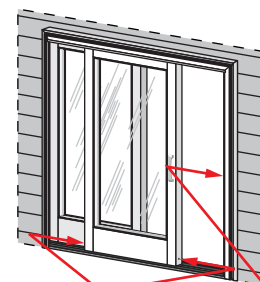
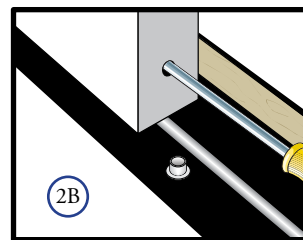

- C. **Test the lock system.**

Close the door panel and rotate the thumbturn to the vertical position. The door should be locked. Rotate the thumbturn to the horizontal position to unlock the door. If the lock does not align with the strike, go to Step E.

Note: Architect Series®, 850 Series and Designer Series® only: If the thumbturn is placed in the vertical

- D. **Test the operation of the key cylinder.**

- E. **If the lock strike needs to be adjusted,** remove the cover and loosen the screws behind it to allow the strike to be moved up or down. Slide the strike up or down as needed and tighten the screws. Replace the cover when finished.

