





INSTALLATION INSTRUCTION - INSTRUCCIONES DE INSTALACIÓN

INSTALLING ROTO COVER AND CRANK AND LOCK LEVER

INSTALACIÓN DE LA CUBIERTA Y LA MANIVELA Y LA PALANCA DE CERRADURA

TOOLS REQUIRED:

- Medium sized flat-blad screwdriver 
- Small flat-blad screwdriver 
- #1 Phillips screwdriver 

NOTE: If installing Roto Cover and Crank for the first time; Go to Step 2.

1 CRANK AND ROTO COVER REMOVAL

- Open the crank, loosen the set screw using a medium sized flat-blade screwdriver.
- Lift crank off operator stud to remove.

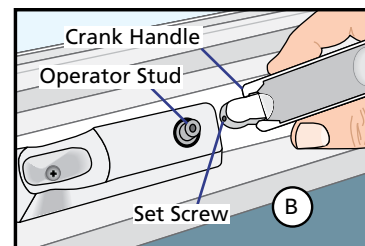
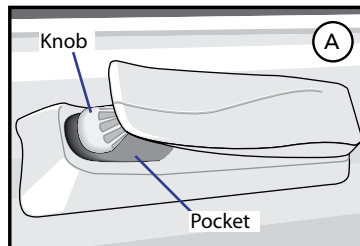

- If the cover has an attachment screw in the knob pocket; use a #1 Phillips screwdriver to remove the screw.

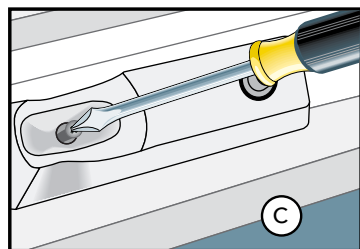

- Grasp the roto cover to remove.

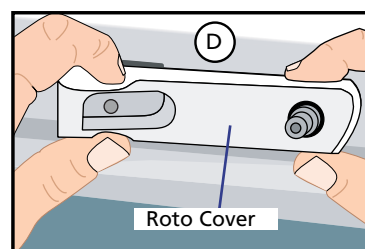

Note: If there was no screw in the knob pocket, a flat-blade screwdriver may be used to pry the pocket end of roto cover to remove.

2 INSTALLING ROTO COVER AND CRANK

Note: Finish the interior of the window and allow the window to dry before proceeding with these instructions. (To open the window for finishing, partially insert the lock handle into the jamb, unlock the unit, temporarily attach the crank handle and turn to open.)

- Place the cover over the operator stud and snap into place. Position the pocket end of the cover into place.

Note: If the cover does not have the screw hole, apply pressure on the pocket end of the cover to snap the cover into place and proceed to step C.

- Insert the provided screw into the hole in the bottom of the pocket. Use a # 1 Phillips screwdriver to secure the pocket screw snug against the bottom of the pocket to avoid scratching the crank handle knob. DO NOT over tighten.

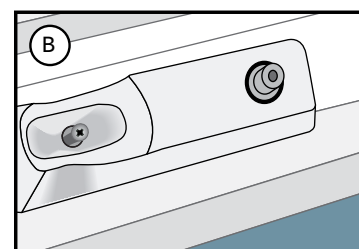
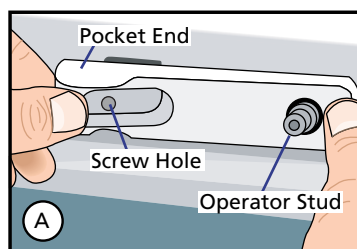

- Use a medium size flat-blade screwdriver to loosen the set screw in the crank handle.

- Slide the crank handle onto the stud. Unlock, open window, then close and lock window.

- Fold the crank handle down and check alignment of knob with the pocket.

Note: You may need to adjust the crank position on the stud until the correct alignment is achieved.

- Open the crank and tighten the set screw.

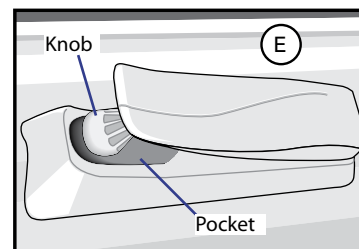
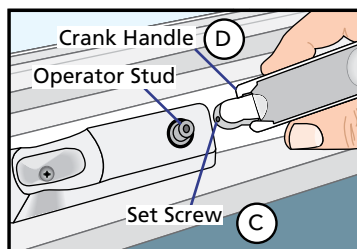

- After the final installation, fold the crank over and snap the knob into the pocket.

Note: Even with the window open the crank can be folded to avoid interfering with the window treatments.

3 LOCK LEVER REMOVAL AND INSERTION

Note: You may want to remove the lock lever prior to finishing the window, or if it needs to be replaced with a lock lever in a different finish.

- A. **Unlock and open the window.**
- B. **Place the lock lever in the locked position.**
- C. **From the exterior of the window,** insert a small flat-blade screwdriver between the cam and lock lever near the bottom of the opening between the stop and frame gasket.
- D. **Push the screwdriver inwards** with a small amount of pressure; then turn the blade slightly clockwise for a left hand unit, counter-clockwise for a right hand units. **DO NOT** over-twist the screwdriver, this can damage the lock driver.

Note: This will release the hook in the lever from the cam hook.

- E. **Remove the lock lever** by pulling it toward the interior of the building.
- F. **To install a lock lever,** hold it in the lock position and insert it, from the interior, into the slot until it snaps into the cam.

