





Pella® Entry Doors:

Fiberglass and Steel



Fiberglass

High performance. Low maintenance.

- Grained fiberglass has the warm, rich look of wood.
- Dent-resistant and won't rust or corrode.
- Choose from Mahogany-grain, Oak-grain, Fir-grain and Smooth fiberglass.

Steel

Naturally strong and durable.

- Steel panels provide a quality appearance to any home that's easy to maintain.
- Smooth surface creates even color when painted.
- Steel provides extra durability.

Single and Double Doors,

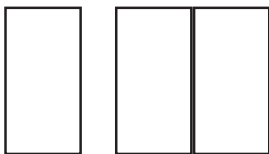

Single Door with Sidelights,

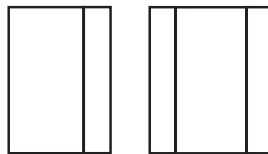

Single Door with Sidelights and Transom,

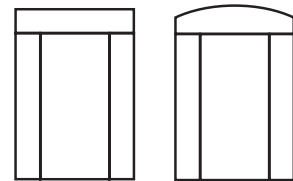

Double Door with Sidelights,

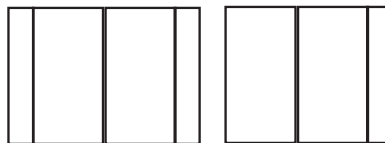

Pella® entry doors are backed by one of the best warranties in the business.*

Pella entry door fiberglass systems with composite exterior frames are backed by the Pella Limited Lifetime Warranty.*

The Pella 20/10 Limited Warranty is the standard warranty for all steel and wood entry doors from Pella.*

*See written limited warranties for complete details, including exceptions and limitations, at pella.com/warranty or contact Pella Customer Service.

(1) Configuration only available with fiberglass.

Brand Overview

Panel Options

Glass Panels: Fiberglass

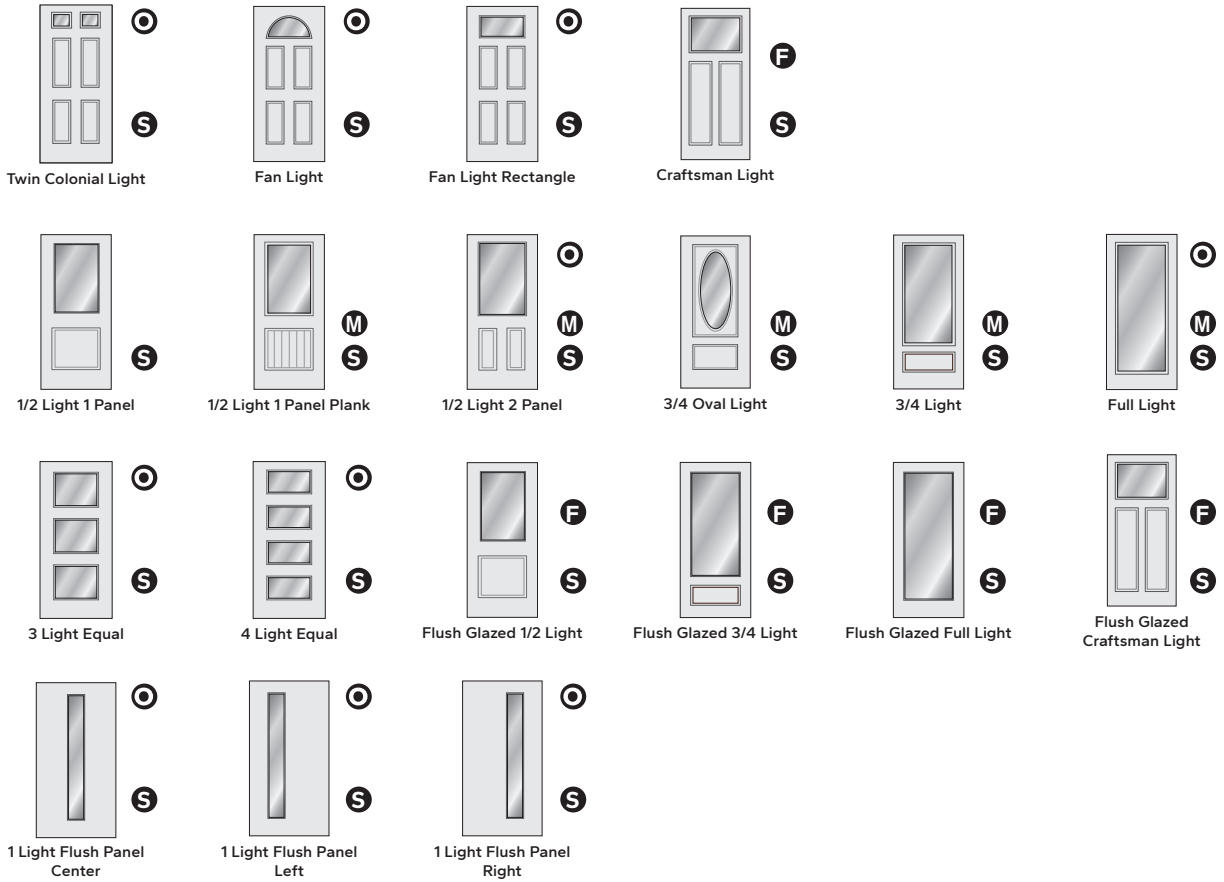

Sidelights: Fiberglass



Solid Panels: Fiberglass or Steel

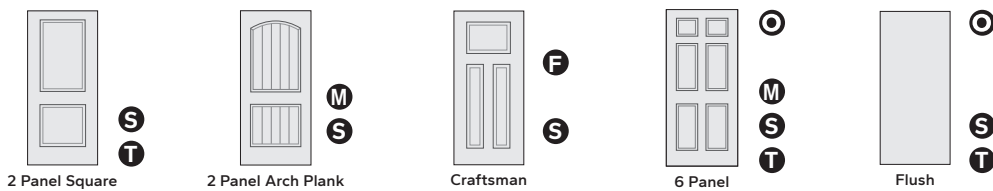

- O** Oak-Grain Fiberglass
- F** Fir-Grain Fiberglass
- M** Mahogany-Grain Fiberglass
- S** Smooth Fiberglass
- T** Steel

Glazing Options

Low-E Clear Glass



Textured and Obscure Glass



Chord | Textured



Double Water | Textured



Pear | Obscure

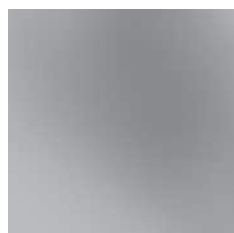

Satin Etch | Obscure

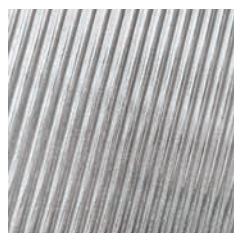

Narrow Reed | Textured

Glass Privacy Ratings

	Privacy Rating
Low-E	
Low-E Clear	1
Textured and Obscure	
Chord	9
Double Water	9
Pear	9
Satin Etch	9
Narrow Reed	7
Decorative Glass	
Avoca	8
Floris	8
Huxley	8
Story	8
Pel	7
Lucas	8
Tune	7
Danbury	9
Lovilia	9

Decorative Glass Collections

Traditional

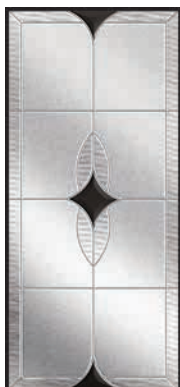

Avoca
Platinum Caming

Transitional



Huxley
Black Patina Caming

Craftsman



Lucas
Platinum Caming



Tune
Black Patina Caming

Contemporary (Wrought Iron between glass)



Danbury
Black Wrought Iron



Lovilia
Black Wrought Iron

Because of printing limitations, actual colors may vary slightly from those shown.

Indicates impact-resistant glazing available.

Brand Overview

Grille Profiles

For grille size and pattern availability contact your local Pella sales representative.

Simulated-Divided-Light Grilles

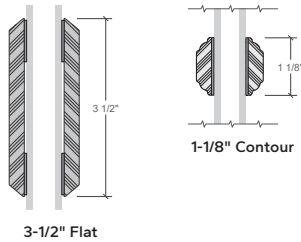

SDL grilles available for Flush Glazed panels only

Grilles-Between-the-Glass

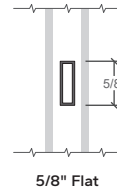

Fixed Grilles

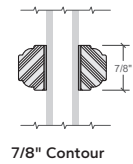

Grille Patterns

9-Light Prairie

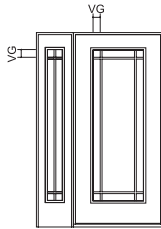

VG = Visible Glass
 Standard corner light dimension:
 GBG = 3-15/16" VG
 1-1/8" SDL = 2.930" VG

Traditional

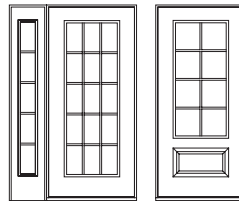

All doors will be 2 or 3 lights wide.

For size and pattern availability contact your local Pella sales representative.

Top Row

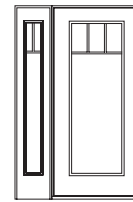

Simulated-Divided Light (1-1/8") (Flush Glazed Panels Only)

Traditional Pattern Lites	6' 8"		8' 0"	
	Lites Wide	Lites High	Lites Wide	Lites High
Door	Craftsman Light	2	2	2
	Flush Glazed 1/2 Light	2 or 3	2 or 3	—
	Flush Glazed 3/4 Light	2	2, 3 or 4	2, 3 or 4
	Flush Glazed Full Light	2	2, 4 or 5	2, 4 or 5
Sidelight	Craftsman Light	1	2	1
	Flush Glazed 3/4 Light	1	2, 3 or 4	2, 3 or 4
	Flush Glazed Full Light	1	3, 4 or 5	3, 4 or 5

Grilles-Between-the-Glass

Traditional Pattern Lites	6' 8"		8' 0"	
	Lites Wide	Lites High	Lites Wide	Lites High
Door	Craftsman Light	2 or 3	1 or 2	2 or 3
	Flush Glazed 1/2 Light	2 or 3	2 or 3	2 or 3
	Flush Glazed 3/4 Light	2	2, 3 or 4	2
	Flush Glazed Full Light	2 or 3	2, 4 or 5	2 or 3
Sidelight	Craftsman Light	1	2	1
	Flush Glazed 3/4 Light	1	2, 3 or 4	1
	Flush Glazed Full Light	1	2, 4 or 5	1

Blinds-Between-the-Glass

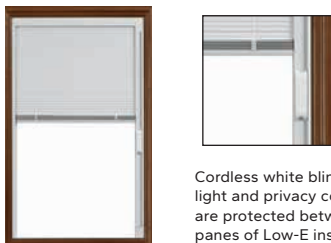

Cordless white blinds offer light and privacy control and are protected between two panes of Low-E insulating glass so they don't need cleaning.

Fixed

Traditional Pattern Lites	6' 8"		8' 0"	
	Lites Wide	Lites High	Lites Wide	Lites High
Door	Fan Light	5	—	5
	Craftsman Light	3	2 or 1	3
	1/2 Light	3	3	—
	Full Light	2 or 3	5	—
Sidelight	1/2 Light	1	3	—
	Full Light	1	5	—

Pella® Entry Doors Prefinished Fiberglass or Steel

All paints and stains are available on the exterior and interior of a panel or sidelight, as well as the frame.*

Fiberglass and Steel Factory Prefinish Paint



White



Pearl Gray



Wolf Gray



Fossil



Brown

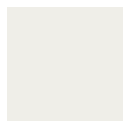

Classic White



Soft Linen



Almond



Putty



Portobello



Black



Brick Red



Spice Red



Sage



Pine Green



Frost Blue



Blue Ash

Fiberglass Factory Prefinish Stain



Golden Oak



Early American
Stain



Provincial
Stain



Dark Mahogany
Stain



Red Mahogany
Stain



Charcoal
Stain

*Frame finish is monotone.

NOTE: The rich, distinctive look of our factory-prefinished doors is achieved through hand-finishing. Some color variation is expected.

Because of printing limitations, actual colors may vary slightly from those shown.

Brand Overview

Handle Sets

Amador / Belleview



Napa / Del Mar₂



La Jolla / Seattle₂



Longview₂ / Elkhorn



Multi-point Lock Exterior Hardware₁

Eclipse



Grip

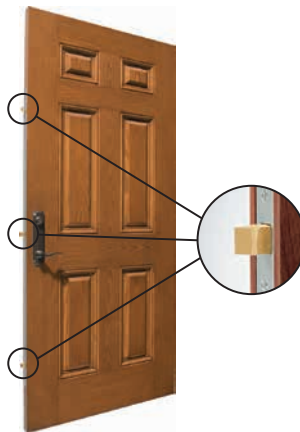

Multi-point Mechanism

Optional Deadbolts

Dual Cylinder Deadbolt



Keyed Interior and Exterior

Single Cylinder Deadbolt



Keyed Exterior

Hardware Finishes

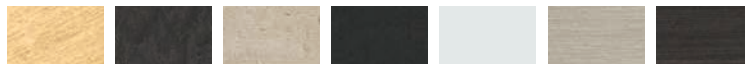

HARDWARE	Satin Brass ₃	Distressed Bronze	Distressed Nickel	Matte Black	Polished Chrome	Satin Nickel	Oil-Rubbed Bronze
Amador				•		•	
Belleview				•		•	
Napa / Del Mar	•			•		•	•
La Jolla / Seattle	•			•	•	•	
Longview / Elkhorn		•	•				
Eclipse / Grip						•	
Deadbolts				•		•	

Additional Decorative Accents

Dentil Shelf



(1) Not available on steel panels.

(2) Also available with Multipoint Lock

(3) Not available with Multipoint Lock..

In-Swing Doors - Fiberglass or Steel

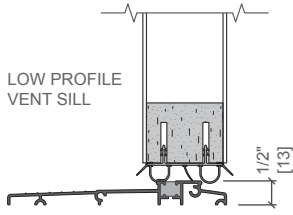

4 9/16" Frame

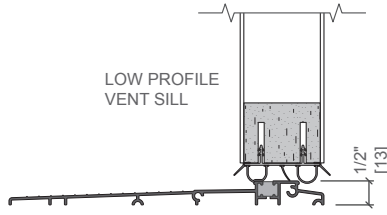

6 9/16" Frame

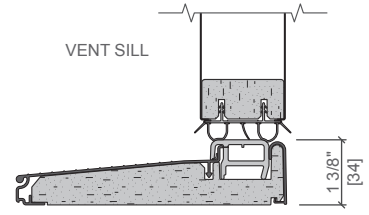

5-1/4" Frame Depth also available.

Out-Swing Doors - Fiberglass or Steel

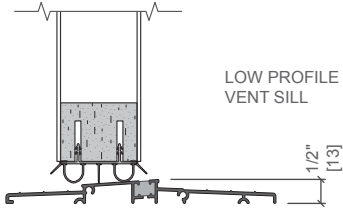

4 9/16" Frame

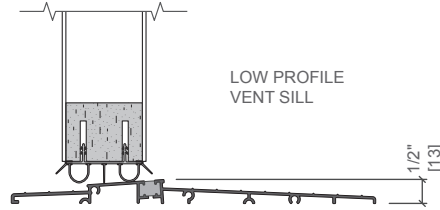

6 9/16" Frame

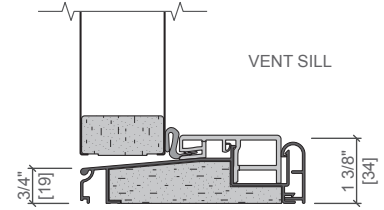

5-1/4" Frame Depth also available.



Sizes & Performance

Performance Summary	Door Type – Standard Sill (Single Unit)		Fiberglass / Steel	
			Standard	Impact
	In-Swing Door	Design Pressure	35 – 50	40 – 50
Out-Swing Door	Design Pressure	35 – 50	40 – 50	

Thermal Performance	Panel Category (Applicable to)	U-Factor	SHGC	VLT %	Energy Star® Capable
Fiberglass Panels (1" Insulating glass)	Full Light Flush Glazed Full Light 3/4 Light Flush Glazed 3/4 Light	0.25 - 0.36	0.12 - 0.30	0.18 - 0.31	N, NC, SC, S
	3/4 Light Flush Glazed 3/4 Light 3 Light Equal 1/2 Light 1 Panel 1/2 Light 1 Panel Plank 1/2 Light 2 Panel Flush Glazed 1/2 Light	0.22 - 0.31	0.09 - 0.23	0.16 - 0.24	N, NC, SC, S
	Flush Glazed 3/4 Light 3/4 Oval Light 4 Light Equal 1/2 Arch Light Plank 1/2 Light 1 Panel 1/2 Light 1 Panel Plank 1/2 Light 2 Panel Flush Glazed 1/2 Light	0.21 - 0.27	0.07 - 0.17	0.12 - 0.18	N, NC, SC, S
	Craftsman Light Fan Light Fan Light Camber Top Fan Light Rectangle Twin Colonial Light	0.19 - 0.22	0.07 - 0.10	0.07 - 0.10	N, NC, SC, S

Performance values do not include the performance of handles or glass seals. Published performance data is for single unit only.