



Features and Options .....MSPD-2

Glazing Performance..... MSPD-3

Grille Types..... MSPD-6

Design Data

    Size and Performance Data..... MSPD-8

Detailed Product Descriptions ..... MSPD-13

Unit Sections .....MSPD-14

**Document Navigation Tips:**

Items listed in the table of contents above are active links that will take you to the corresponding page.

The Pella logo on each page is a link back to this table of contents.

Bookmarks are also included in this PDF document and are available as an additional navigation option.

**Supporting documents for this product:**

Test Reports:

[https://media.pella.com/professional/adm/CertificationReports/Test\\_Reports\\_AS-Clad.pdf](https://media.pella.com/professional/adm/CertificationReports/Test_Reports_AS-Clad.pdf)

CSI Specs (readable using Microsoft Word or other text editing application):

[https://media.pella.com/professional/adm/Wood-CSI\\_Specs/083219.rtf](https://media.pella.com/professional/adm/Wood-CSI_Specs/083219.rtf)

AIA Masterspec (readable using Microsoft Word or other text editing application):

[https://media.pella.com/professional/adm/Wood-CSI\\_Specs/Masterspec/08550FL\\_finished.rtf](https://media.pella.com/professional/adm/Wood-CSI_Specs/Masterspec/08550FL_finished.rtf)

Detailed Product Description (readable using Microsoft Word or other text editing application):

<https://media.pella.com/professional/adm/Specialty/PR-MultiSlideDoor.rtf>

CAD cross sections (requires appropriate CAD software to read and use):

[https://media.pella.com/professional/adm/Specialty/AS-SenscpRes-Slide-Detail\\_D.dwg](https://media.pella.com/professional/adm/Specialty/AS-SenscpRes-Slide-Detail_D.dwg)

3D & BIM (requires appropriate software to read and use):

<https://media.pella.com/professional/adm/RevitFiles/PR-Revit/Door-Multi-Slide-Pella-Reserve-Traditional.zip>

The information published in this document is believed to be accurate at the time of publication. However, because we are constantly working to improve our products, specifications are subject to change without notice. Consult your local Pella representative for up-to-date product information.

Microsoft and Microsoft Word are registered trademarks of Microsoft Corp.



# Pella® Reserve™ Traditional - Multi-Slide Doors

## Features and Options

Standard	Options / Upgrades
<b>Glazing</b>	
<b>Glazing Type</b>	
Dual-Pane Insulating Glass	—
<b>Insulated Glass Options/Low-E Types</b>	
Advanced Low-E	SunDefense™ Low-E
	SunDefense+ Low-E
	AdvancedComfort Low-E
	NaturalSun Low-E
	NaturalSun+ Low-E
Clear (no Low-E coating)	
<b>Additional Glass Options</b>	
Tempered Glass	STC Glazing options, including Non-Impact Laminated Glass
	Obscure Glass <sub>1</sub>
	Tinted Glass (Bronze, Gray and Green)
<b>Gas Fill/High Altitude</b>	
Argon	High altitude (with air)
	High altitude with argon
<b>Exterior</b>	
EnduraClad® aluminum-clad	EnduraClad Plus aluminum-clad
<b>Cladding Colors<sub>1</sub></b>	
Standard colors	Feature Colors, Custom Colors
<b>Interior</b>	
Unfinished wood	Factory primed, Factory prefinished paint <sub>1,2</sub> , factory prefinished stain <sub>1</sub>
<b>Wood types</b>	
Pine	Mahogany, Douglas Fir <sub>3</sub>
<b>Hardware</b>	
<b>Flush Handle</b>	
White, Brown, Matte Black	Satin Nickel, Oil-Rubbed Bronze, Bright Brass, Polished Chrome
<b>Baldwin Sliding Patio Door Handle Styles</b> (Stacking configuration only, lead panel will not stack flush)	
	Matte Black, Satin Nickel, Oil-Rubbed Bronze, Satin Brass, Polished Nickel, Polished Chrome, Distressed Bronze, Distressed Nickel
<b>Grilles</b>	
<b>Integral Light Technology® Grilles</b>	
—	Traditional, Prairie, Top Row, Cross, New England, Victorian, Custom
<b>Grilles-Between-the-Glass</b>	
—	Traditional, Prairie, Top Row <sub>1</sub> , Cross, Custom-Equally Divided

### Sound Transmission Class / Outdoor-Indoor Transmission Class

Product	Frame Size Tested <sup>4</sup>	Glazing System				STC Rating	OITC Rating
		Overall Glazing Thickness	Exterior Glass Thickness	Interior Glass Thickness	Third Pane Thickness		
Clad Multi-Slide Door	Without Grilles						
	72" x 95 1/2" (XO)	13/16"	3mm	5mm	—	31	27

(1) Contact your local Pella sales representative for current designs and color options.

(2) Not available on Mahogany and Douglas Fir interiors.

(3) Douglas Fir on panels only, frame parts are pine.

(4) ASTM E 1425 defines standard sizes for acoustical testing. Ratings achieved at that size are representative of all sizes of the same configuration.



# Pella® Reserve™ Traditional - Multi-Slide Doors

## Glazing Performance - Total Unit

Glazing Thickness	Type of Glazing	NFRC Certified Product #	Glass (mm)		Gap Fill	Performance Values <sup>1</sup>				Shaded Areas Meet ENERGY STAR® Performance Criteria in Zones Shown				
			Ext.	Int.		U-Factor	SHGC	VLT %	CR	U. S.				Canada <sup>2</sup>
										Zone				ER
<b>Dual-Pane Glazing - 1-1/2" Weep Sill</b>										N	NC	SC	S	CA
13/16"	Clear IG	PEL-N-250-04169-00001	3	3	air	0.46	0.48	0.50	42					
	with grilles-between-the-glass	PEL-N-250-04170-00001				0.46	0.42	0.43	42					
	with integral grilles	PEL-N-250-04171-00001				0.47	0.42	0.43	42					
13/16"	Advanced Low-E IG	PEL-N-250-04293-00001	3	3	argon	0.33	0.23	0.43	54					
	with grilles-between-the-glass	PEL-N-250-04294-00001				0.33	0.20	0.37	54					
	with integral grilles	PEL-N-250-04295-00001				0.34	0.20	0.37	54					
13/16"	SunDefense™ Low-E IG	PEL-N-250-04197-00001	3	3	argon	0.33	0.18	0.40	55					
	with grilles-between-the-glass	PEL-N-250-04198-00001				0.33	0.15	0.34	55					
	with integral grilles	PEL-N-250-04199-00001				0.34	0.15	0.34	55					
13/16"	SunDefense+ Low-E IG	PEL-N-250-04245-00001	3	3	argon	0.30	0.17	0.39	45					
	with grilles-between-the-glass	PEL-N-250-04246-00001				0.30	0.15	0.33	45					
	with integral grilles	PEL-N-250-04247-00001				0.30	0.15	0.33	45					
13/16"	AdvancedComfort Low-E IG	PEL-N-250-04341-00001	3	3	argon	0.30	0.23	0.42	44					
	with grilles-between-the-glass	PEL-N-250-04342-00001				0.30	0.20	0.36	44					
	with integral grilles	PEL-N-250-04343-00001				0.31	0.20	0.36	44					
13/16"	NaturalSun Low-E IG	PEL-N-250-04389-00001	3	3	argon	0.34	0.43	0.48	54					
	with grilles-between-the-glass	PEL-N-250-04390-00001				0.34	0.37	0.41	54					
	with integral grilles	PEL-N-250-04391-00001				0.35	0.37	0.41	54					
13/16"	NaturalSun+ Low-E IG	PEL-N-250-04437-00001	3	3	argon	0.30	0.39	0.47	44					
	with grilles-between-the-glass	PEL-N-250-04438-00001				0.30	0.34	0.41	44					
	with integral grilles	PEL-N-250-04439-00001				0.31	0.34	0.41	44					
<b>Tinted Glazing</b>														
13/16"	Bronze Advanced Low-E IG	PEL-N-250-04301-00002	5	3	argon	0.33	0.21	0.28	55					
	with grilles-between-the-glass	PEL-N-250-04302-00002				0.33	0.18	0.24	55					
	with integral grilles	PEL-N-250-04303-00002				0.34	0.18	0.24	55					
13/16"	Gray Advanced Low-E IG	PEL-N-250-04301-00003	5	3	argon	0.33	0.19	0.24	55					
	with grilles-between-the-glass	PEL-N-250-04302-00003				0.33	0.17	0.20	55					
	with integral grilles	PEL-N-250-04303-00003				0.34	0.17	0.20	55					
13/16"	Green Advanced Low-E IG	PEL-N-250-04301-00004	5	3	argon	0.33	0.23	0.38	55					
	with grilles-between-the-glass	PEL-N-250-04302-00004				0.33	0.21	0.32	55					
	with integral grilles	PEL-N-250-04303-00004				0.34	0.21	0.32	55					
<b>High Altitude Glazing</b>														
13/16"	Advanced Low-E IG	PEL-N-250-04289-00001	3	3	air	0.36	0.24	0.43	52					
	with grilles-between-the-glass	PEL-N-250-04290-00001				0.36	0.21	0.37	52					
	with integral grilles	PEL-N-250-04291-00001				0.37	0.21	0.37	52					
13/16"	SunDefense Low-E IG	PEL-N-250-04193-00001	3	3	air	0.36	0.18	0.40	52					
	with grilles-between-the-glass	PEL-N-250-04194-00001				0.36	0.16	0.34	52					
	with integral grilles	PEL-N-250-04195-00001				0.36	0.16	0.34	52					
13/16"	SunDefense+ Low-E IG	PEL-N-250-04241-00001	3	3	air	0.31	0.17	0.39	42					
	with grilles-between-the-glass	PEL-N-250-04242-00001				0.31	0.15	0.33	42					
	with integral grilles	PEL-N-250-04243-00001				0.32	0.15	0.33	42					
13/16"	AdvancedComfort Low-E IG	PEL-N-250-04337-00001	3	3	air	0.32	0.23	0.42	41					
	with grilles-between-the-glass	PEL-N-250-04338-00001				0.32	0.20	0.36	41					
	with integral grilles	PEL-N-250-04339-00001				0.32	0.20	0.36	41					
13/16"	NaturalSun Low-E IG	PEL-N-250-04385-00001	3	3	air	0.37	0.43	0.48	51					
	with grilles-between-the-glass	PEL-N-250-04386-00001				0.37	0.37	0.41	51					
	with integral grilles	PEL-N-250-04387-00001				0.37	0.37	0.41	51					
13/16"	NaturalSun+ Low-E IG	PEL-N-250-04433-00001	3	3	air	0.32	0.39	0.47	41					
	with grilles-between-the-glass	PEL-N-250-04434-00001				0.32	0.34	0.41	41					
	with integral grilles	PEL-N-250-04435-00001				0.33	0.34	0.41	41					

R-Value = 1/U-Factor  
 SHGC = Solar Heat Gain Coefficient  
 VLT % = Visible Light Transmission  
 CR = Condensation Resistance  
 ER = Canadian Energy Rating

(1) Glazing performance values are calculated for Pine using NFRC 100, NFRC 200 and NFRC 500. Thermal performance of other wood species may vary. ENERGY STAR® values are updated to 2023 (Version 7) criteria.

(2) The values shown are based on Canada's updated ENERGY STAR® 2020 initiative.

Visit [www.energystar.gov](http://www.energystar.gov) for Energy Star guidelines.

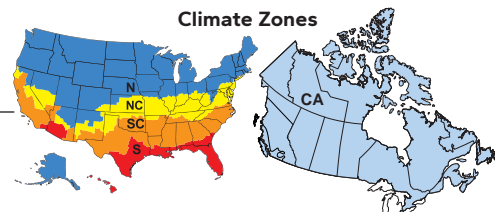



# Pella® Reserve™ Traditional - Multi-Slide Doors

## Glazing Performance - Total Unit

Glazing Thickness	Type of Glazing	NFRC Certified Product #	Glass (mm)		Gap Fill	Performance Values <sup>1</sup>				Shaded Areas Meet ENERGY STAR® Performance Criteria in Zones Shown					
			Ext.	Int.		U-Factor	SHGC	VLT %	CR	U. S.				Canada <sup>2</sup>	
										Zone				ER	Zone
<b>Dual-Pane Glazing - 1/2" Surface Mount Sill</b>											N	NC	SC	S	CA
13/16"	Clear IG	PEL-N-250-04873-00001	3	3	air	0.46	0.49	0.51	42						
	with grilles-between-the-glass	PEL-N-250-04874-00001				0.46	0.43	0.44	42						
	with integral grilles	PEL-N-250-04875-00001				0.47	0.43	0.44	42						
13/16"	Advanced Low-E IG	PEL-N-250-04997-00001	3	3	argon	0.33	0.24	0.43	54						
	with grilles-between-the-glass	PEL-N-250-04998-00001				0.33	0.21	0.37	54						
	with integral grilles	PEL-N-250-04999-00001				0.34	0.21	0.37	54						
13/16"	SunDefense™ Low-E IG	PEL-N-250-04901-00001	3	3	argon	0.33	0.18	0.40	55						
	with grilles-between-the-glass	PEL-N-250-04902-00001				0.33	0.16	0.34	55						
	with integral grilles	PEL-N-250-04903-00001				0.33	0.16	0.34	55						
13/16"	SunDefense+ Low-E IG	PEL-N-250-04949-00001	3	3	argon	0.29	0.17	0.39	45						
	with grilles-between-the-glass	PEL-N-250-04950-00001				0.29	0.15	0.34	45						
	with integral grilles	PEL-N-250-04951-00001				0.30	0.15	0.34	45						
13/16"	AdvancedComfort Low-E IG	PEL-N-250-05045-00001	3	3	argon	0.30	0.23	0.42	44						
	with grilles-between-the-glass	PEL-N-250-05046-00001				0.30	0.20	0.36	44						
	with integral grilles	PEL-N-250-05047-00001				0.30	0.20	0.36	44						
13/16"	NaturalSun Low-E IG	PEL-N-250-05093-00001	3	3	argon	0.34	0.43	0.49	54						
	with grilles-between-the-glass	PEL-N-250-05094-00001				0.34	0.38	0.42	54						
	with integral grilles	PEL-N-250-05095-00001				0.35	0.38	0.42	54						
13/16"	NaturalSun+ Low-E IG	PEL-N-250-05141-00001	3	3	argon	0.30	0.40	0.48	44						
	with grilles-between-the-glass	PEL-N-250-05142-00001				0.30	0.34	0.41	44						
	with integral grilles	PEL-N-250-05143-00001				0.31	0.34	0.41	44						
<b>Tinted Glazing</b>															
13/16"	Bronze Advanced Low-E IG	PEL-N-250-05005-00002	5	3	argon	0.33	0.21	0.28	55						
	with grilles-between-the-glass	PEL-N-250-05006-00002				0.33	0.19	0.24	55						
	with integral grilles	PEL-N-250-05007-00002				0.34	0.19	0.24	54						
13/16"	Gray Advanced Low-E IG	PEL-N-250-05005-00003	5	3	argon	0.33	0.19	0.24	55						
	with grilles-between-the-glass	PEL-N-250-05006-00003				0.33	0.17	0.21	55						
	with integral grilles	PEL-N-250-05007-00003				0.34	0.17	0.21	54						
13/16"	Green Advanced Low-E IG	PEL-N-250-05005-00004	5	3	argon	0.33	0.24	0.38	55						
	with grilles-between-the-glass	PEL-N-250-05006-00004				0.33	0.21	0.33	55						
	with integral grilles	PEL-N-250-05007-00004				0.34	0.21	0.33	54						
<b>High Altitude Glazing</b>															
13/16"	Advanced Low-E IG	PEL-N-250-04993-00001	3	3	air	0.36	0.24	0.43	52						
	with grilles-between-the-glass	PEL-N-250-04994-00001				0.36	0.21	0.37	52						
	with integral grilles	PEL-N-250-04995-00001				0.37	0.21	0.37	52						
13/16"	SunDefense Low-E IG	PEL-N-250-04897-00001	3	3	air	0.35	0.18	0.40	52						
	with grilles-between-the-glass	PEL-N-250-04898-00001				0.35	0.16	0.34	52						
	with integral grilles	PEL-N-250-04899-00001				0.36	0.16	0.34	52						
13/16"	SunDefense+ Low-E IG	PEL-N-250-04945-00001	3	3	air	0.31	0.18	0.39	42						
	with grilles-between-the-glass	PEL-N-250-04946-00001				0.31	0.16	0.34	42						
	with integral grilles	PEL-N-250-04947-00001				0.32	0.16	0.34	42						
13/16"	AdvancedComfort Low-E IG	PEL-N-250-05041-00001	3	3	air	0.31	0.23	0.42	41						
	with grilles-between-the-glass	PEL-N-250-05042-00001				0.31	0.20	0.36	41						
	with integral grilles	PEL-N-250-05043-00001				0.32	0.20	0.36	41						
13/16"	NaturalSun Low-E IG	PEL-N-250-05089-00001	3	3	air	0.36	0.43	0.49	51						
	with grilles-between-the-glass	PEL-N-250-05090-00001				0.36	0.38	0.42	51						
	with integral grilles	PEL-N-250-05091-00001				0.37	0.38	0.42	51						
13/16"	NaturalSun+ Low-E IG	PEL-N-250-05137-00001	3	3	air	0.32	0.39	0.48	41						
	with grilles-between-the-glass	PEL-N-250-05138-00001				0.32	0.34	0.41	41						
	with integral grilles	PEL-N-250-05139-00001				0.33	0.34	0.41	41						

R-Value = 1/U-Factor  
 SHGC = Solar Heat Gain Coefficient  
 VLT % = Visible Light Transmission  
 CR = Condensation Resistance  
 ER = Canadian Energy Rating

Climate Zones

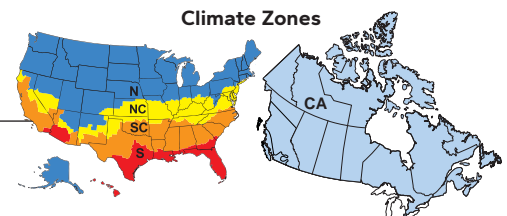

(1) Glazing performance values are calculated for Pine using NFRC 100, NFRC 200 and NFRC 500. Thermal performance of other wood species may vary. ENERGY STAR® values are updated to 2023 (Version 7) criteria.

(2) The values shown are based on Canada's updated ENERGY STAR® 2020 initiative.

Visit [www.energystar.gov](http://www.energystar.gov) for Energy Star guidelines.



# Pella® Reserve™ Traditional - Multi-Slide Doors

## Glazing Performance - Total Unit

Glazing Thickness	Type of Glazing	NFRC Certified Product #	Glass (mm)		Gap Fill	Performance Values <sup>1</sup>				Shaded Areas Meet ENERGY STAR® Performance Criteria in Zones Shown					
			Ext.	Int.		U-Factor	SHGC	VLT %	CR	U. S.				Canada <sup>2</sup>	
										Zone				ER	Zone
										N	NC	SC	S	CA	
<b>Dual-Pane Glazing - 1" Integrated Sill</b>															
13/16"	Clear IG	PEL-N-250-04521-00001	3	3	air	0.45	0.49	0.51	42						
	with grilles-between-the-glass	PEL-N-250-04522-00001				0.45	0.43	0.44	42						
	with integral grilles	PEL-N-250-04523-00001				0.45	0.43	0.44	42						
13/16"	Advanced Low-E IG	PEL-N-250-04645-00001	3	3	argon	0.31	0.24	0.43	54						
	with grilles-between-the-glass	PEL-N-250-04646-00001				0.31	0.21	0.37	54						
	with integral grilles	PEL-N-250-04647-00001				0.32	0.21	0.37	54						
13/16"	SunDefense™ Low-E IG	PEL-N-250-04549-00001	3	3	argon	0.31	0.18	0.40	55						
	with grilles-between-the-glass	PEL-N-250-04550-00001				0.31	0.16	0.35	55						
	with integral grilles	PEL-N-250-04551-00001				0.32	0.16	0.35	55						
13/16"	SunDefense+ Low-E IG	PEL-N-250-04597-00001	3	3	argon	0.28	0.17	0.39	45			SC	S		
	with grilles-between-the-glass	PEL-N-250-04598-00001				0.28	0.15	0.34	45			SC	S		
	with integral grilles	PEL-N-250-04599-00001				0.28	0.15	0.34	45						
13/16"	AdvancedComfort Low-E IG	PEL-N-250-04693-00001	3	3	argon	0.28	0.23	0.42	44						
	with grilles-between-the-glass	PEL-N-250-04694-00001				0.28	0.20	0.37	44			SC	S		
	with integral grilles	PEL-N-250-04695-00001				0.29	0.20	0.37	44						
13/16"	NaturalSun Low-E IG	PEL-N-250-04741-00001	3	3	argon	0.32	0.43	0.49	54						
	with grilles-between-the-glass	PEL-N-250-04742-00001				0.32	0.38	0.42	54						
	with integral grilles	PEL-N-250-04743-00001				0.33	0.38	0.42	54						
13/16"	NaturalSun+ Low-E IG	PEL-N-250-04789-00001	3	3	argon	0.28	0.40	0.48	44						
	with grilles-between-the-glass	PEL-N-250-04790-00001				0.28	0.35	0.41	44						
	with integral grilles	PEL-N-250-04791-00001				0.29	0.35	0.41	44						
<b>Tinted Glazing</b>															
13/16"	Bronze Advanced Low-E IG	PEL-N-250-04653-00002	5	3	argon	0.31	0.21	0.28	55						
	with grilles-between-the-glass	PEL-N-250-04654-00002				0.31	0.19	0.24	55						
	with integral grilles	PEL-N-250-04655-00002				0.32	0.19	0.24	55						
13/16"	Gray Advanced Low-E IG	PEL-N-250-04653-00003	5	3	argon	0.31	0.19	0.24	55						
	with grilles-between-the-glass	PEL-N-250-04654-00003				0.31	0.17	0.21	55						
	with integral grilles	PEL-N-250-04655-00003				0.32	0.17	0.21	55						
13/16"	Green Advanced Low-E IG	PEL-N-250-04653-00004	5	3	argon	0.31	0.24	0.38	55						
	with grilles-between-the-glass	PEL-N-250-04654-00004				0.31	0.21	0.33	55						
	with integral grilles	PEL-N-250-04655-00004				0.32	0.21	0.33	55						
<b>High Altitude Glazing</b>															
13/16"	Advanced Low-E IG	PEL-N-250-04641-00001	3	3	air	0.34	0.24	0.43	52						
	with grilles-between-the-glass	PEL-N-250-04642-00001				0.34	0.21	0.37	52						
	with integral grilles	PEL-N-250-04643-00001				0.35	0.21	0.37	52						
13/16"	SunDefense Low-E IG	PEL-N-250-04545-00001	3	3	air	0.34	0.18	0.40	52						
	with grilles-between-the-glass	PEL-N-250-04546-00001				0.34	0.16	0.35	52						
	with integral grilles	PEL-N-250-04547-00001				0.35	0.16	0.35	52						
13/16"	SunDefense+ Low-E IG	PEL-N-250-04593-00001	3	3	air	0.29	0.18	0.39	42						
	with grilles-between-the-glass	PEL-N-250-04594-00001				0.29	0.15	0.34	42						
	with integral grilles	PEL-N-250-04595-00001				0.30	0.15	0.34	42						
13/16"	AdvancedComfort Low-E IG	PEL-N-250-04689-00001	3	3	air	0.30	0.23	0.42	41						
	with grilles-between-the-glass	PEL-N-250-04690-00001				0.30	0.20	0.37	41						
	with integral grilles	PEL-N-250-04691-00001				0.31	0.20	0.37	41						
13/16"	NaturalSun Low-E IG	PEL-N-250-04737-00001	3	3	air	0.35	0.43	0.49	51						
	with grilles-between-the-glass	PEL-N-250-04738-00001				0.35	0.38	0.42	51						
	with integral grilles	PEL-N-250-04739-00001				0.35	0.38	0.42	51						
13/16"	NaturalSun+ Low-E IG	PEL-N-250-04785-00001	3	3	air	0.30	0.39	0.48	41						
	with grilles-between-the-glass	PEL-N-250-04786-00001				0.30	0.34	0.41	41						
	with integral grilles	PEL-N-250-04787-00001				0.31	0.34	0.41	41						

R-Value = 1/U-Factor  
 SHGC = Solar Heat Gain Coefficient  
 VLT % = Visible Light Transmission  
 CR = Condensation Resistance  
 ER = Canadian Energy Rating

(1) Glazing performance values are calculated for Pine using NFRC 100, NFRC 200 and NFRC 500. Thermal performance of other wood species may vary. ENERGY STAR® values are updated to 2023 (Version 7) criteria.

(2) The values shown are based on Canada's updated ENERGY STAR® 2020 initiative.

Visit [www.energystar.gov](http://www.energystar.gov) for Energy Star guidelines.

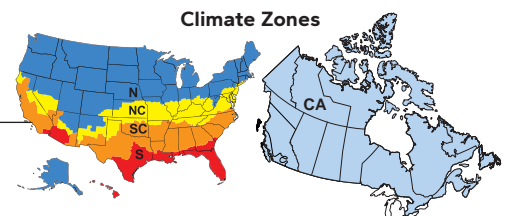



Grille Profiles

Traditional Style Collection - Integral Light Technology®

Putty Glaze and Ogee Grilles  
Clad Exterior - Wood Interior

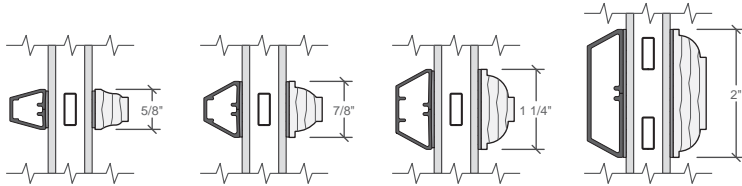

Ogee Grilles  
Clad Exterior - Wood Interior

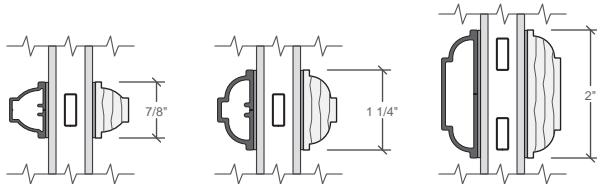

Grilles-Between-the-Glass

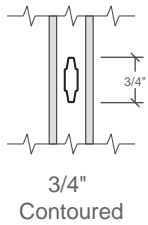

Interior wood ILT grilles available in Pine, Mahogany or Douglas Fir to match complete unit.



Grille Patterns

Integral Light Technology® Grilles

PRAIRIE LITE PATTERNS

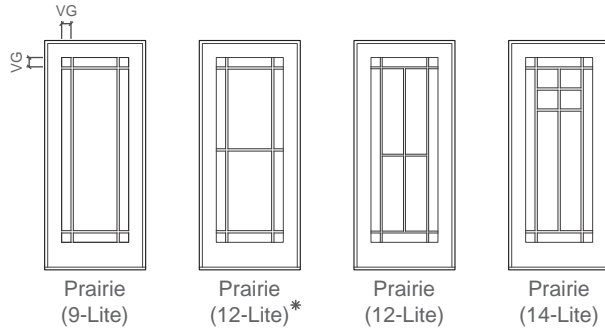

Standard corner lite dimension for Prairie patterns = 3-1/2" VG.

Integral Light Technology Grilles

- 9-Lite available in all special sizes.
- 12-Lite available in all special sizes; other heights available per custom drawing.
- 14-Lite available in panels > 23-3/4" width.

OTHER AVAILABLE PATTERNS

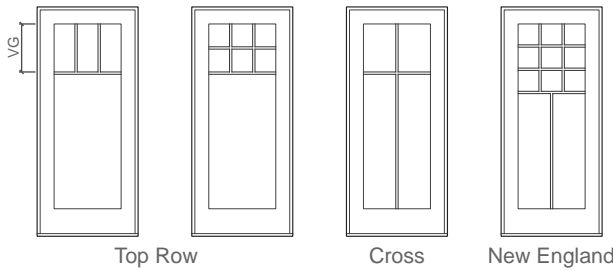

Top Row

- Standard visible glass to separator bar = 14" or half of total visible glass height, whichever is smaller.

Cross

- Standard visible glass to separator bar = one-quarter of total visible glass height.

New England

- Standard visible glass to separator bar = half of total visible glass height.

Grilles-Between-the-Glass

PRAIRIE LITE PATTERNS

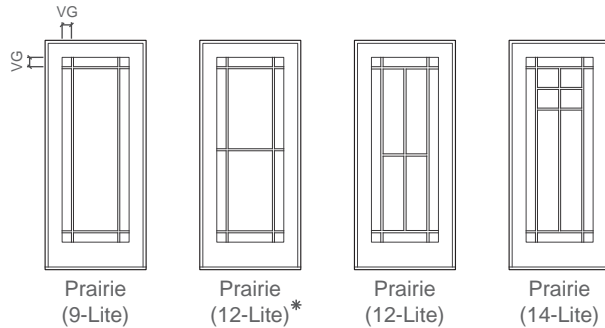

Prairie

- Standard corner lite dimension = 3-1/2" VG.
- 9-Lite available in units < 7' 0-3/4" height.
- \* Prairie in heights > 7' 0-1/2" will have 12 lites.
- 12-Lite available in units ≤ 7' 2" height.

OTHER AVAILABLE PATTERNS

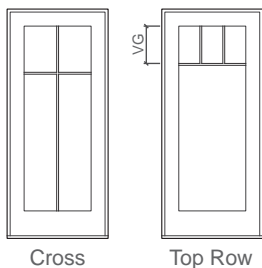

Cross

- Horizontal bar is 1/4 of visible glass from the top in door panels.

Top Row

- Horizontal bar may be ordered 12", 14" or 16" from the top VG.
- Transoms with frame heights ≥ 21", the horizontal bar will be positioned at 1/2 the visible glass height.

VG = Visible Glass

Lite dimensions noted can vary.

Custom configurations are available; for details contact your local Pella sales representative.



# Pella® Reserve™ Traditional - Multi-Slide Doors

## Design Data - Stacking Panels

Hardware Handle Height	Dimension from bottom of panel to center of lock thumbturn	Frame Height	
		Minimum	Maximum
Typical	40.843"	79.5"	119.5"
Greater Than 54"	54.843"		
'Window' usage	10.843"	50.5"	83.875"

### Panel Size Chart

Min Panel Size		Max Panel Size	
Width	Height	Width	Height
20"	77" - 82"	60"	117.04"
24"	82.1" - 96"		
28.788"	96.1" - 117.04"		

STACKING PANEL CONFIGURATION	Venting	Frame & Track Depth	Frame Width	Maximum Size				Hardware	Performance Class and Grade	
				Frame Width	Frame Height	Panel Width	Panel Height		1-1/2" Weep Sill	1" Integrated Sill & 1/2" Surface Mount Sill
	One-way	5.92 2 tracks	40.375	120.25	96	60	92.665	All	Pending	NC
			40.375	98.5	119.5	49.12	116.165		LC-PG25	NC
			98.625	120.25	119.5	60	116.165		NC	NC
	One-way	8.67 3 tracks	56.5	176.25	96	60	92.665	All	Pending	NC
			56.5	143.625	119.5	49.12	116.165		LC-PG25	NC
			143.75	176.25	119.5	60	116.165		NC	NC
	One-way	11.42 4 tracks	72.375	232.25	96	60	92.665	All	Pending	NC
			72.375	188.825	119.5	49.12	116.165		LC-PG25	NC
			189	232.25	119.5	60	116.165		NC	NC
	Bi-part	5.92 2 tracks	78.25	238.125	96	60	92.665	All	Pending	NC
			78.25	160.625	119.5	40.62	116.165	Flush	R-PG15	NC
			78.25	160.625	119.5	40.62	116.165	Baldwin	R-PG20	NC
160.75	238.125	119.5	60	116.165	All	NC	NC			
	One-way	14.17 5 tracks	88.5	288.375	96	60	92.665	All	Pending	NC
			88.5	233.825	119.5	49.12	116.165		LC-PG25	NC
			234	288.375	119.5	60	116.165		NC	NC

X = Venting, O = Fixed. All dimensions are in inches.

Those noted as NC are not AAMA/WDMA performance certified.

Custom sized units in 1/8" increments.

Doors are viewed from the exterior.



Contact your local Pella sales representative for more information.



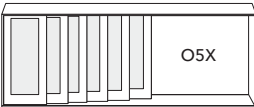
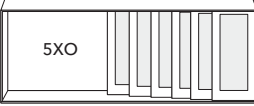
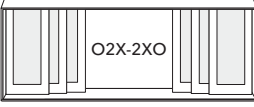

# Pella® Reserve™ Traditional - Multi-Slide Doors

## Design Data - Stacking Panels

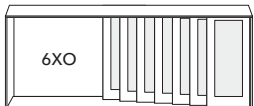
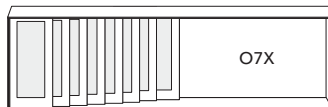
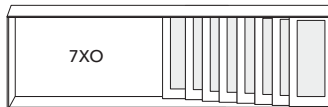
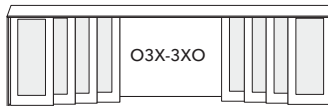
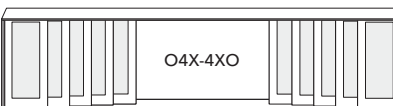
STACKING PANEL CONFIGURATION	Venting	Frame & Track Depth	Minimum	Maximum Size				Hardware	Performance Class and Grade	
			Frame Width	Frame Width	Frame Height	Panel Width	Panel Height		1-1/2" Weep Sill	1" Integrated Sill & 1/2" Surface Mount Sill
<b>6-Panel</b>  O5X  5XO  O2X-2XO	One-way	16.92 6 tracks	104.5	344.375	96	60	92.665		Pending	NC
			104.5	240	119.5	42.5987	116.165	All	LC-PG25	NC
			240.125	344.375	119.5	60	116.165		NC	NC
	Bi-part	8.67 3 tracks	110.375	350.25	96	60	92.665	All	Pending	NC
			110.375	228.125	119.5	40.62	116.165	Flush	R-PG15	NC
			110.375	228.125	119.5	40.62	116.165	Baldwin	R-PG20	NC
			228.25	350.25	119.5	60	116.165	All	NC	NC
<b>7-Panel</b>  O6X  6XO	One-way	19.67 7 tracks	120.5	400.375	119.5	60	116.165	All	NC	NC
<b>8-Panel</b>  O7X  7XO  O3X-3XO	One-way	22.42 8 tracks	136.5	456.375	119.5	60	116.165	All	NC	NC
	Bi-part	11.42 4 tracks	142.375	356.25	96	60	92.665	All	Pending	NC
			142.375	240	119.5	32.2094	116.165	Flush	R-PG15	NC
			142.375	240	119.5	32.2094	116.165	Baldwin	R-PG20	NC
		240.125	462.25	119.5	60	116.165	All	NC	NC	
<b>10-Panel</b>  O4X-4XO	Bi-part	14.17 5 tracks	174.5	356.25	96	60.62	92.665	All	Pending	NC
			174.5	240	119.5	26.5612	116.165	Flush	R-PG15	NC
			174.5	240	119.5	40.62	116.165	Baldwin	R-PG20	NC
			240.125	574.375	119.5	60	116.165	All	NC	NC

X = Venting, O = Fixed. All dimensions are in inches.  
 Those noted as NC are not AAMA/WDMA performance certified.  
 Custom sized units in 1/8" increments.  
 Doors are viewed from the exterior.  
 Contact your local Pella sales representative for more information.



# Pella® Reserve™ Traditional - Multi-Slide Doors

## Design Data - Pocketing Panels

POCKETING PANEL CONFIGURATION		Venting	Frame & Track Depth	Minimum	Maximum size (inches)				Hardware	Performance Class and Grade	
				Frame Width	Frame Width	Frame Height	Panel Width	Panel Height		1-1/2" Weep Sill	1/2" Surface Mount Sill
1-Panel		One-way	5.92 2 tracks	48.875	128.75	119.5	60	116.165	All	LC-PG30	NC
2-Panel		One-way	5.92 2 tracks	64	183.875	96	60	92.665	All	Pending	NC
				64	183.875	119.5	60	116.165		NC	NC
		Bi-part		95.25	255.125	96	60	92.665	All	Pending	NC
				95.25	255.125	119.5	60	116.165		NC	NC
3-Panel		One-way	8.67 3 tracks	80	239.875	96	60	92.665	All	Pending	NC
				80	239.875	119.5	60	116.165		NC	NC
4-Panel		One-way	11.42 4 tracks	96	295.875	96	60	92.665	All	Pending	NC
				96	295.875	119.5	60	116.165		NC	NC
		Bi-part		125.5	356.25	96	60	92.665	All	Pending	NC
				125.5	365.375	119.5	60	116.165		NC	NC
5-Panel		One-way	14.17	112.125	352	96	60	92.665	All	Pending	NC
				112.125	352	119.5	60	116.165		NC	NC

X = Venting, O = Fixed. All dimensions are in inches.

Those noted as NC are not AAMA/WDMA performance certified.

Custom sized units in 1/8" increments.

Doors are viewed from the exterior.

Contact your local Pella sales representative for more information.



# Pella® Reserve™ Traditional - Multi-Slide Doors

## Design Data - Pocketing Panels

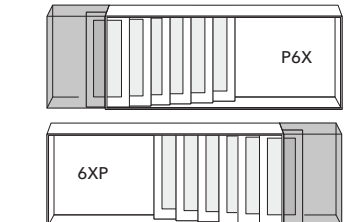
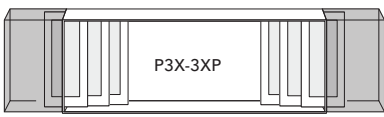
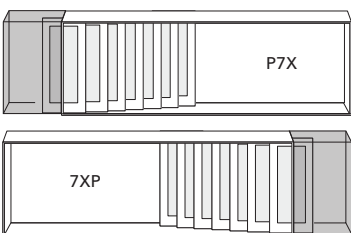
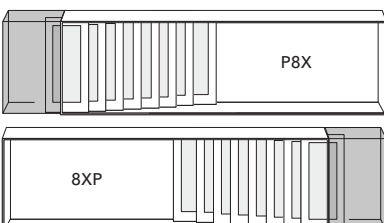
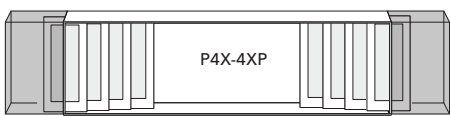
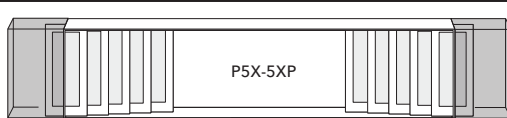
POCKETING PANEL CONFIGURATION		Venting	Frame & Track Depth	Minimum Frame Width	Maximum size (inches)				Hardware	Performance Class and Grade	
					Frame Width	Frame Height	Panel Width	Panel Height		1-1/2" Weep Sill	1/2" Surface Mount Sill
6-Panel		One-way	16.92 6 tracks	128.125	408	96	60	92.665	All	Pending	NC
				128.125	408	119.5	60	116.165		NC	NC
		Bi-part	8.67 3 tracks	157.625	356.25	96	60	92.665	All	Pending	NC
				157.625	477.5	119.5	60	116.165		NC	NC
7-Panel		One-way	19.67 7 tracks	120.5	400.375	119.5	60	116.165	All	NC	NC
8-Panel		One-way	22.42 8 tracks	136.5	456.375	119.5	60	116.165	All	NC	NC
		Bi-part	11.42 4 tracks	142.375	356.25	96	60	92.665	All	Pending	NC
				142.375	462.25	119.5	60	116.165		NC	NC
10-Panel		Bi-part	14.17 5 tracks	174.5	356.25	96	60	92.665	All	Pending	NC
				174.5	574.375	119.5	60	116.165		NC	NC

X = Venting, O = Fixed. All dimensions are in inches.

Those noted as NC are not AAMA/WDMA performance certified.

Custom sized units in 1/8" increments.

Doors are viewed from the exterior.

Contact your local Pella sales representative for more information.



# Pella® Reserve™ Traditional - Multi-Slide Doors

## Sizes and Configurations - Panels

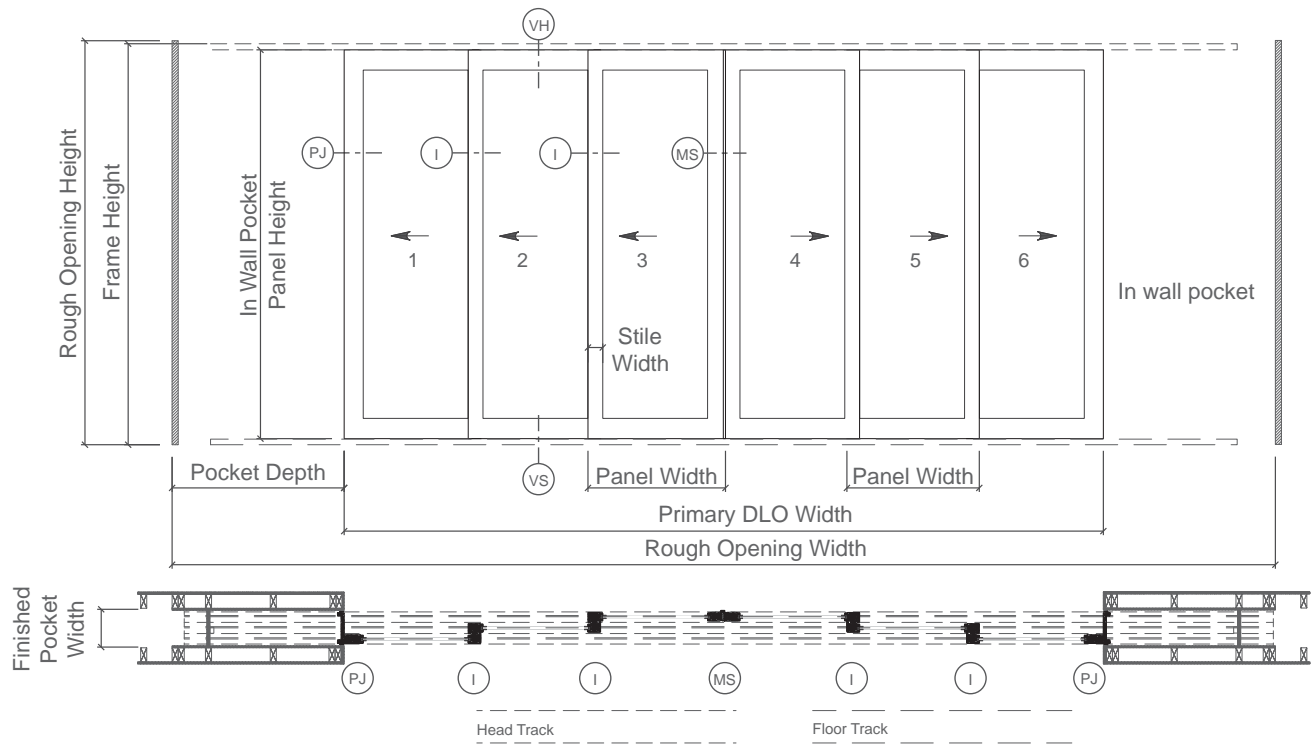

	Stacking: One Way (minimum 2 Panels)	Stacking: Bi-Parting	1 Pocket: One Way	2 Pocket: Bi-Parting
Frame Width	Starting Reference		Starting Reference	
Rough Opening Width	FW+1		FW+1	
Panel Width	$(FW + (TP-1) \times (PO - 2 \times 2.1280)) \div TP$	$(FW + (TP - 2) \times (PO - 2 \times 2.1280 - 1.8800)) \div TP$	$(FW + (TP - 1) \times (PO - 2.1280 - PPWD - 2.5770)) \div (TP + 1)$	$(FW + (TP - 2) \times (PO - 1.8800 - 2 \times PPWD - 2 \times 2.5770)) \div (TP + 2)$
Pocket to Panel Width Difference	n/a		4.052 (1 Panel) 3.1955 (2-8 Panel)	4.052 (2 Panel) 3.1955 (4-10 Panel)
Frame Pocket Depth	n/a		PW+ PPWD	PW + PPWD
Rough Opening Pocket Depth	n/a		FPD + 0.500	
DLO Width	FW + 1		ROW - RO Pocket Depth	ROW - RO Pocket Depth x 2
Frame Height	Starting Reference		Starting Reference	
Rough Opening Height/ DLO Height	FH + 0.5 for Frame Widths ≤ 120"; FH + 1.0 for Frame Widths > 120"		FH + 0.5 for Frame Widths ≤ 120"; FH + 1.0 for Frame Widths > 120"	
Panel Height - Surface Mount Sill	FH - 2.460		FH - 2.460	
Panel Height - Integrated Sill*	FH - 2.960		FH - 2.960	
Panel Height - Weep Sill	FH - 3.335		FH - 3.335	
Finished Pocket Width	n/a		OTD + 0.830	OTD + 0.830
Overall Track Depth (Frame Depth)	# Tracks x 2.75 + 0.42	# Tracks x 2.75 + 0.42	# Tracks x 2.75 + 0.42	# Tracks x 2.75 + 0.42

\* with finished floor installed correctly between the sill tracks

### Key

FW= Frame Width	ROW= Rough Opening Width	VGW=Visible Glass Width	MLGW=Movable Lite Glass Width
FH= Frame Height	DLO=Daylight Opening Width	VGH=Visible Glass Height	MLGH=Movable Lite Glass Height
TP= Total # of panels	OTD = Overall Track Depth	AGW=Actual Glass Width	PO = Panel Overlap
PW= Panel Width	PPWD = Pocket to Panel Width Difference	AGH=Actual Glass Height	FPD = Frame Pocket Depth
PH=Panel Height			



Detailed Product Description

**Frame**

- Select softwood and softwood plywood, immersion treated with Pella's EnduraGuard® wood protection formula in accordance with WDMA I.S.-4. The EnduraGuard formula includes three active ingredients for protection against the effects of moisture, decay, stains from mold and mildew. Plus, an additional ingredient adds protection against termite damage.
- Interior exposed surfaces are [pine] [mahogany] edge banded and veneered.
- Exterior surfaces are clad with aluminum at the head and jambs.
- Head and jamb components are assembled with screws and staples.
- Extruded aluminum sill tracks and sill track covers are bonded to a stainless steel sill pan with 3M VHB tape. Stainless steel track caps on which the rollers glide.
- Sill Finish is [painted solar reflective black] [painted "clear" morning sky gray].
- Frame Depth varies from 5.92" to 22.42" depending on configuration. See Overall Track Depth for dimension.
- 1-1/2" Weep Sill and Surface Mount Sill tracks run continuous length of frame width. Ramps run length of Daylight opening only (not in the pocket).  
– or –
- Integrated Sill is [Continuous length of frame] [Staggered under the panel travel] for field-installed finished flooring between sill tracks.

**Door Panels**

- Select softwood, immersion treated with Pella's EnduraGuard® wood protection formula in accordance with WDMA I.S.-4. The EnduraGuard formula includes three active ingredients for protection against the effects of moisture, decay, stains from mold and mildew. Plus, an additional ingredient adds protection against termite damage.
- Interior exposed surfaces are veneered with [Pine] [Mahogany] [Douglas Fir] .
- Exterior surfaces are clad with aluminum.
- Panel styles are LVL core with finger-jointed edge bands on both sides and veneered on both faces. Panel rails are three-ply construction, randomly finger-jointed blocks laminated with water-resistant glue and veneered on both sides.
- Corners are secured with metal fasteners and structural adhesive.
- Panel exterior profile is [ogee] [putty] and interior profile is ogee.
- Vent panels have two adjustable ABEC 5 sealed electroplated steel ball-bearing rollers with organic coating, set on stainless steel track, standard.  
– or –
- Two adjustable corrosion-resistant stainless steel ball-bearing rollers; out of-unit option.

**Weatherstripping**

- Mohair at heads on interior and exterior of panel.
- Dual Durometer extruded polymer leaf weatherstrip and mohair rain screen at jambs.
- Dual Durometer extruded polymer bulb at bottom of panels on interior and exterior.
- Mohairs at panel interlockers.

**Glazing System 1**

- Quality fully-tempered float glass complying with ASTM C 1048.
- Custom and high altitude glazing available.
- Silicone-glazed dual-pane 13/16" dual-seal insulating glass, [[clear] [[Advanced] [SunDefense™] [SunDefense+] [NaturalSun] [NaturalSun+] [AdvancedComfort] Low-E [with argon]] [[bronze] [gray] [green] Advanced Low-E [with Argon]] [obscure] [Reflective Bronze]  
– or –
- Silicone-glazed dual-pane 13/16" dual-seal non-impact laminated glass [clear] [[Advanced Low-E] [SunDefense Low-E] with Argon]] [[bronze] [gray] [green] Advanced Low-E [with argon]].

**Exterior**

- Aluminum-clad panel exteriors shall be finished with EnduraClad® protective finish on panels, in a multi-step, baked-on finish.
  - Color is [Standard] [feature] [Custom] 2.
 – or –
- Aluminum-clad panel exteriors shall be finished with EnduraClad Plus protective finish with 70% fluoropolymer resin on panels, in a multi-step, baked-on finish.
  - Color is [Standard] [feature] [Custom] 2.

**Interior**

- [Unfinished, ready for site finishing] [factory primed with one coat acrylic latex] [factory prefinished [paint] [stain] 2].

**Hardware**

- Standard flush handle style with SmartKey Security™ Re-key technology is brass. Hardware finish is [baked enamel [White] [Brown] [Matte Black]] [Satin Brass PVD] [Satin Nickel PVD] [Polished Chrome] [Oil Rubbed Bronze (Non-living)].
- Optional Baldwin® sliding patio door hardware styles with SmartKey Security™ Re-key technology. Hardware finish varies by style in [Matte Black] [Satin Brass] [Satin Nickel] [Oil Rubbed Bronze] [Distressed Bronze] [Distressed Nickel] [Polished Chrome] [Polished Nickel].
- Multiple point lock hardware is electroplated steel with stainless steel strikes. Located on lead vent panel and fixed panel. Wood plug on fixed panel hides access to fixed panel locking hardware.
- Stacking door with dual vent option allows traditional 'fixed' panel to vent one panel width in the opposite direction, with matching hardware set on dual vent panel.
- Biparting doors have an active handle set and inactive handle set in middle panels.
- Hardware handle lock lever location from bottom of the panel to center of lock thumb turn is [Typical 40.843"] [54.843"]

**Optional Products**

**Grilles**

- Integral Light Technology® Grilles
  - Interior grilles are [5/8"] [7/8"] [1-1/4"] [2"] ogee profile that are solid [Pine] [mahogany] [douglas fir]. Interior surfaces are [unfinished, ready for site finishing] [factory primed] [pine: factory prefinished [paint] [stain] 2].
  - Exterior grilles are [5/8" putty profile] [7/8" [putty] [ogee] profile] [1-1/4" [putty] [ogee] profile] [2" ogee profile] that are extruded aluminum.
  - Patterns are [Traditional] [Prairie] [Top Row] [Cross] [New England] [Victorian].
  - Insulating glass contains non-glare spacer between the panes of glass.
  - Grilles are adhered to both sides of the insulating glass with VHB acrylic adhesive tape and aligned with the non-glare spacer.  
– or –
- Grilles-Between-the-Glass 3
  - Insulating glass contains 3/4" contoured aluminum grilles permanently installed between two panes of glass.
  - Patterns are [Traditional] [Prairie] [Cross] [Top Row]
  - Interior color is [White] [Black] [Tan 4] [Brown] [Putty 4] [Ivory] [Brickstone] [Harvest] [Cordovan].
  - Exterior color 5 is [Standard] 2.

**Sensors**

- Optional factory installed integrated security sensors available in vent units.

(1) Insulating glass with argon is Low-E coated. All other insulating glass is air-filled.

(2) Contact your local Pella sales representative for current color options.

(3) Available in clear, Low-E and obscure insulating glass.

(4) Tan or Putty Interior GBG colors are available in single-tone (Tan/Tan or Putty/Putty). Other interior colors are also available with Tan or Brown exterior.

(5) Appearance of exterior grille color will vary depending on Low-E coating on glass.



# Pella® Reserve™ Traditional - Multi-Slide Doors

## Unit Sections

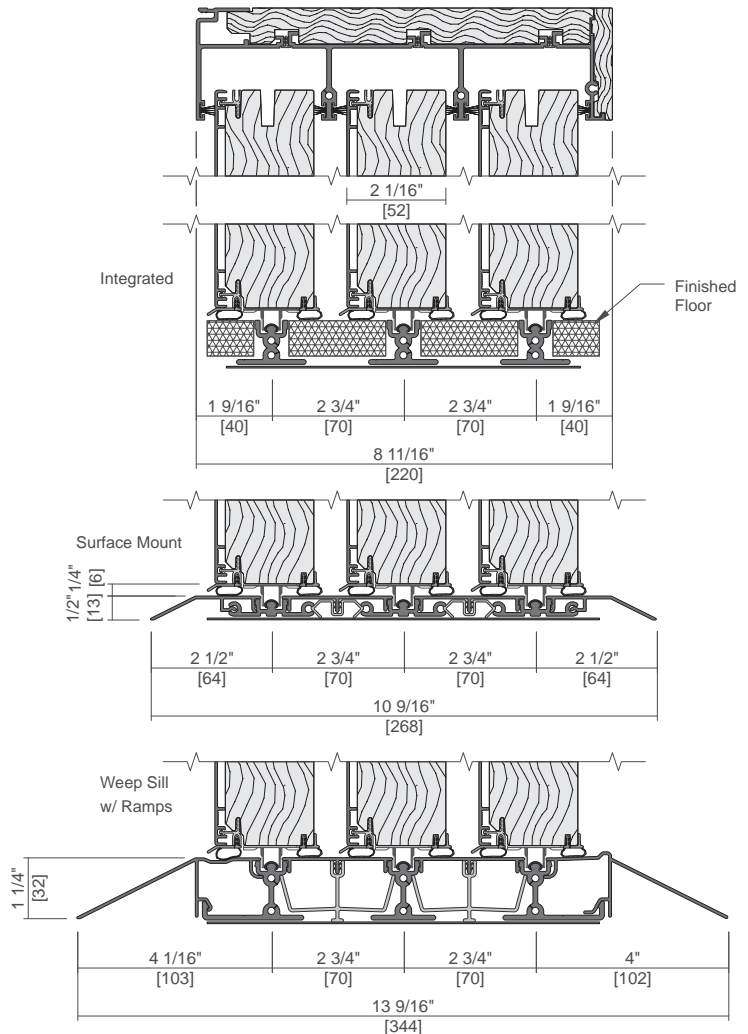
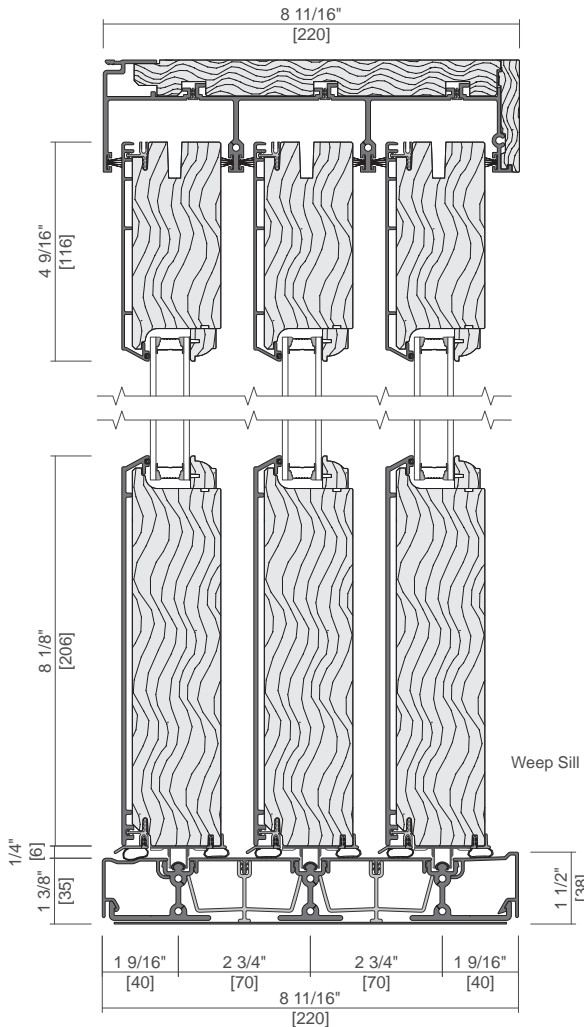
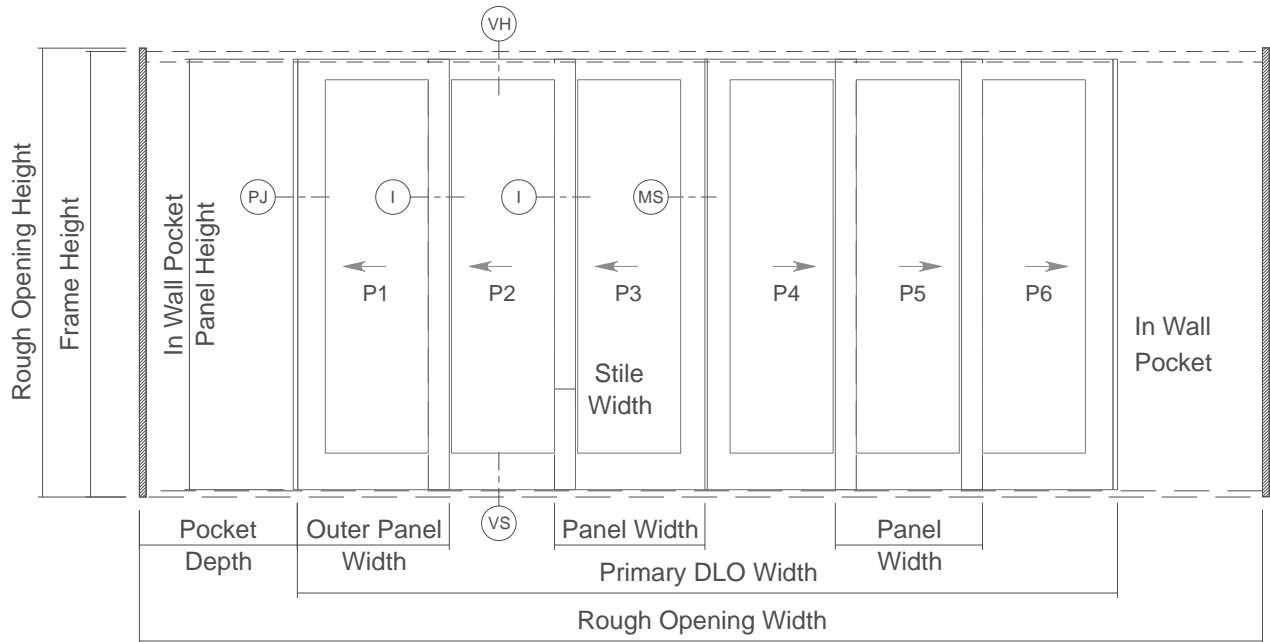

Scale 3" = 1' 0"

All dimensions are approximate.

Rev. 06/05/2024

Pella 2025 Architectural Design Manual | Division 08 – Openings | Windows and Doors | www.Pella.com

MSPD-14



# Pella® Reserve™ Traditional - Multi-Slide Doors

## Unit Sections

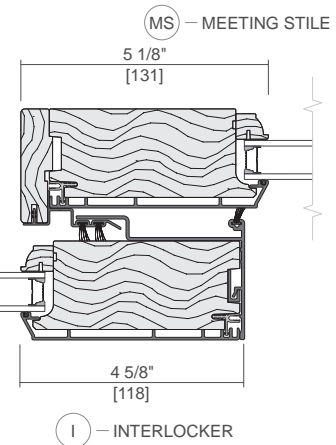
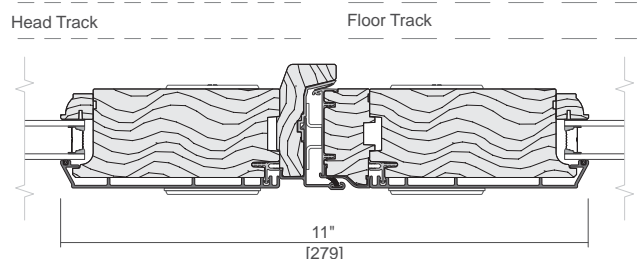
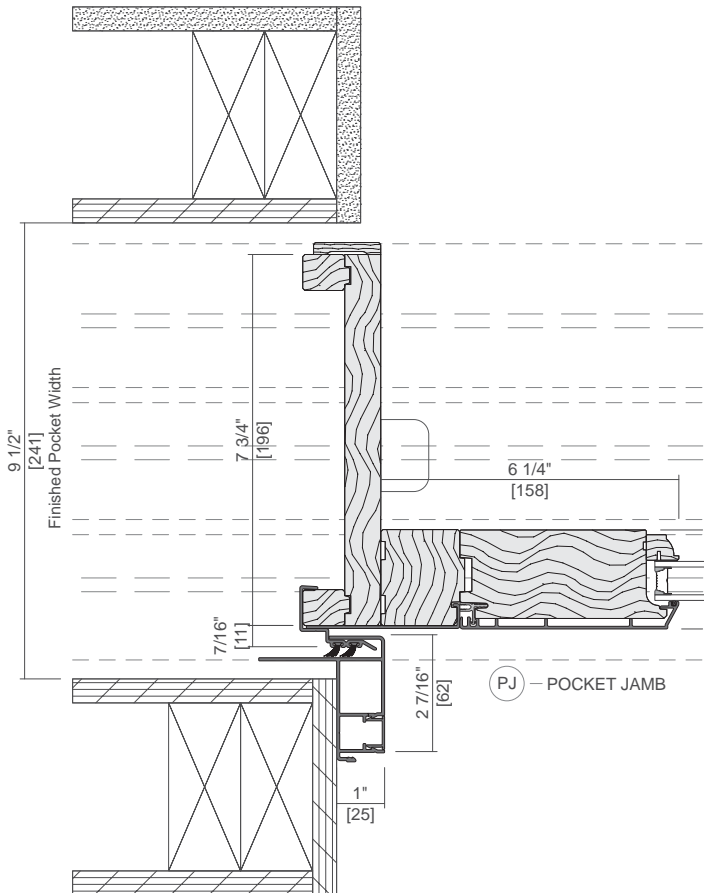
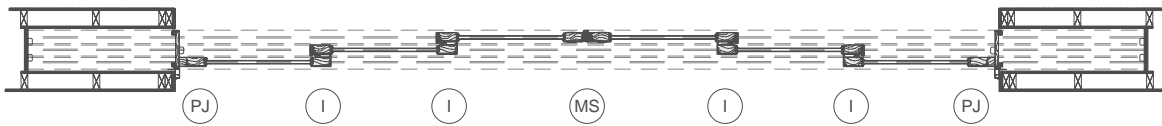
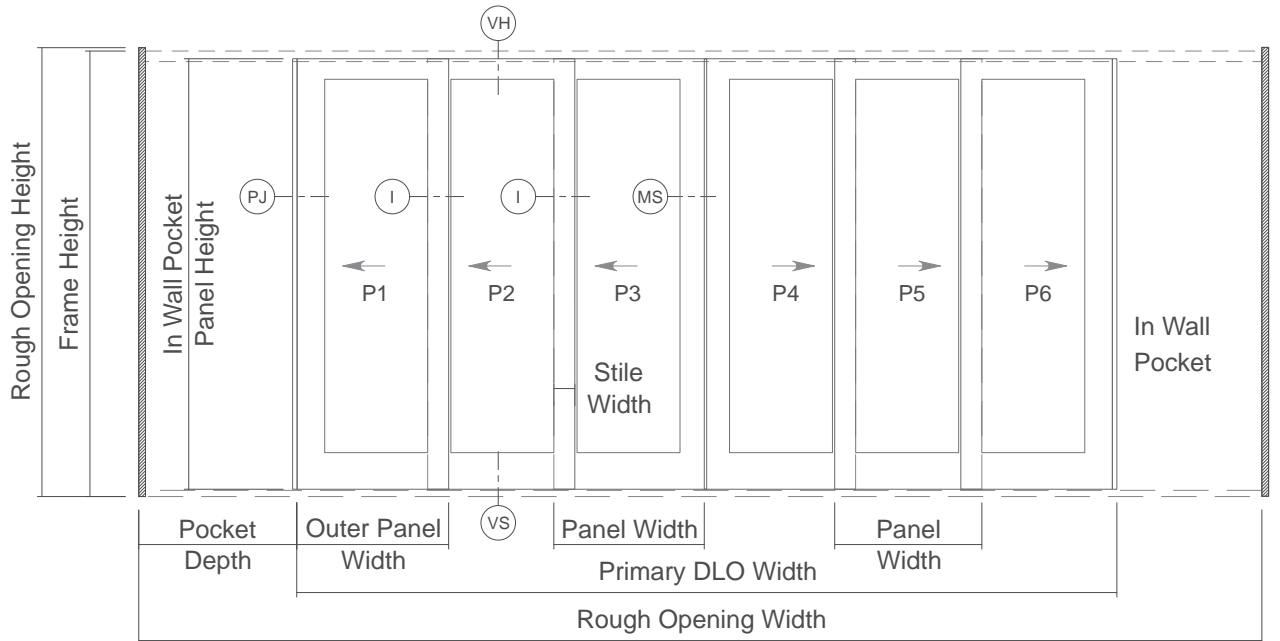

Scale 3" = 1' 0"

All dimensions are approximate.

Rev. 06/05/2024



# Pella® Reserve™ Traditional - Multi-Slide Doors

## Unit Sections

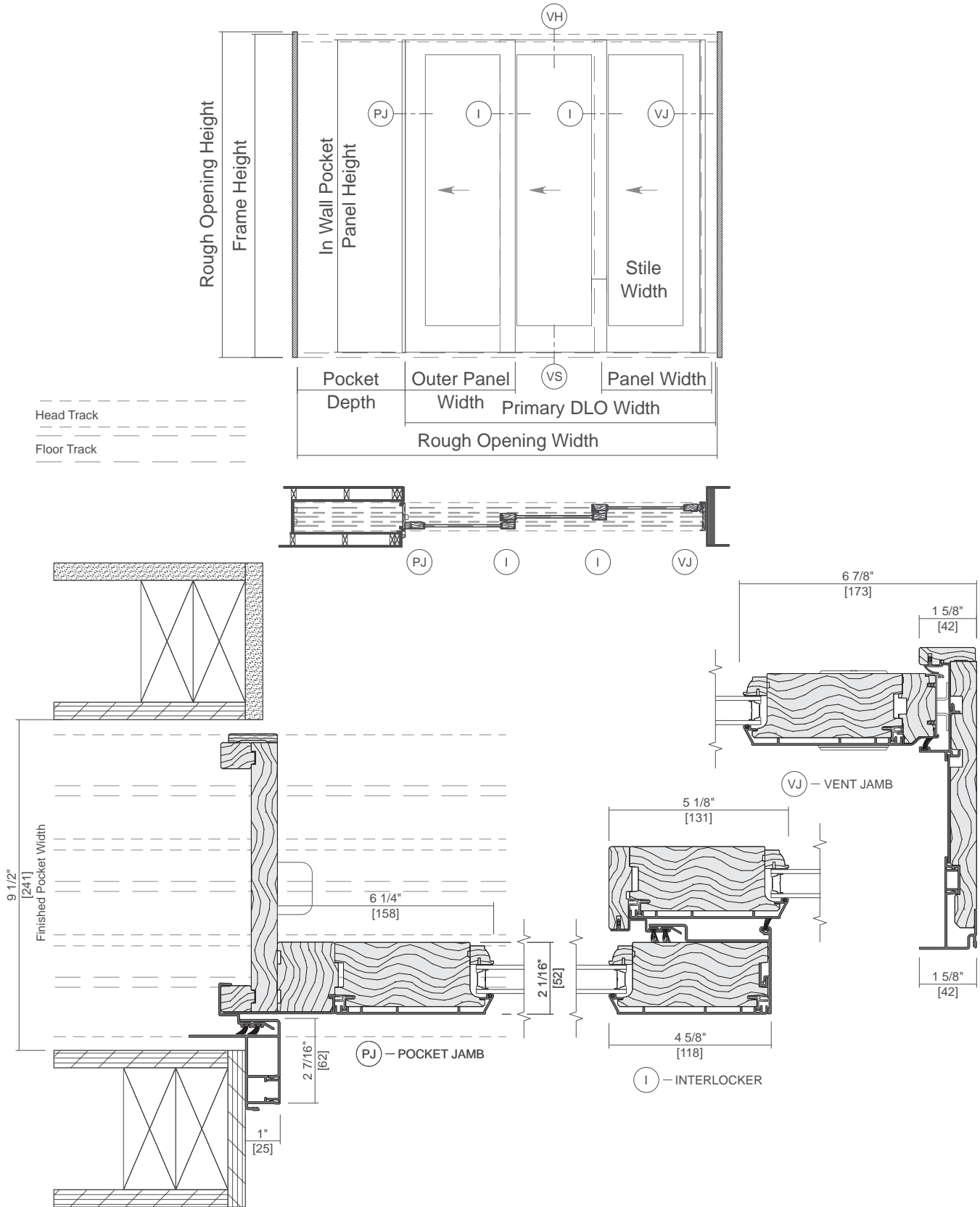

Scale 3" = 1' 0"

All dimensions are approximate.

Rev. 06/05/2024





# Pella® Reserve™ Traditional - Multi-Slide Doors

## Unit Sections

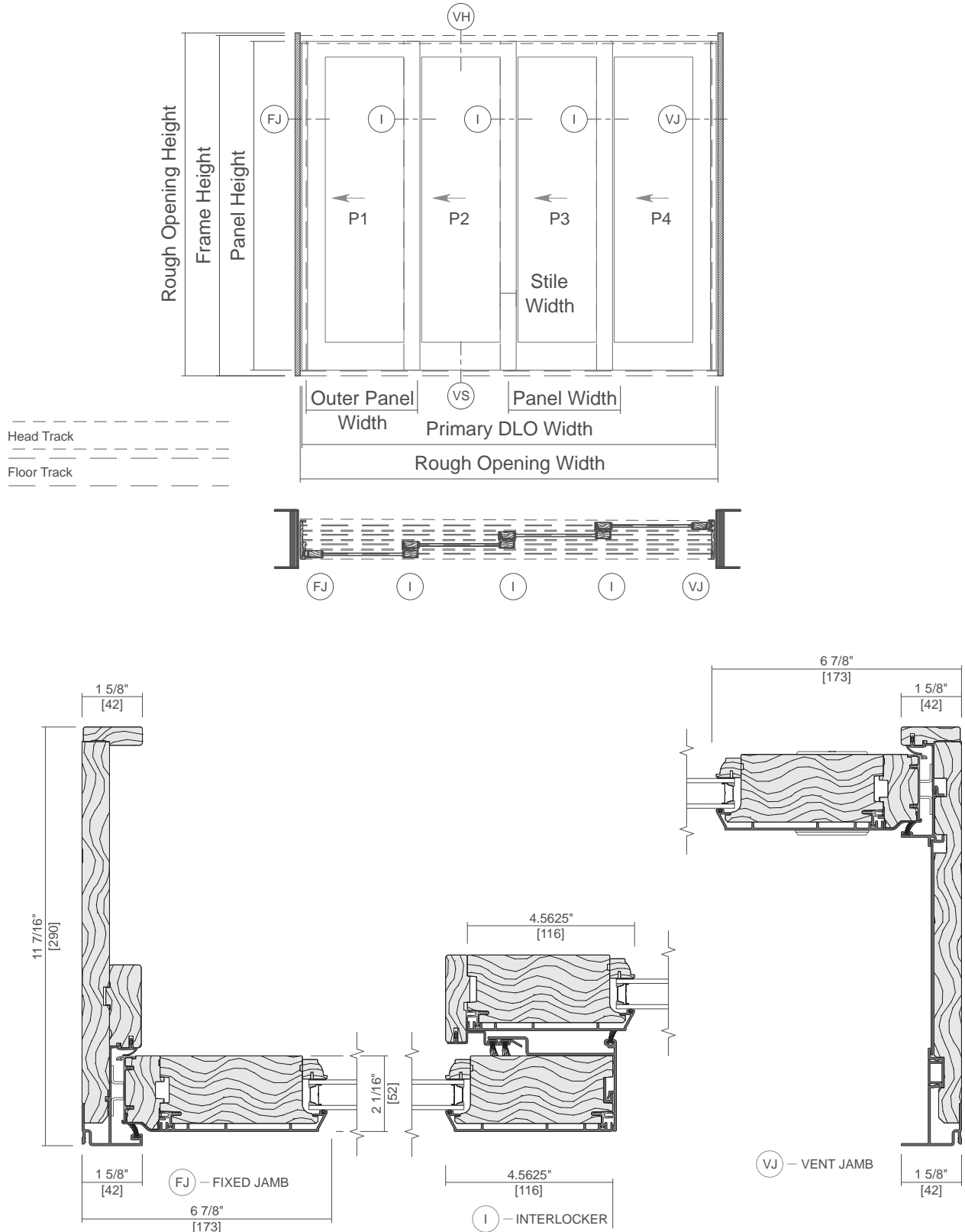

Scale 3" = 1' 0"

All dimensions are approximate.

Rev. 06/05/2024