



Pella® Storm Door Installation Instructions Clad Frame Application Express Installation Alternative

Installation instructions for Pella® Storm Door on a Clad Frame Pella® or Architect Series® Entry Door

Tools: Power Drill with 3/32" Drill Bit, Clamp, Tape Measure, Phillips Screwdriver, Pencil, Utility Knife
Additional Materials (Not Included in Package): (6) #8x3/4" Screws, (12) 1/16" Shims (Length – 1" Minimum/Width – 1" Maximum), (1) 5/16" Shim, Adhesive Substance (i.e. glue stick)

Remove contents from package and place on a flat surface

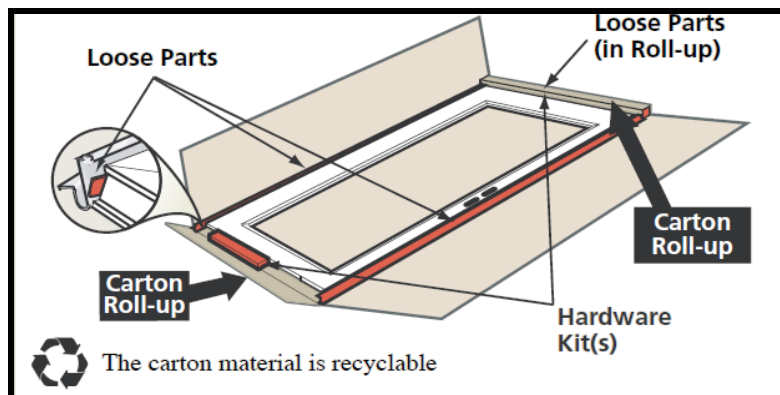

Make sure all parts are accounted for. Check in carton roll-ups

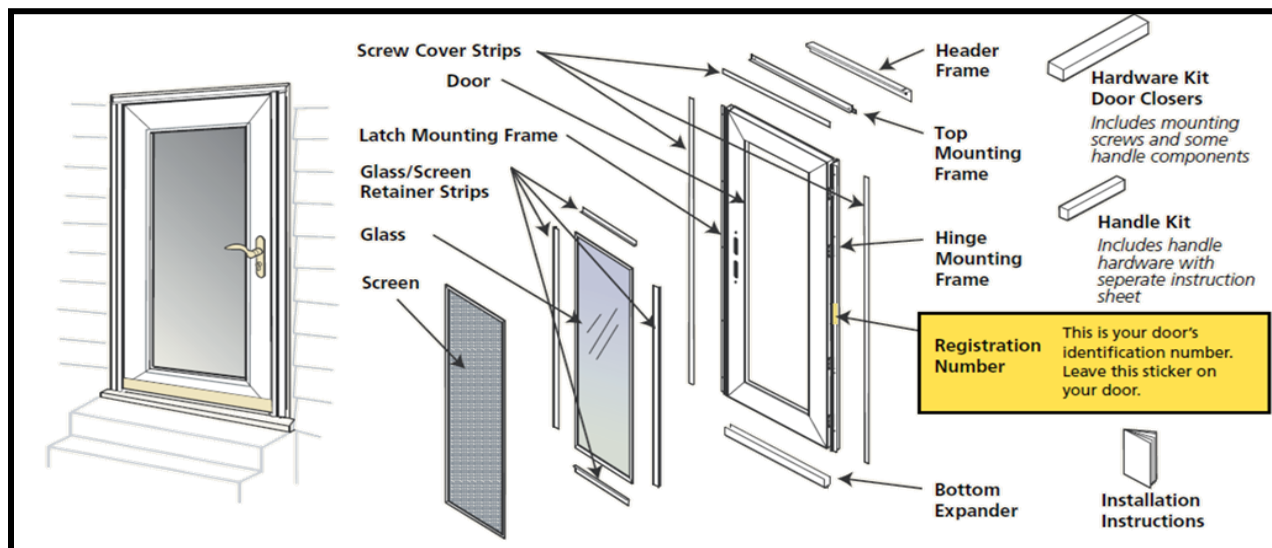

Determine the side you want your door to hinge.

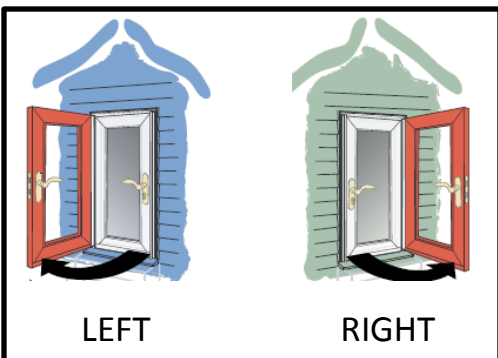

***The following images are shown with left hinge orientation**

2 HINGE MOUNTING FRAME

A **Remove** the hinge mounting frame from the door if it is attached.

B **Adhere** 1/16" shims to hinge side mounting frame. Shims should be applied directly over pre-drilled holes on the interior side of the hinge mounting frame. Align shims with edge of hinge mounting frame.

C **Press** hinge mounting frame against hinge side of clad frame.

D **Place** 5/16" shim below base of hinge mounting frame.

E **Clamp or hold** hinge mounting frame to clad frame to hold frame steady. Be careful not to clamp too tightly and damage the frame.

* To create a flat surface for the clamp, place shim between clamp and frame.

F **Hold** frame steady and pre-drill all hinge side hole locations into the jamb.

G **Continue** holding frame steady and pre-drill all holes on face side of hinge mounting frame.
*If your entry door has clad brickmould, some brickmould will be visible through the holes. Drill through the holes.

*By drilling pilot holes first, you are ensuring the storm door will be placed in the appropriate location.



2A

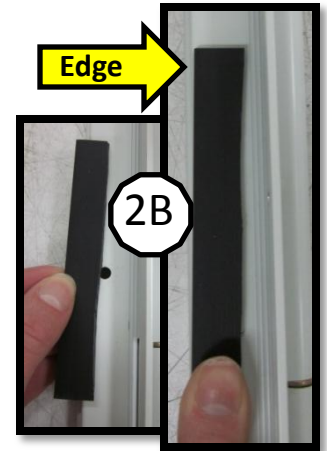

2B

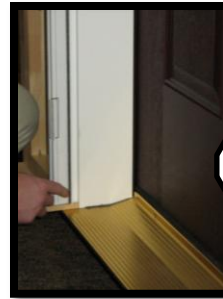

2D

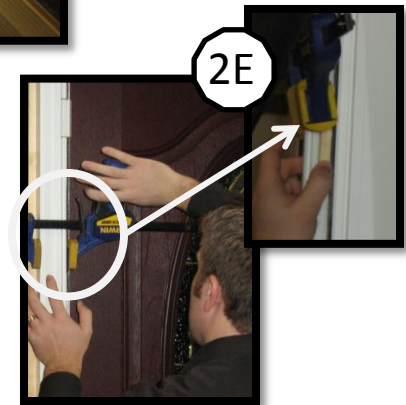

2E

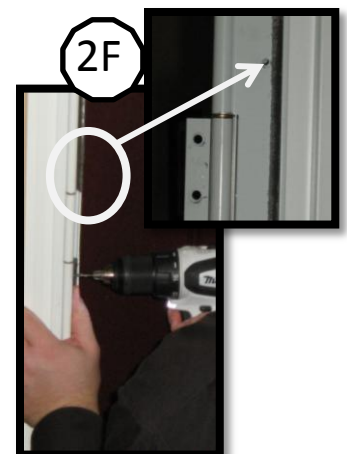

2F



2G

2 HINGE MOUNTING FRAME - CONTINUED

- H** Remove hinge mounting frame and reattach to door.



3 BOTTOM EXPANDER

- A** While door is flat, slide bottom expander tight onto bottom of door.
*Bottom expander is packaged with the handle for Select® 6000 models.

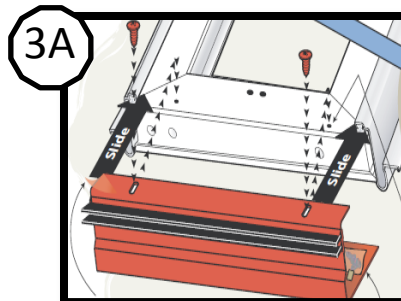

- B** Secure with screws.
*Bag taped inside expander

- C** Remove shipping clips from door.

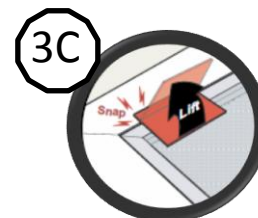

2 HINGE MOUNTING FRAME - CONTINUED

- I** Remove glass and screen.

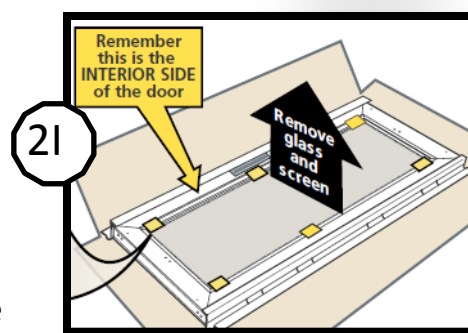

- J** Lift door (with attached hinge mount frame) and place against clad frame, aligning with the pilot holes you previously drilled.

*The 5/16" shim should still be used below the door and hinge mounting frame to align pilot holes.

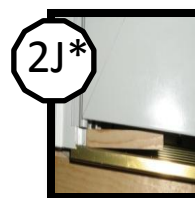

- K** Loosely install three face screws to hold the unit in place, using the pilot holes. **Do not fully seat the face screws.**

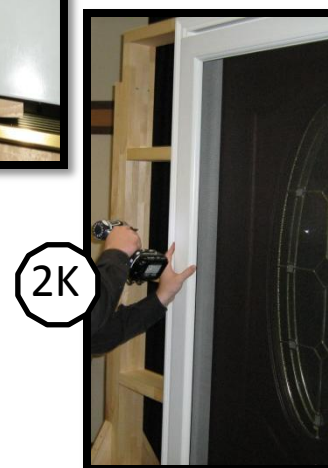

2 HINGE MOUNTING FRAME - CONTINUED

- L** Open Door.
- M** Drive the hinge screws through the pre-drilled holes on the hinge side.
- N** Close Door.
- O** Tighten face screws from step 2K and install remaining face screws.
*Do not over tighten face screws.



2M

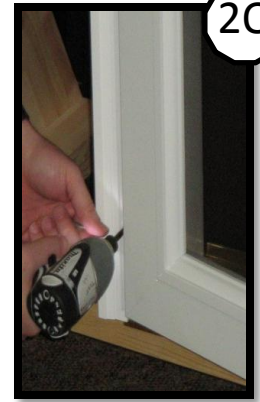

2O

4 GLASS OR SCREEN INSTALLATION

- A** Insert glass panel or screen.
*Hold glass in place while installing retainer strips.

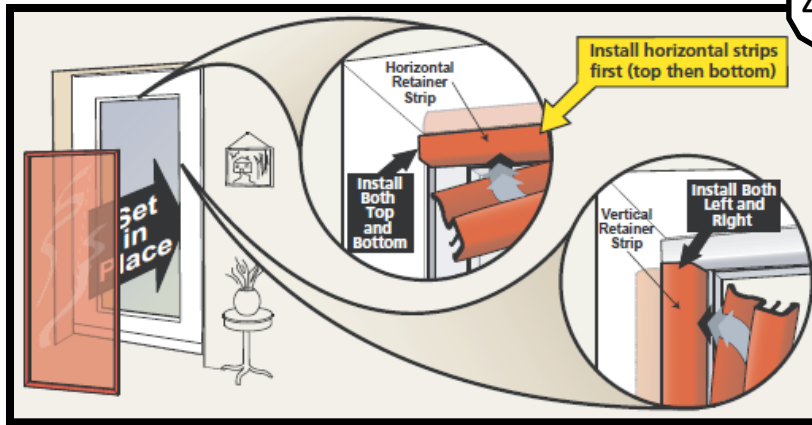

4A

5 LATCH MOUNTING FRAME

- A** Press latch mounting frame against clad frame of the entry door.
- B** Mark all holes on the latch mounting frame with pencil to help with alignment and shim placement.
- C** Remove latch mounting frame from the door by cutting zip tie, if attached.



5B



5C

5 LATCH MOUNTING FRAME - CONTINUED

- D** **Adhere** 1/16" shims to interior side of latch mounting frame one inch above face side mounting holes on adjacent side.

*See image on right



- E** **Make** sure latch mounting frame aligns with marks made in 4B.

*For added stability, clamp or hold latch mounting frame to clad entry door frame (2E).

- F** **At each** location where shims were placed, pre-drill holes through mounting frame, shims and clad entry door frame.

*When pre-drilling holes, position hole location 1/4" from the pile weatherstrip. (This is the same distance the screws were placed on the hinge mounting frame.)

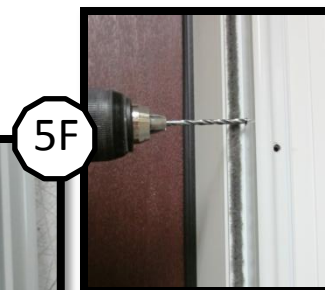

- G** **Install** screws through new pilot holes.

*Make sure your marks are still aligned on the face side.



- H** **Drill** through face side mounting holes.

- I** **Install** face screws.
*Do not overtighten.



6 HEADER FRAME

- A** Center header in entryway opening and pull forward until tight against the latch and hinge side mounting frame.
- B** Pre-drill the two holes and secure with jamb screws.
- C** Position top mounting frame.
* If you have interference with siding, remove the break-off tab with a pliers, then caulk along the back surface, for protection from rain.
- D** Close door. Rest the mounting frame on door. pre-drill the two hole locations. Secure with screws.
- E** Remove the two spacers.

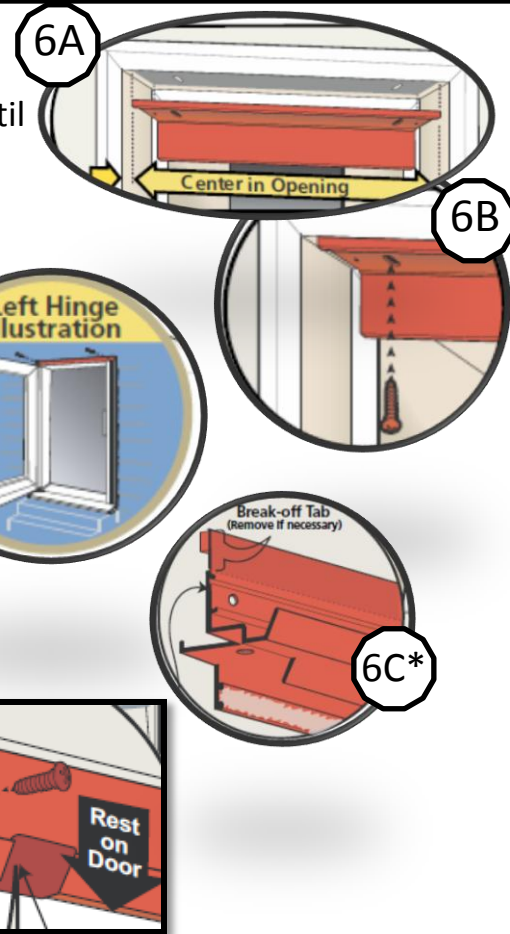

7 HANDLE SET

- A** Install your handle set.
*Go to the separate hardware instruction sheet in the handle kit.

8 CLOSERS

- A** Remove the two yellow clips on the door. Re-install the screws.
- B** Remove the two hole plugs from closer bases.
- C** Insert into the factory drilled holes near the top corner of the door.

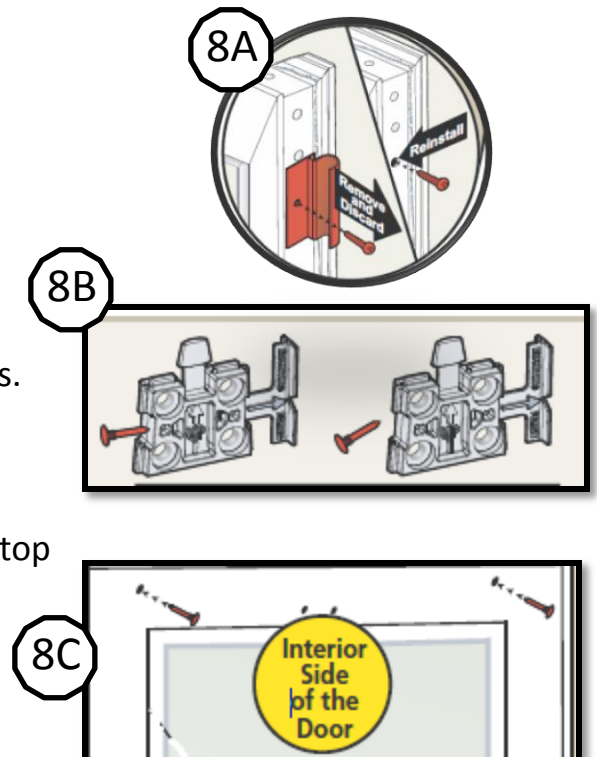

8 CLOSERS - CONTINUED

D Determine which side to install the closers.

E Align closer base with small notch on mounting frame (install both top and bottom).

*For units with brickmould, align the tab with the interior edge of the hinge mounting frame of storm door.

F Pre-drill holes (3/32" bit).

G Secure with screws.

H Break off alignment tabs.

I Locate the top and bottom closers.

J Slide top and bottom closers onto their bases.

K Rotate bottom closer so One-Touch Button points up.

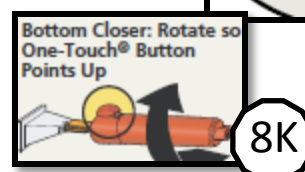
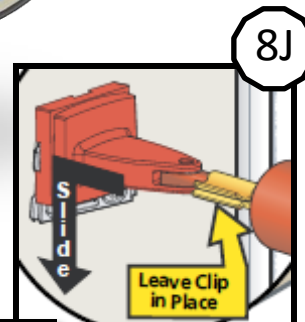
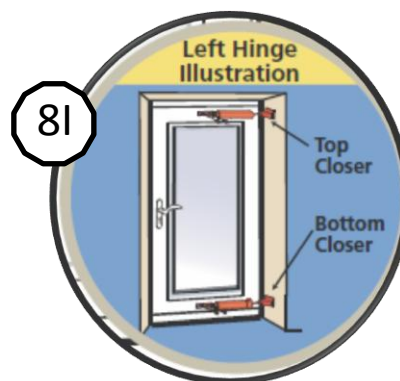
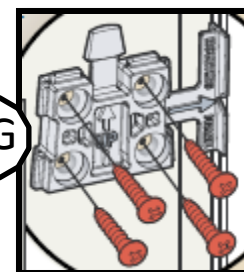
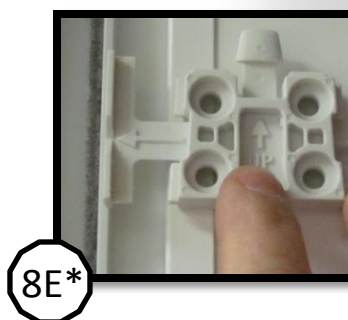
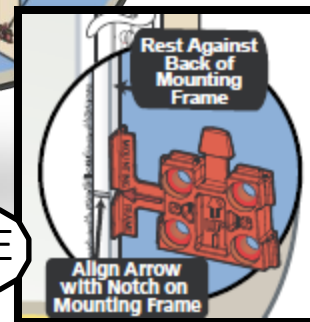
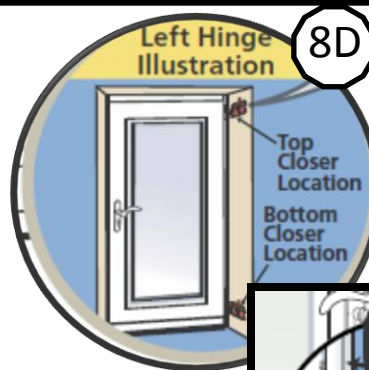

8 CLOSER - CONTINUED

- L** Pin door bracket onto closer.
- M** Close door. Secure door bracket with screws.
- N** Discard clips (top and bottom)
- O** Adjust closer speed with adjustment screw.

One-Touch Button®

To Use: Open the door, then tap then button

To Close: Nudge the door open slightly

- P** Close door. Adjust bottom expander to lightly contact the sill. – Loosen screw to adjust and then retighten.

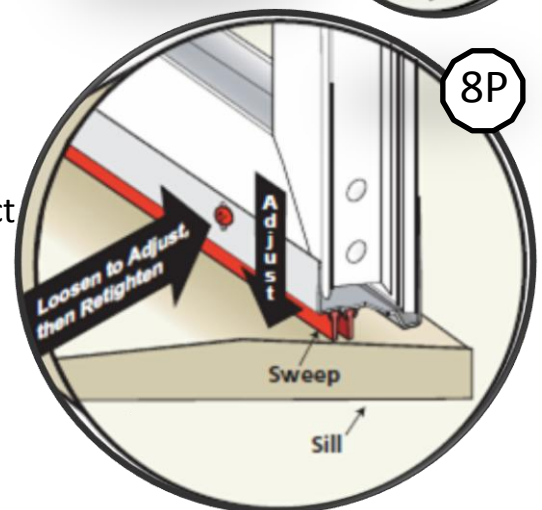
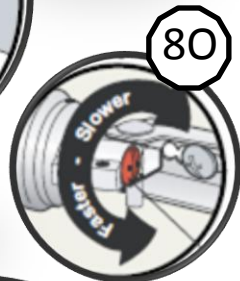
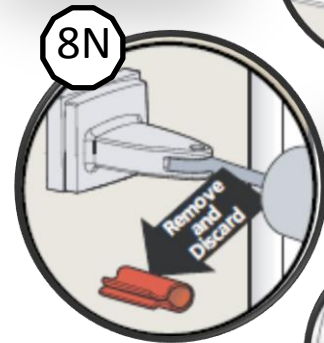
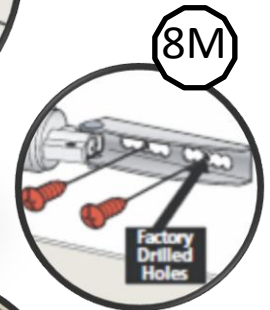
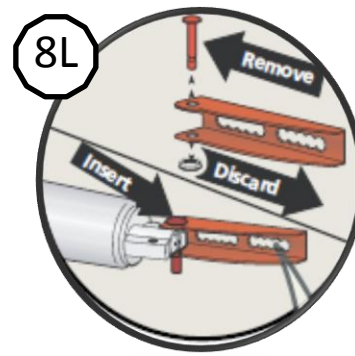

9 SCREW COVER STRIPS

- A** Install screw cover strips (1 Horizontal, 2 Vertical)

