



IMPORTANT SAFETY AND PRODUCT INFORMATION – DOORS

Safety Alert Symbol Reference: These symbols are intended to alert you to potential injury hazards and information. Obey all safety messages.

**COULD
Result in:**



**COULD
Result in:**



**COULD
Result in:**



**COULD
Result in:**



WARNING

To ensure safety and security and help prevent property damage, including possible damage to your window or door, close and lock windows and doors any time they are not being used for venting on a nice day, and particularly during high winds or rain. Ensure all windows and doors are properly fastened to the wall structure according to the product anchor instructions. It is the responsibility of the Buyer or User, the architect, contractor, installer, or other construction professional to ensure the appropriate windows and doors are chosen for the project and the wall construction is designed to resist all loads in accordance with local building code requirements.



CAUTION

Many doors in older homes are painted with lead-based paint. Removal of old doors may disturb this paint. Proper precautions must be taken to minimize exposure to dust and debris. Consult state or local authorities and/or go to www.epa.gov/lead for more information.

NOTICE

Pella products must be stored in an upright, level position not exposed to weather. The storage must be ventilated and provide protection from direct sunlight and excessive temperature.

IMPORTANT NOTICE

Because all construction must anticipate some water infiltration, it is important that the wall system be designed and constructed to properly manage moisture. Pella Corporation is not responsible for claims or damages caused by anticipated and unanticipated water infiltration; deficiencies in building design, construction and maintenance; failure to install Pella products in accordance with Pella's installation instructions; or the use of Pella products in wall systems which do not allow for proper management of moisture within the wall systems. The determination of the suitability of all building components, including the use of Pella products, as well as the design and installation of flashing and sealing systems are the responsibility of the Buyer or User, the architect, contractor, installer, or other construction professional and are not the responsibility of Pella.

Pella products should not be used in barrier wall systems which do not allow for proper management of moisture within the wall systems, such as barrier Exterior Insulation and Finish Systems (EIFS) (also known as synthetic stucco) or other non-water managed systems. Except in arid regions, including California, New Mexico, Arizona, Nevada, Utah and Colorado, Pella makes no warranty of any kind on and assumes no responsibility for Pella windows and doors installed in barrier wall systems. In the states listed above, the installation of Pella Products in barrier wall or similar systems must be in accordance with Pella's installation instructions. Product modifications that are not approved by Pella Corporation will void the warranty.

CARE AND MAINTENANCE: Refer to the Pella Owner's Manual. Visit www.pella.com or your local retailer for more information.

CLEANING INSTRUCTIONS: Refer to the Pella Owner's Manual for comprehensive maintenance and cleaning information. Visit www.pella.com or your local retailer for more information.

NOTICE

DO NOT apply any other types of film to the glass. Doing so could void product warranty.

NOTICE

DO NOT use abrasives. DO NOT scrape or use tools that might damage the surface.

NOTICE

DO NOT use inappropriate solvents or brickwash or cleaning chemicals. If you do, permanent damage can result and the product failure, loss or damage would not be covered by the Limited Warranty.

FINISHING INSTRUCTIONS (WOOD PATIO DOORS): Paint or finish immediately after installation.

If products cannot be finished immediately, cover with clear plastic that allows venting to protect from dirt, damage and moisture. Remove any construction residue before finishing. Sand all wood surfaces lightly with 180 grit or finer sandpaper. DO NOT use steel wool. BE CAREFUL NOT TO SCRATCH THE GLASS. Remove sanding dust. Pella products must be finished according to these instructions, and those in the Pella Owner's Manual. failure to follow these instructions voids the Limited Warranty. Finishing panel edges is optional for Patio Doors.

NOTICE

To maintain proper product performance do not paint, finish or remove the weatherstripping, mohair dust pads, gaskets or vinyl parts. Air and water leakage will result if these parts are removed. After finishing, allow venting Doors and doors to dry completely before closing them. If paint, stain or finish gets on the weatherstripping, wipe it off immediately with a damp cloth.

PAINTING INSTRUCTIONS: Wood door exteriors are factory primed. Wood doors require painting immediately after installation. The factory applied primer is not intended for long term exterior exposure. Sand all un-primed interior wood surfaces lightly with 180 grit or finer sandpaper before priming and painting. Use two coats of a 100% latex paint that has a good blocking resistance. Finishing panel edges is optional for Patio Doors.

Pella Corporation is not responsible for interior paint and stain finish imperfections for any product that is not factory-applied by Pella Corporation. For additional information on finishing see the Pella Owner's Manual or go to www.pella.com.

NOTICE

The use of unapproved finishes, solvents or cleaning chemicals may cause adverse reactions with door materials. Pella will not be responsible for problems caused by the use of unapproved materials. If in doubt, contact your local retailer or representative.

EXTERIOR FINISH OF EXISTING FRAME (POCKET REPLACEMENT): It is the responsibility of the homeowner, contractor or installer to ensure any exposed unfinished wood is covered or finished. Possible methods include, however are not limited to, covering with aluminum coil stock or painting.



FULL FRAME OR PANEL REMOVAL WHEN PREPARING TO INSTALL A NEW SLIDING DOOR

This method of Full Frame Removal involves removing the panels and entire frame of the existing door from the wall. The resulting opening is the original rough opening. The existing door nailing fins are usually nailed to the studs in frame construction with siding, brick veneer or other exterior material applied over the fin on the outside. The interior may have a drywall return from the wall to the door frame.

CAUTION Many doors in older homes are painted with lead-based paint. Removal of old doors may disturb this paint. Proper precautions must be taken to minimize exposure to dust and debris. Consult state or local authorities for more information and/or go to www.epa.gov/lead for more information.

TOOLS REQUIRED:

- Utility knife 
- Pry bar 
- Hammer 
- Heat gun 
- Angle grinder 
- Phillips and Standard screwdrivers 
- Reciprocating saw 
- Putty knife 
- Deglazing wheel 

**REMEMBER TO USE APPROPRIATE PERSONAL PROTECTIVE EQUIPMENT.
APPLY ADHESIVE FILM OR DUCT TAPE TO THE GLASS TO PREVENT BREAKAGE.**

ALUMINUM PANEL AND/OR FRAME REMOVAL

- Score the paint or varnish between the interior trim and the wall or between the drywall return and the door frame to minimize damage. (Frame removal only).
- Remove the interior trim.
- Score the sealant or paint between the exterior siding or brick and the door frame.
- Remove the screen and vent panel from the old door. If it is not removable, see steps G-I.
- Remove the division bar by removing the screws at the ends or cutting it with a reciprocating saw.
- Remove the fixed panel. Remove any screws holding the fixed panel. Slide it and lift it out of the frame.

If the panels are not removable or the glass is sealed to the frame:

- Remove the glazing bead using a putty knife or small pry bar.
- For single pane doors with divided lights (grids). Use an angle grinder with a cut-off wheel to cut the end of the bars where they intersect with the sash or frame. This will allow the door glass to be removed more quickly.
- Heat the glazing seal using an electric heat gun.
- While applying heat, press a de-glazing wheel between the glass and panel or frame. Continue around the perimeter of the panel. Apply light, constant pressure to separate the glass from the panel or frame. Recycle or dispose of the glass properly.

Note: Wear appropriate personal protective equipment and keep the heat source away from flammable materials.

Stop here for pocket replacement, complete steps K-L for full frame replacement (Not applicable for flush flange pocket replacement).

- Cut through the frame using a reciprocating saw.
- Pry the frame away from the brick or siding. Use a block of wood under the pry bar to protect interior or exterior finishes. Dispose or recycle of the frame materials properly.

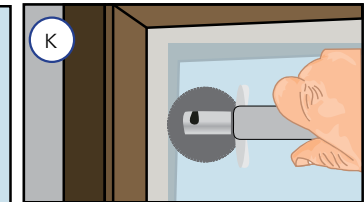
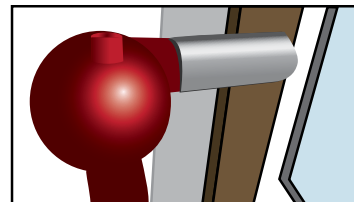
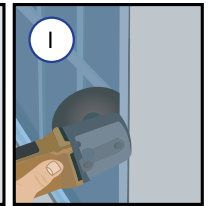
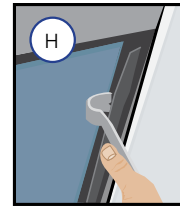
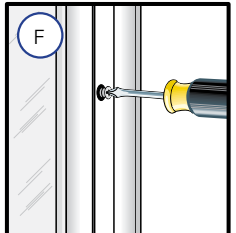
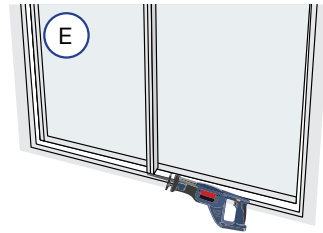
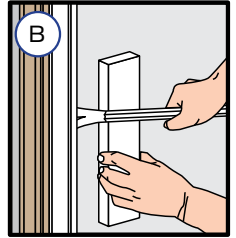

BRICKMOULD FRAME REMOVAL

- Score paint or varnish between the interior trim and the wall with a sharp utility knife.

Note: This will minimize the damage to the interior wall and trim.

- Remove the interior trim. Remove the interior trim from all the four sides of the door including the stool at the bottom of the door. If the interior trim is being reused, pull the nails out through the back side of the board with nipper pliers.
- Cut the exterior sealant line between the exterior brickmould or trim and the exterior siding or wall cladding.
- Remove the exterior brickmould or flat trim.
Remove hinge and strike screws.

Note: DO NOT disturb existing head flashings.

- Remove the door frame.

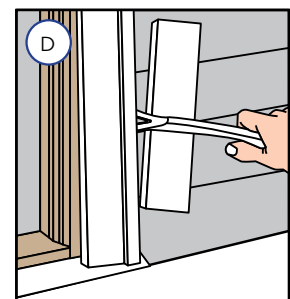
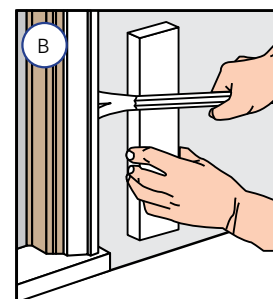
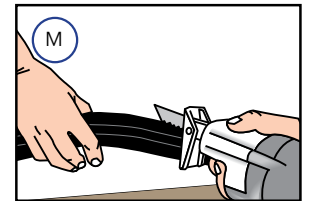
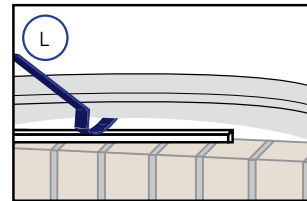

Consult with local providers and authorities to recycle or properly dispose of old door components.



PREPARING FOR SLIDING DOOR INSTALLATION WITH FLUSH FLANGE OR ENDURA CLAD EXTERIOR TRIM FOR REPLACEMENT

YOU WILL NEED TO SUPPLY:

- Moisture resistant shims/spacers (12 to 20)
- Fasteners (see anchor instructions and tables at the end of this booklet)
- Closed cell foam backer rod/sealant backer (21 to 30 ft.)
- Pella® SmartFlash™ foil backed butyl window and door flashing tape or equivalent
- Pella Window and Door Installation Sealant or equivalent high quality, multi-purpose sealant.
- Low Expansion, low pressure polyurethane insulating window and door foam sealant. DO NOT use high pressure or latex foams
- Sill pan (optional) 6-5/8" x (Rough Opening Width +2)
- Pella aluminum sill support or wood blocking
- Interior trim and/or jamb extensions (15 to 40 ft.)

INSTALLATION CLIP OPTION

(Pella® Reserve, Pella® Lifestyle Series and Pella® Impervia only):

- 6" installation clips (710L)
- #8 x 1-1/2" corrosion resistant screws or 3/16" x 1-1/2" masonry screws

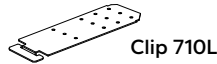

TOOLS REQUIRED:

- Tape measure
- Level
- Square
- Hammer
- Stapler
- Sealant Gun
- Scissors or utility knife
- Tin Snips
- Screwdrivers (#2 Phillips with 8" shaft and small flat blade)
- Drill
- Drill bits 1/8", 5/32", 3/8", and masonry drill bits for masonry applications
- Fine tooth chop saw
- Large hook tool

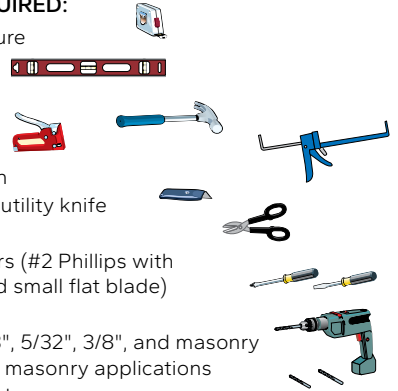

WARNING Installation will require (2) or more persons for safety reasons.

ROUGH OPENING VERIFICATION

A. Confirm the opening is plumb and level.

NOTICE It is critical the bottom is level and it does not slope to the interior or exterior.

B. Remove dirt, oil or debris from the opening and surrounding wall surfaces.

C. Confirm the door will fit the opening. Measure all four sides of the opening to make sure it is 1/2" to 3/4" larger than the door in both width and 1/2" larger in height. Measure the width and height in several places to ensure the header or studs are not bowed. Confirm the opening header is not sagging. The header must be designed to bear the weight of all building/structure loads.

NOTICE 1-1/2" or more of solid wood blocking is required around the perimeter of the opening. Fix any problems with the rough opening before proceeding.

NOTICE It is important to consider the door's exposure to weather, the exterior landing surface type and its proximity to the door sill, and to confirm impervious exterior surfaces properly slope away from the door prior to continuing with installation.

Before installing, verify performance of the product meets the requirements of the application and region. To reduce the likelihood of water infiltration where application exceeds product performance, install doors under an overhang that extends to meet a 45 degree line from the door sill and slope the exterior 2 degrees away from the door or use a stepdown. Failure to do so may result in damage to the interior of the structure.

NOTICE FAILURE TO PROVIDE ADEQUATE ROUGH OPENING SILL PROTECTION FOR WOOD THRESHOLDS WILL VOID PRODUCT WARRANTY.

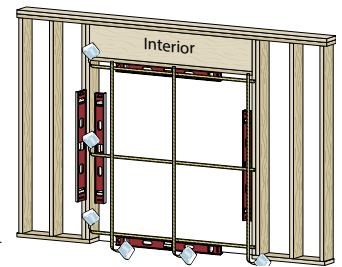

PREPARE THE DOOR FOR INSTALLATION

A. Remove plastic wrap and cardboard packaging from the door. For Pella® 250 Series doors with laminate film, remove protective film from all parts.

B. Inspect the product for any damage such as cracks, dents or scratches. DO NOT install damaged products.

C. For Knock-Down (KD) Doors: Complete field assembly of the frame in accordance with the KD assembly instructions.

D. All Doors: Remove the vent panel prior to installation (if applicable). Slide the vent panel about halfway open. Lift the panel up and tilt the bottom of the panel away from the door frame. Then lower the panel out of the top track. Carefully set the panel aside.

Pella® Reserve and Lifestyle Series Sliding Doors: Remove the shipping spacers off the top and bottom of the vent panel.

Pella® Impervia: Remove the shipping spacers from the bottom of the vent panel.

Pella® 250 Series: Remove the jamb pocket covers/caps and head cover/cap. For laminate units, remove the laminate protective film. Pre-drill anchor holes.

Pella® 150 Series and Encompass by Pella®: If reversing the door slide direction, refer to the instructions later in this booklet.

F. Units with EnduraClad Exterior Trim without fin or pre-punched holes: Install clips or pre-drill holes for frame screws.

Installation clip option (Reserve, Lifestyle Series, and Impervia): Installation clips can often be used in place of frame screws. Slide clips into the t-slot groove at the upper frame corners and secure clips to the frame with tape.

Refer to the anchor pages at the end of this booklet. Additional preparation may be required for Performance Upgrade, impact-resistant products, or to comply with local building code requirements.

G. Read the entire instruction before proceeding.

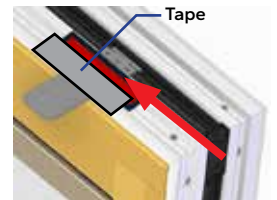
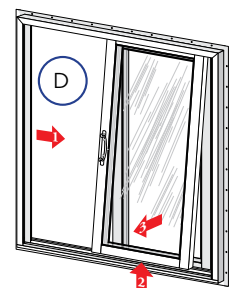

These instructions were developed and tested for use with wall systems designed to manage water. These instructions are not to be used with any other construction methods or door frame types. Installation instructions for use with other construction methods or frame types may be obtained from Pella® Corporation, your local Pella retailer or www.installpella.com. Building designs, construction methods, building materials, and site conditions unique to your project may require an installation method different from these instructions and/or additional care. Determining the appropriate installation method is the responsibility of you, your architect, or construction professional.



BY PURCHASING, INSTALLING OR USING PELLA PRODUCTS (INCLUDES PELLA GOODS AND PELLA SERVICES), YOU AGREED TO THE TERMS OF THE LIMITED WARRANTY AND YOU AND PELLA FURTHER AGREE TO ARBITRATE DISPUTES ARISING OUT OF OR RELATING TO PELLA PRODUCTS, AND YOU WAIVE ANY RIGHT TO PARTICIPATE IN A CLASS ACTION RELATED TO PELLA PRODUCTS unless you notify Pella of your decision to opt out of the Arbitration Agreement no later than ninety (90) calendar days from the date you purchased or otherwise took ownership of Your Pella Goods. Opting out of the Arbitration Agreement will not affect the coverage provided by any applicable limited warranty pertaining to Your Pella Products. For opt out information and additional details please read the Limited Warranty and Arbitration Agreement for your Pella Products at www.Pella.com/arbitration.



FULL FRAME REPLACEMENT IN STUCCO WITH FLUSH FLANGE
 ROUGH OPENING PREPARATION USING WATER MANAGEMENT LINER (US PATENT 8,833,035)

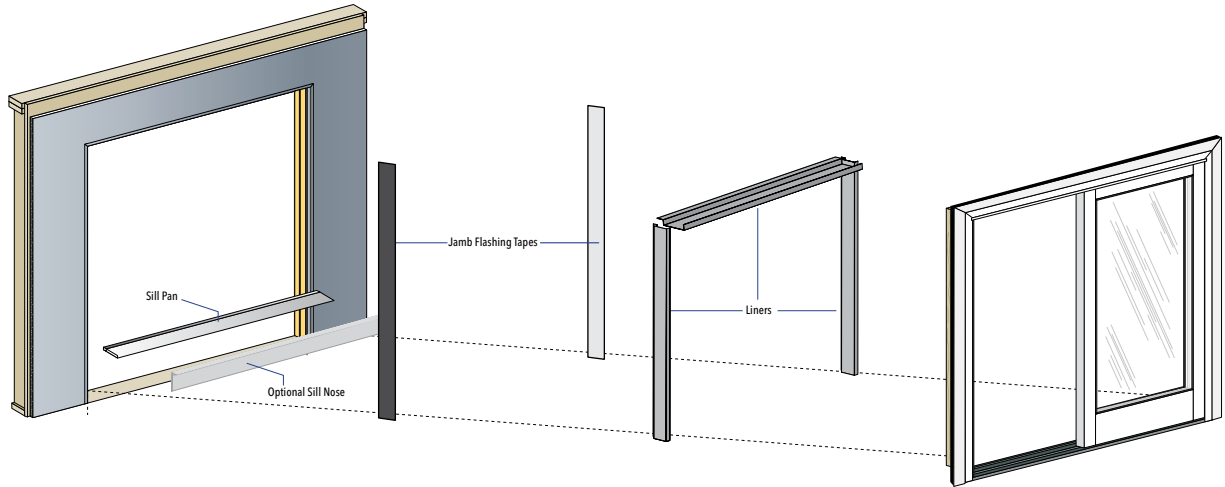

1 REMOVE THE EXISTING DOOR

REMEMBER TO USE APPROPRIATE PERSONAL PROTECTIVE EQUIPMENT.

- A. **Measure the width and height** of the opening inside the drywall return. The new door frame size must be at least 1/2" to 3/4" smaller than this measurement in width and 3/8" minimum in height.
- B. **Cut through the existing door nailing fin on all sides.** Cut against the edge of the frame with an angle grinder or circular saw with diamond blade. Use a reciprocating saw to finish the cutting the corners. Be careful not to chip or crack the stucco.

Note: Use a vacuum with a HEPA filter to minimize dust while cutting. Maintain a safe distance between the vacuum and power tool.

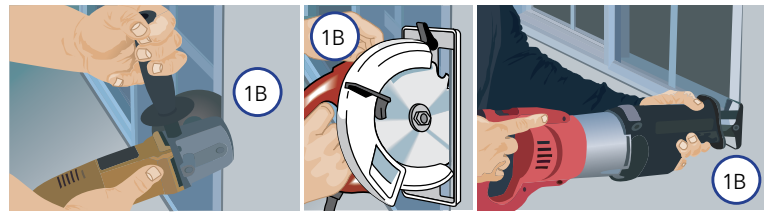

- C. **Remove the existing door and dispose of it properly.**
- D. **Make any modifications or repairs to the opening at this time.**

- E. **Cut the stucco and existing door fin along the opening sill** to ensure the stucco does not project above the sill framing (if applicable).

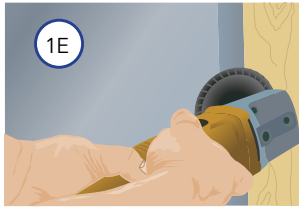

- F. **Clean the rough opening** by vacuuming all dust and debris.
- Note: If the new door frame is deeper than the existing door frame, it will be necessary to cut the interior flooring material back to allow the door flush flanges to contact the existing aluminum door frame.*

2 PREPARE THE OPENING

- A. **Construct a sill pan for the door.** Measure the rough opening width and add 2". Measure 1" up from each end and cut through the vertical leg of the pan material. Bend the bottom (side) flaps of the pan material up, then bend the back leg around the end of the pan. Make the sill pan depth equal to the door frame depth minus 2-1/8". Seal all the corners and overlaps.

Dry fit the sill pan and the door into the opening.

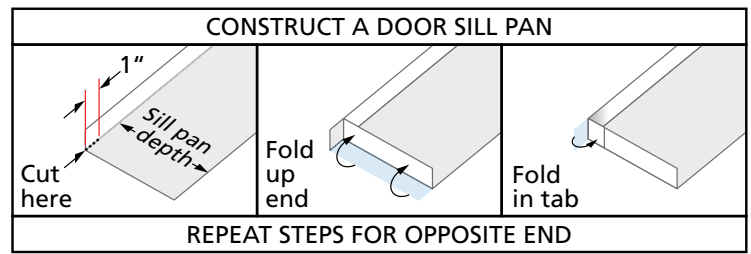

- B. **Cut the sill nosing** to the rough opening width plus two times the flange width. Notch the sill nosing.

Note: 4-sided flush flange doors and openings with an exterior concrete slab flush with the opening sill do not require the sill nosing

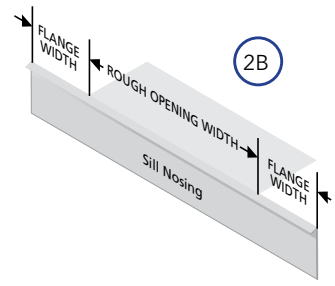

- C. **Apply beads of 3/8" diameter sealant** across the rough opening sill in the locations shown. Make sure the lines of the sealant covers the area between the stucco and rough opening.

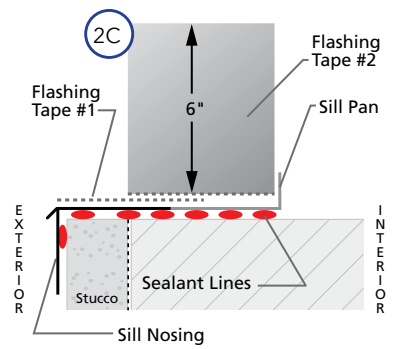

- D. **Place a 3/8" bead of sealant** at each corner of the rough opening from the stucco along the edge of the rough opening as shown.

Note: It is important to avoid letting the sealant skin over prior to applying the sill pan.



FINISHED DOOR INSTALLATION AND SEALANT DETAILS

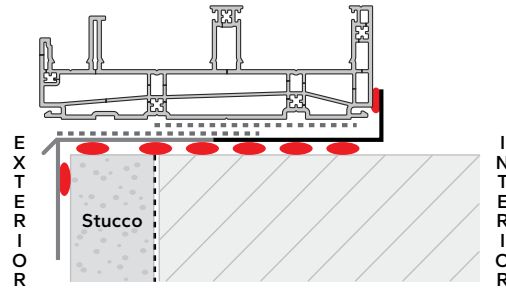
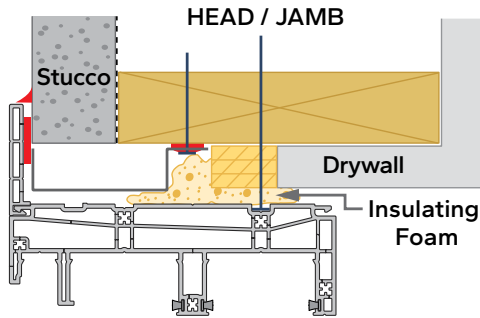

2 PREPARE THE OPENING
CONTINUED

- E. Install the sill pan and sill nosing into the opening. Press down to seal them into the opening. DO NOT overlap.
- Note: Cut back drywall return on jamb as needed to allow clearance for sill pan.
- F. Apply sealant at nosing ends continuing from the front of the sill pan around the exterior surface of the wall where the sill nosing will end.
- G. Cut two pieces of flashing tape 12" longer than the rough opening width. Place tape #1 across the sill nosing just up to where the nosing begins to slope down and extending 6" up each jamb. Apply the second piece of flashing tape over-lapping the first piece and the exterior edge of the sill pan and 6" up each jamb.
- H. Cut two pieces of flashing tape equal to the height of the rough opening. Place the exterior edge of the tape along the exterior edge of the stucco. Press the tape down firmly over the sealant, exposed framing, edge of filler strip and onto the surface of the drywall.

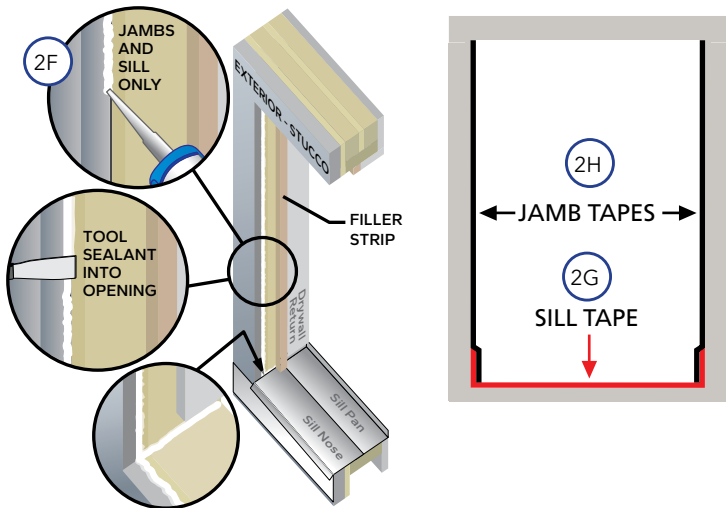

- I. Cut 1/2" thick wood or expanded PVC filler strips for the jambs and head. Make the width of the strips equal to the distance from the surface of the stucco to the surface of the drywall minus 2-1/8".
- J. Install filler strip using #8 x 1-1/2" wood screws at 16" on center maximum spacing.
- K. Place a 3/8" bead of sealant (or enough to cover the area) between the stucco and the rough opening at the jambs. DO NOT seal the head. Tool the sealant with a putty knife to press the sealant into the opening.

CAUTION The cut fin may have sharp edges!

- L. Cut the head liner equal to the opening width.

2 PREPARE THE OPENING
CONTINUED

- M. Make 1/4" deep by 3/4" wide tabs, bending them down as shown.
- N. Apply a 3/8" bead of sealant across the top of the opening 1-3/4" from the surface of the stucco and 1" down the sides.
- O. Secure the head liner over the sealant using self-drilling screws 6" from ends and every 12". The liner may be shifted to allow the stucco to extend below the rough opening.

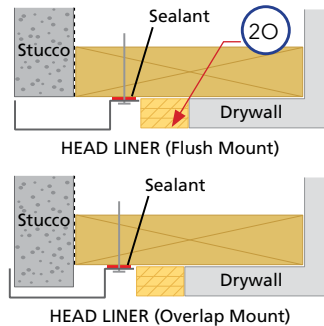

- P. Cut two jamb liners to fit between the sill and the head liner.
- Q. Make a 1/2" x 3/4" notch at the bottom of each jamb liner
- R. Apply 3/8" beads of sealant down each jamb 1-3/4" from the surface of the stucco.
- S. Secure the jamb liner over the sealant using self-drilling screws 6" from ends and every 12". The liner may be shifted to allow the stucco to extend into the rough opening.
- T. Seal the upper corners where the head and jamb liners meet.
- U. Seal the lower corners where the jamb liner meets the sill. Do not seal the notch.
- V. Refer to the Pocket Replacement with Flush Flange instruction beginning at step 1T in this booklet to complete the installation.

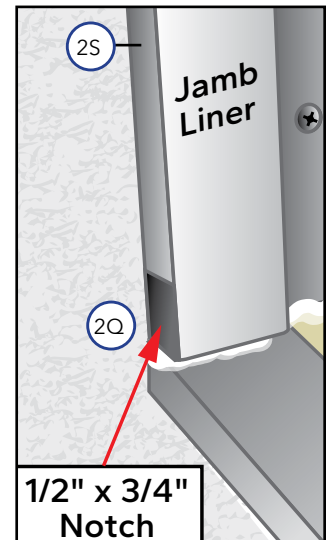
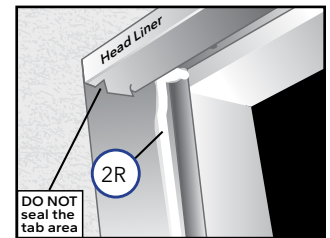
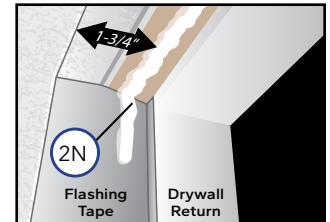
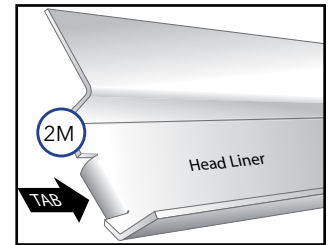



POCKET REPLACEMENT WITH FLUSH FLANGE

FOR THE INSTALLATION OF NEW FLUSH FLANGE DOORS IN EXISTING ALUMINUM FRAMES WITH STUCCO WALLS IN ARID CLIMATES

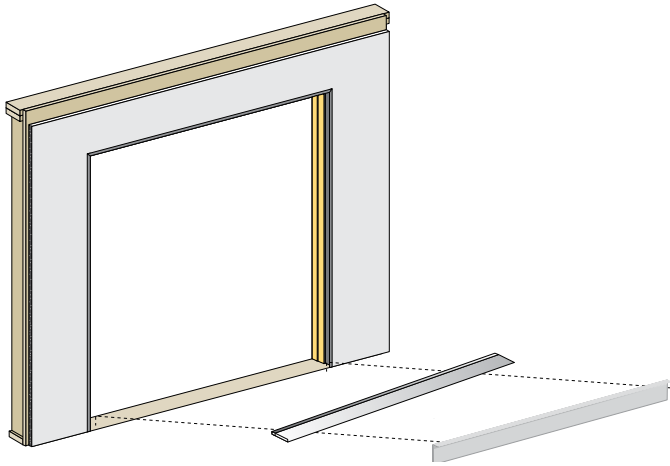

1 PREPARE THE OPENING

- A. Measure the width and height of the opening in the remaining aluminum frame after sash/glass removal. The new door must be 1/2" to 3/4" smaller in width and height.
- B. Remove the sash and/or glass from the existing aluminum door. It may be necessary to cut the divider between the venting panel and fixed glass areas with a reciprocating saw. Refer to the sash removal instructions at the beginning of this booklet.
- C. Cut the existing door sill out of the opening as close to the jamb as possible using a reciprocating saw or side grinder.
- D. Clean the existing frame and sill so it is free of dirt and debris.
- E. Remove the door lock strike from the lock jamb of the existing door frame.

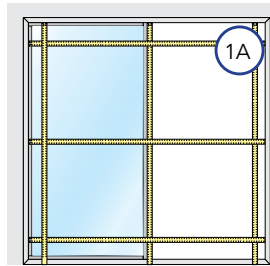

- F. Place a bead of sealant at each joint where the existing door frame jambs meet the existing door sill pieces. Fill any holes in the jamb and head with sealant.
- G. If the weep holes of the existing sill have been cut away, drill new weep holes in the existing door jambs. Be sure to drill weep holes in all vertical jamb legs, except the most interior leg.



NOTICE Ensure all new or existing weep holes are open before proceeding with the installation.

- H. Cut one piece of flashing tape 6" longer than the existing aluminum frame width.
- I. Cut wood blocking to fill the channels in the head and jambs of the existing door frame. The blocking will support new shims and hinge screws. The blocking should be flush with the protruding legs of the frame.
- J. Set the blocking in 3/16" sealant lines and secure with #8 x 2-1/2" screws.

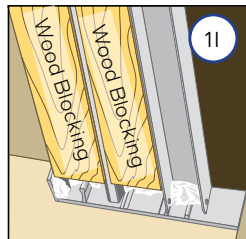

- K. Construct a sill pan for the door. Measure the rough opening width and add 2". Measure 1" up from each end and cut through the vertical leg of the pan material. If there is a step down at the exterior of the door opening, make the sill pan depth equal to the door frame depth - 2-1/8". If there is NO step down, make the sill pan depth equal to the frame depth. Bend the bottom (side) flaps of the pan material up, then bend the back leg around the end of the pan. Dry fit the sill pan and the door into the opening.

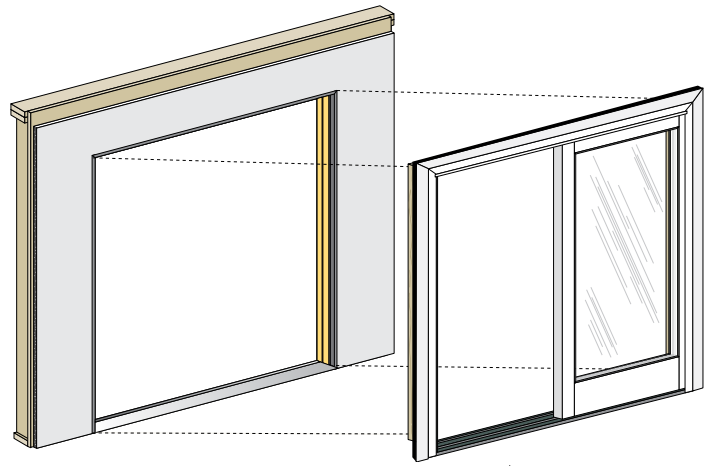
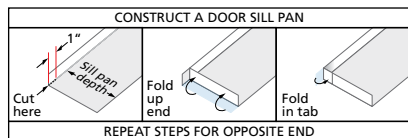

1 PREPARE THE OPENING CONTINUED

For three-sided flush flange doors:

- L. If there is a step down at the exterior of the door opening, cut the sill nosing to the rough opening width plus two times the flange width. Notch the sill nosing. If there is NO step down, skip to Step M.

Note: If the new door frame is deeper than the existing door frame, it will be necessary to cut the interior flooring material back to allow the door flush flanges to contact the existing aluminum door frame.

- M. Apply lines of 3/8" diameter sealant across the rough opening sill in the location shown. Make sure the lines of the sealant covers the area between the stucco and rough opening.

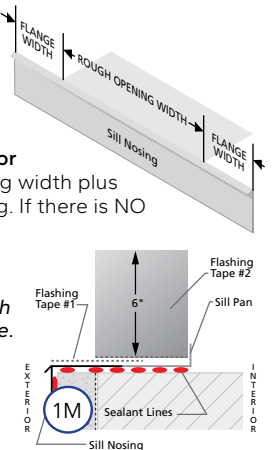

- N. Place a 3/8" bead of sealant at each corner of the rough opening from the stucco along the edge of the rough opening as shown.

Note: It is important to avoid letting the sealant skin over prior to applying the sill pan.

- O. If using sill nosing with a step down, install the sill pan and sill nosing into the opening. Press down to seal them into the opening. DO NOT overlap.

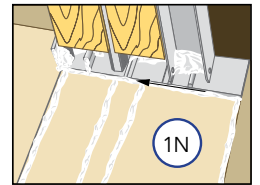

Steps P and Q apply only to aluminum clad wood doors.

- P. Apply sealant at nosing ends continuing from the front of the sill pan around the exterior surface of the wall where the sill nosing will end.
- Q. Cut two pieces of flashing tape 12" longer than the rough opening width. Place tape #1 across the sill nosing just up to where the nosing begins to slope down and extending 6" up each jamb. Apply the second piece of flashing tape over-lapping the first piece and the exterior edge of the sill pan and 6" up each jamb.

Note: Fix any problems before proceeding.

If the flange(s) must be trimmed to fit in a recessed opening, use a utility knife, oscillating tool, or circular saw for vinyl or fiberglass flanges. Use an electric scissor-style shear for aluminum flanges.

- R. Apply Pella SmartFlash tape across the head of the door extending 6" down each jamb.
- S. Place the tape starting on the aluminum cladding and extending onto the wood frame.

- T. Place three 3/8" beads of sealant across the opening sill. Place the interior-most bead 1/2" from where the interior of the door sill will remain after installation. Continue this bead up the sill pan lip, if applicable. Place a second bead beginning from the interior bead 1/2" from each side, out to the exterior of the framing and along the opening. Leave 2" voids 4" from the corner and at the center. Place a third bead where the exterior of the door sill will remain after installation.

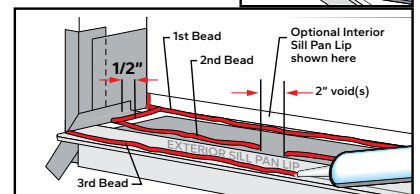
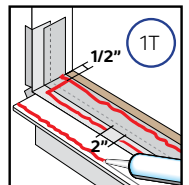



POCKET REPLACEMENT WITH FLUSH FLANGE

FOR THE INSTALLATION OF NEW FLUSH FLANGE DOORS IN EXISTING ALUMINUM FRAMES WITH STUCCO WALLS IN ARID CLIMATES

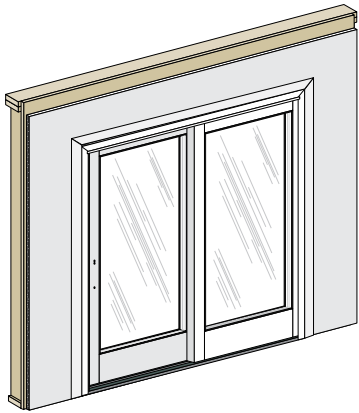

2 SET AND FASTEN THE DOOR

- A. Apply a 3/8" bead of sealant to the back of the flush flange. On 4-sided flush flange doors, leave 1" gaps in the sealant at each end of the door sill.
- B. Center the bottom of the door in the opening and tilt the door into position. Do not slide the door into the opening. Sliding will damage the sealant lines. Check the jambs for plumb and confirm there is room for shimming between the jambs and opening on each side.
- C. Walk across the sill to compress the sealant and confirm the frame is firmly on the opening sill.
- D. Pre-drill and drive two screws one near the bottom of each side of the door through the frame or clip. (See anchor instructions at the end of this booklet for screw or clip spacing.)
- E. Plumb and square the door. Place shims near the top corners, as necessary. Shims must be flat and support the frame to the exterior the full wall depth. On the interior, stop shims 1/2" short to allow for a continuous interior sealant, or seal across shims after trimming flush to the frame.
- F. Drive two fasteners, one near the top corner on each side.
- G. Check the door placement by measuring from the interior surface of the door frame or jamb extension to the interior surface of the wall for consistency.

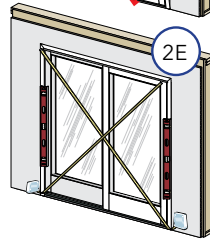
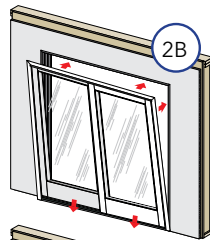

Note: For 250 Series and knock down doors, insert fixed panel. Refer to KD assembly instructions (if applicable). Do not fasten 250 fixed panel until after vent panel is operational.

- H. Anchor the frame. Refer to the anchor page(s). Add additional screws through the frame or attach installation clips as required.

NOTICE Shims are required at each screw location. Refer to the applicable anchor instruction page(s) near the end of this booklet.

- I. Install the sliding panel. From the exterior, tilt the top of the panel and insert it into the top track. Move the bottom of the panel toward the door frame and set it on the bottom track. Be careful not to pinch your fingers between the two panels. DO NOT close the sliding panel until the hardware is installed. The door may lock when closed.
- J. Check door operation. Reserve and Lifestyle Series Doors: Adjust Vent Lock Tip (if applicable). Impervia Doors: If Vent Lock does not lock, loosen screws and adjust strike plate locations and re-tighten screws.

NOTICE Adjust shims to correct any issues with plumb, square, operation or reveal.

- K. Adjust the panel height to 1/4" clearance from bottom of panel to sill track by removing the hole cover (if applicable) and using a #2 Phillips screwdriver to turn the roller adjustment screw clockwise (raise) or counterclockwise (lower).

Note: Reinstall the hole cover (if applicable) once adjustments are complete.

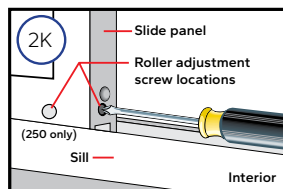

2 SET AND FASTEN THE DOOR CONTINUED

NOTICE Check vent panel to frame and vent panel to fixed panel reveal.

NOTICE For doors with heavy laminate or triple-pane glass use a small pry bar to raise the panel while turning the adjustment screw. This will prevent the threads from being stripped (applies to all methods).

- L. Install the bumpers (if applicable). Refer to the anchor instructions at the end of this booklet.
- M. Install the handles. Refer to the instruction in the hardware box.
- N. Install the strikes/keepers. Refer to the provided instruction or to the anchor page(s) and adjust as required to ensure handle locks and operates correctly.

250 Series Doors: Install the keeper after the sliding panel is confirmed to operate and lock. Then fasten the fixed panel to the door frame.

IMPORTANT Install the vent lock strike plate. Refer to the Secure Vent Lock Strike Plate installation document located in the hardware box.

- O. Install vent panel retainers (if applicable) or reinstall if the vent panel was removed during installation. Refer to the instructions included in the panel retainer hardware package.

WARNING Panel Retainer MUST be installed to reduce risk of serious injury or death from a falling door panel. If panel retainer is lost or damaged, DO NOT INSTALL DOOR. Contact your Local Pella Seller or Pella Customer Service (877) 473-5527 for replacement.

3 SEAL THE DOOR

- A. Install interior sealant. Refer to the interior sealant instructions at the end of this booklet. Use additional sealant around clips to prevent air and water infiltration
- B. Attach sill support or wood blocking. If support was not attached before setting the door and the concrete does not provide support for the exterior of the door sill.
- C. Install exterior sealant around the edge of the flush flange along the top and both sides.

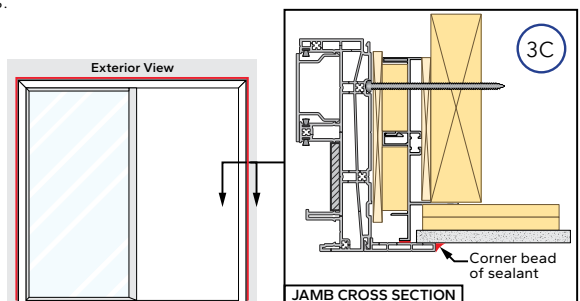
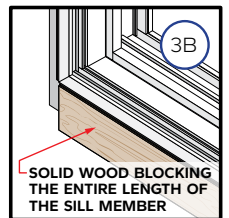



ANCHOR INSTRUCTIONS – FLUSH FLANGE AND ENDURACLAD® EXTERIOR TRIM INSTALLATION METHODS FOR PELLA® RESERVE AND PELLA® LIFESTYLE SERIES SLIDING PATIO DOORS

Note: Standard performance only. Additional anchoring may be required for Performance Upgrade or to comply with local building code requirements.

Location	Anchor Type		Instructions	Drawing	
	Wood	Masonry			
Head	Vent Lock Strike	#10 x 2-1/2" (provided)	Pilot drill using 5/32" bit and drive (1) screw through Vent Lock Strike.	B	
	Fixed Panel Bracket		Pilot drill using 5/32" bit and drive (1) screw through Fixed Panel Bracket.	C	
	Frame Screws	#10 x 2-1/2" PH	Pilot drill using 5/32" bit and drive screws 6" from corner.	C.1	
	Interlocker Frame Screws*		OX or XO and Performance Upgrade or over 95.25" x 95.5" only: Add screws 5" on either side of Vent Lock Strike and Fixed Panel Bracket screws.	C.2	
	Joiner Frame Screws		OXO or OXO only: Pilot drill using 5/32" bit and drive screws at midpoint of joiner (OXO) or through joiner part (OXO) and 5" either side of joiner midpoint.	D	
Installation Clips	(2) #6 x 1-1/4"	3/16" x 1-1/2"	Slide clip into slot from end and adhere to frame with tape 6" from corner.	E	
Jamb	Lock Strike (OX or XO)	#8 x 3" (provided)	3/16" x 3"	Complete per each strike. Pilot drill using 5/32" bit and install (2) installation screws diagonally. Install cover after screws.	E.1
	Lock Strike (OXO or OXO)	#8 x 2-1/2" (provided)	N/A	Install (2) short screws diagonally. Install cover after screws.	C
	Frame Screws	#10 x 2-1/2" PH	1/4" x 2-1/2"	Pilot drill using 5/32" bit and drive screws 6" from corner and 20" on center.	D
	Installation Clips	(2) #6 x 1-1/4"	3/16" x 1-1/2"	Slide clip into slot from end and adhere to frame with tape 6" from corner and 20" on center.	F
Sill	Frame Screws*	#8 x 3" FH or #10 x 2-1/2" FH	1/4" x 2-1/2"	Performance Upgrade or over 95.25" x 95.5" only: Use factory pre-drilled holes (if applicable). Pilot drill with 1/8" bit and apply sealant before driving screws. Not required if Standard Performance OX or XO and 95.25" x 95.5" or under.	

Use corrosion resistant fasteners compatible with construction materials. Shim as required at anchor locations.

For light gauge steel framing, use #10 self-tapping screws with minimum 3 thread embedment. *Additional anchors required for Performance Upgrade or frame sizes exceeding 95.25" x 95.5".

*For Performance Upgrade, install the Performance Upgrade Interlocker. Refer to provided instructions.

Units with Pella EnduraClad exterior trim without fins or pre-punched holes must be anchored with frame screws or installation clips.

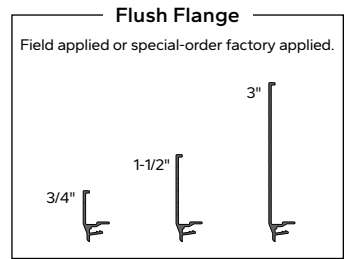
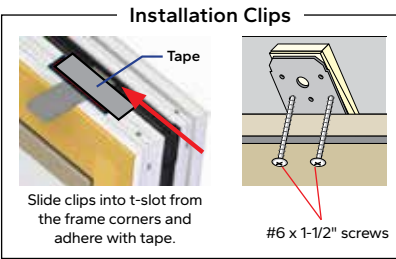
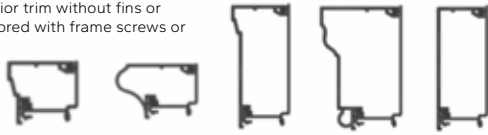

Elevation View

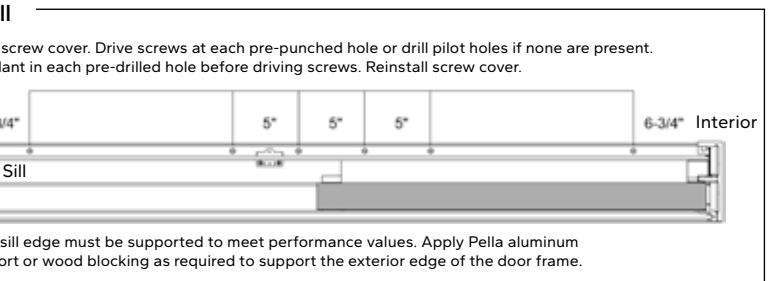
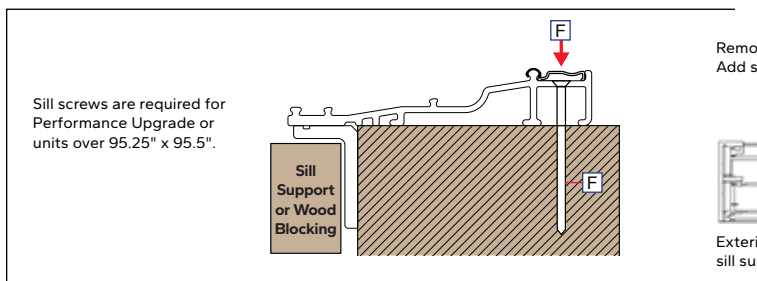
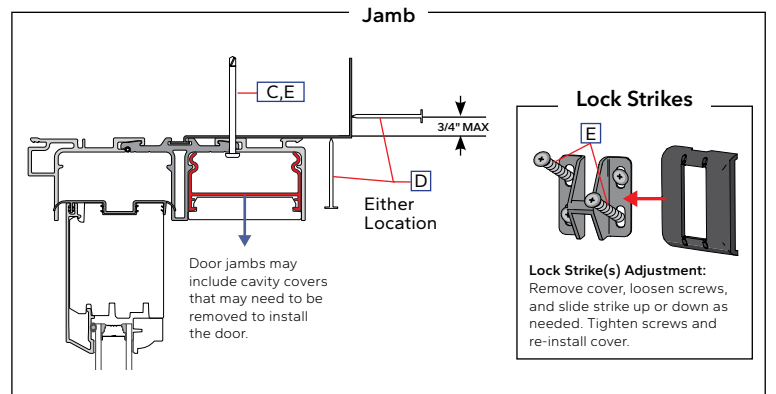
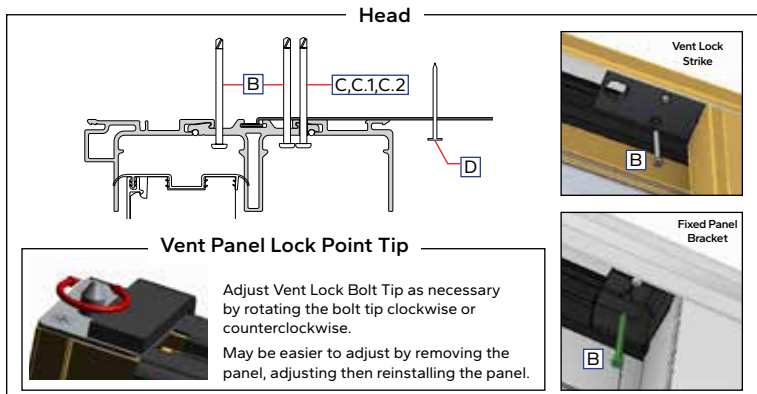
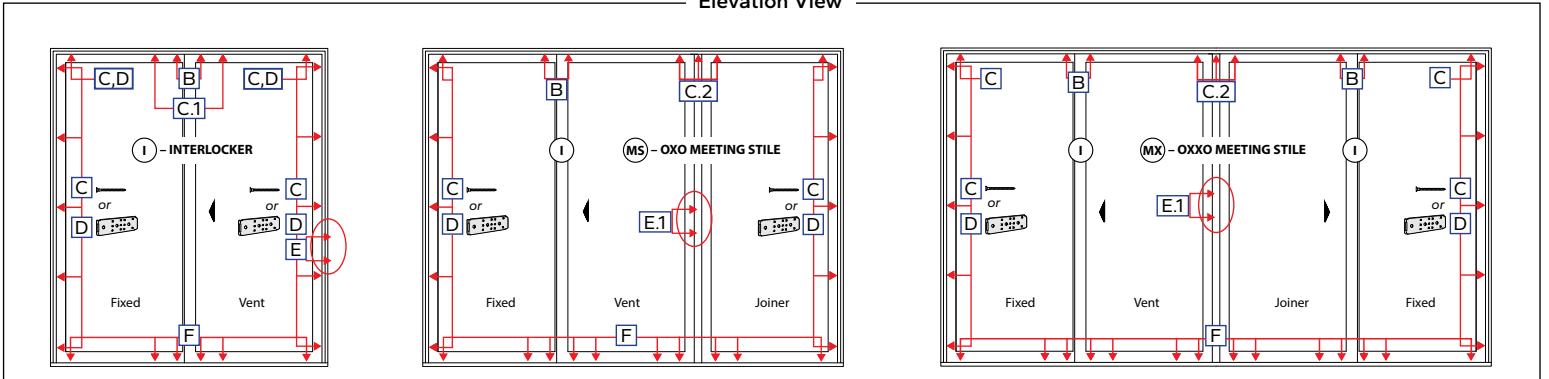



ANCHOR INSTRUCTIONS – FLUSH FLANGE INSTALLATION METHODS FOR ENCOMPASS BY PELLA® AND PELLA® 150 SERIES SLIDING PATIO DOORS

Note: Standard performance only. Additional anchoring may be required for performance upgrade, impact-resistant products or to comply with local building code requirements.

Location		Anchor Type		Instructions	Drawing
		Wood	Masonry		
Head / Jamb / Sill Frame Screws		#10 x 2" Corrosion Resistant (provided)	N/A	Pre-drill through both walls with 5/32" pilot hole. Drill through the first wall only with a 3/8" bit. Then drive screws. Refer to the illustrations for location and spacing. Screws through the sill require sealant and self-sealing washer.	A, B
Head and Sill – Interlockers only		#10 x 2" Corrosion Resistant (provided)	N/A	Pre-drill through both walls with 5/32" pilot hole. Drill through the first wall only with a 3/8" bit. Then drive screws. Refer to the illustrations for location and spacing. Screws through the sill require sealant and self-sealing washer.	A, B
Jamb	Strike / Lock / Keeper	#6 x 1/2" starter screw and 3" screws (provided)	1/4" x 3-1/2" Masonry Screw	Refer to installing the keeper instructions and illustrations below.	C

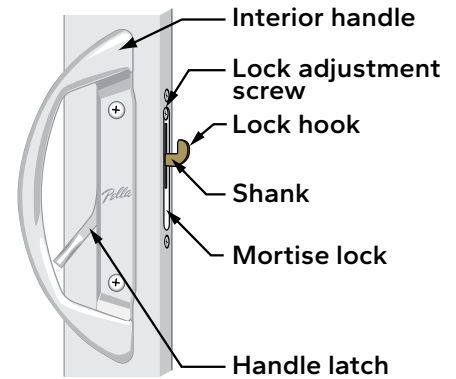
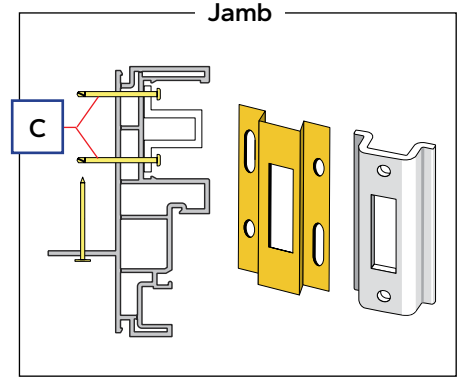
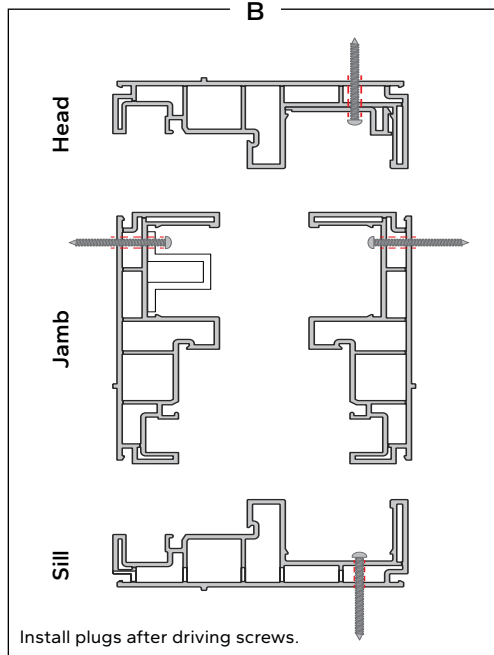
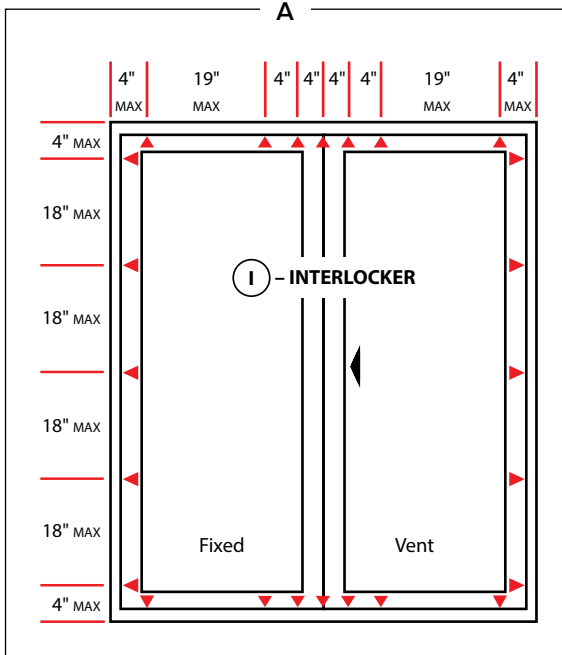

KEEPER INSTALLATION FOR ENCOMPASS BY PELLA® AND PELLA® 150 SERIES:

- Identify the keeper** in the hardware package and perform the keeper attachment steps based on which keeper is in the package. Determine the keeper location by opening the panel a few inches and extending the lock hook. With a pencil, mark the location on the jamb directly across from the top of the shank.
- Place the keeper with 4 screw holes** on the jamb so the top of the slot is aligned with the pencil mark. Attach by inserting a #6 x 1/2" starter screw into one of the slotted keeper holes.
- Place the keeper with 2 screw holes** on the jamb by "snapping" it into the frame jamb at the desired location. The keeper may be moved up or down to align with the pencil mark. The keeper will stay in position until attached with screws.
- Insert a shim** between the frame jamb and the rough opening at the keeper location.
- Adjust the lock hook** by turning the door lock adjustment screw clockwise to loosen or counter-clockwise to tighten until the mortise lock is aligned properly, the door locks easily, and there is less than 1/16" movement when the door is locked.
- Install the keeper** by inserting 3" long screws (provided) through the keeper holes, the shim and into the rough opening frame members. Remove the starter screw from the 4 screw hole keeper and replace it with a 3" long screw.

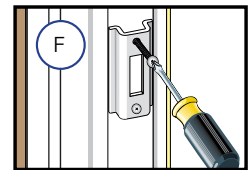
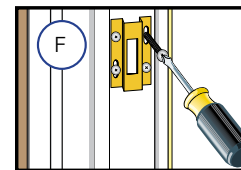
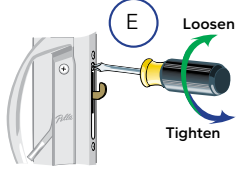
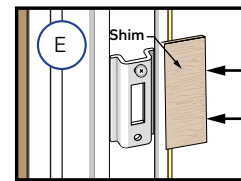
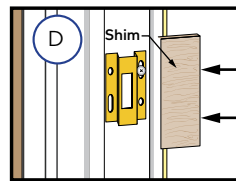
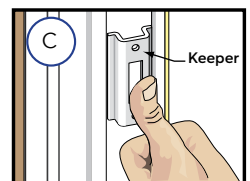
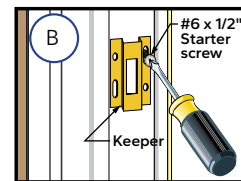
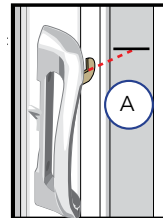



ANCHOR INSTRUCTIONS – FLUSH FLANGE INSTALLATION METHODS FOR PELLA® 250 SERIES SLIDING PATIO DOORS

Note: Standard performance only. Additional anchoring may be required for performance upgrade, impact-resistant products or to comply with local building code requirements.

Location	Anchor Type		Instructions	Drawing
	Wood	Masonry		
Head and Jamb Frame Screws	#10 x 3" Pan Head (provided)	3/16" x 3"	Locate screws 3" from corners and 16" on center. Shim at each screw. Use the score line in the frame as a guide, pilot drill with a 1/8" bit into the opening then drill a 3/8" hole through the first wall only and drive screws. Place caps or plugs (provided) over screw holes (optional).	B
Head Secure Vent Lock Strike			Refer to the provided Secure Vent Lock Strike installation instruction located in the hardware box.	B.1
Jamb	Lock Strike / Keeper (OX, XO, OOX, or XOO)	#10 x 3" (provided)	Refer to provided instructions. Shim between the frame and the opening and drive three screws through the keeper and into the opening.	C
	Astragal / Meeting Stile Keeper (OXO or OXXO)	#8 x 1" Flat Head (provided)	Refer to provided instructions.	C.1
	Fixed Panel Frame Screws		Place screws evenly spaced into the fixed jamb frame leg where the weatherstrip is located.	D
Head /Sill	OOX/XOO Fixed Panel Screws	#8 x 3/4" (provided)	Place screws 1/2" from the edge of the panels at the interlocker ends through the head and sill frame legs where the weatherstrip is located.	E
Sill	Frame Screws (optional)	#10 x 3" Pan Head	Optional to maintain sill embedment into sealant, pre-drill with 1/8" bit, add sealant, and drive screws. Remove roller track, install screws, reinstall track, seat with block and rubber mallet.	F

Use corrosion resistant fasteners compatible with construction materials.

For light gauge steel framing, use #10 self-tapping screws with minimum 3 thread embedment.

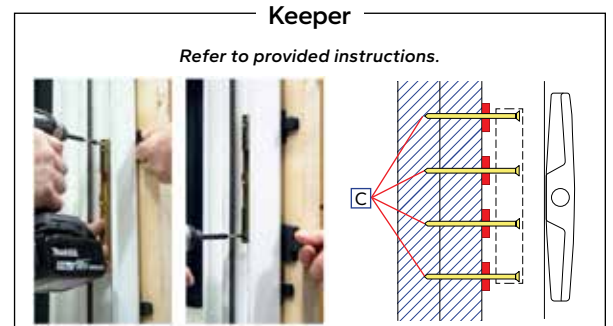
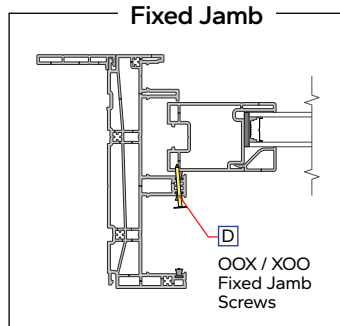
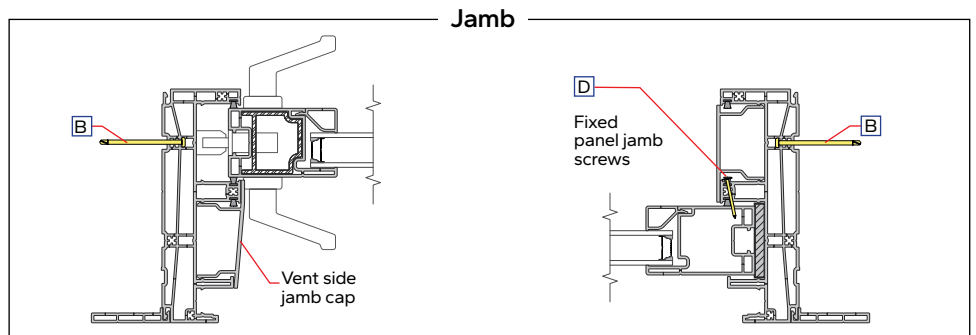
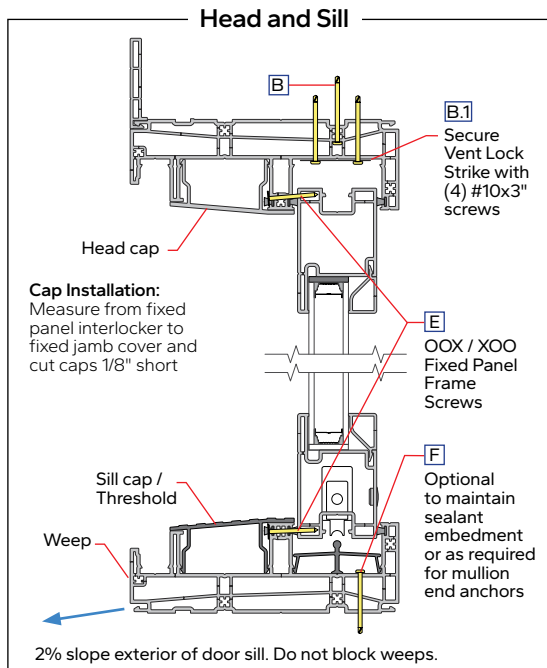
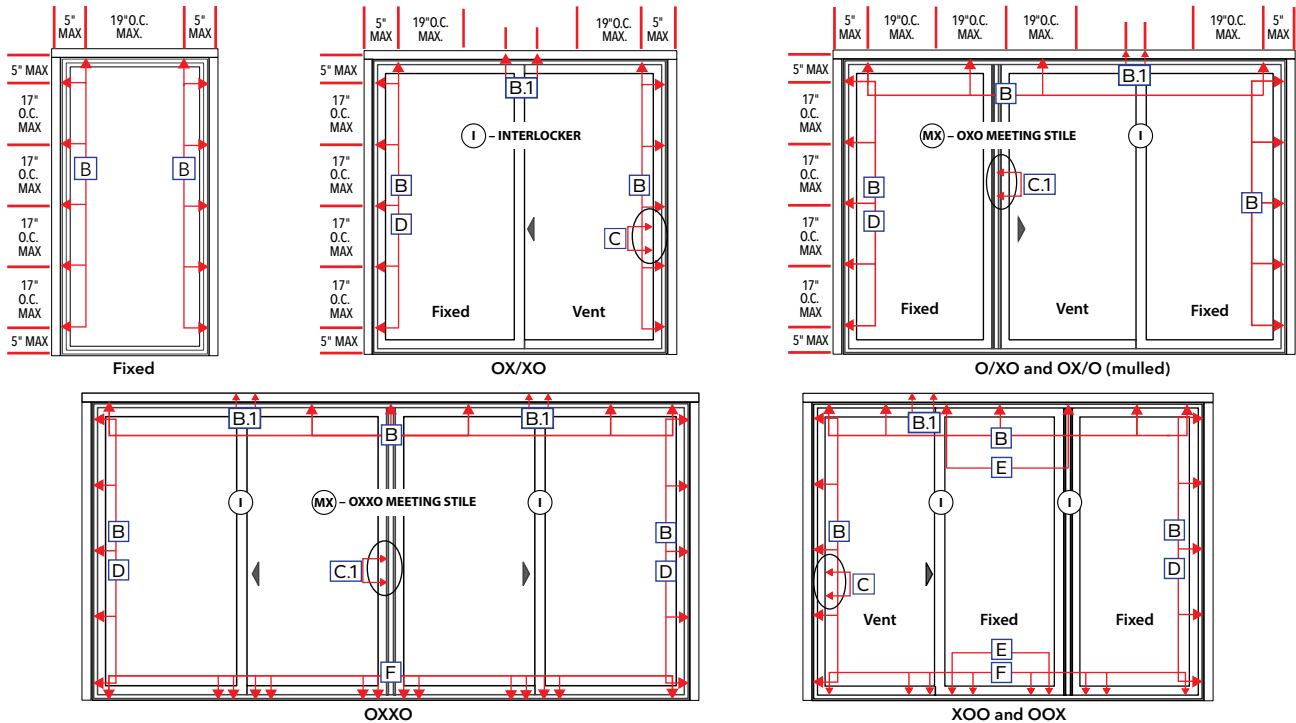



ANCHOR INSTRUCTIONS – FLUSH FLANGE INSTALLATION METHODS FOR PELLA® IMPERVIA SLIDING PATIO DOORS

NOTE: Standard performance only. Additional anchoring may be required for performance upgrade or to comply with local building code requirements.

Location		Anchor Type		Instructions	Drawing
		Wood	Masonry		
Head/ Jamb	Nail Fin*	2",11 Ga. Roofing Nail	N/A	Within 3.5" from each corner and 7" on center (every other pre-punched hole). All PG 35 and PG 50 up to 71.25" x 81.50" frame size.	A
	Nail Fin with Frame Screws	#10 x 3" (provided)	3/16" x 1-3/4" Masonry Screw	Use factory-drilled installation holes if present. Drill holes through both walls and into the rough opening using a 1/8" bit then drill a 3/8" hole through the first wall only.	
	Frame Screws	#10 x 3" (provided)	3/16" x 1-3/4" Masonry Screw	Required to meet PG 50 if >71.25" x frame width or >81.50" frame height.	
	Installation Clips	#8 x 1 1/4"	3/16" x 1 1/2"	Slide clips into slot from frame ends. Adhere clip with tape. Not applicable with nail fin	
Sill	Frame Screws	#8 x 3" (provided)	3/16" x 2 1/2" Masonry Screw	Remove inner sill cover. Use factory-drilled installation holes, pilot with 1/8" bit into rough opening. Apply sealant in each hole before driving screws.	C
	Vent Panel Retainer Support	#8 x 3" (provided)	3/16" x 2 1/2" Masonry Screw	Apply sealant in each hole before driving screws. Reinstall sill cover.	
	Fixed Panel Structural Bracket	#10 x 3" (provided)	3/16" x 2 1/2" Masonry Screw	Remove one factory-installed screw first. Pre-drill 3/16". Pilot with 1/8" bit into rough opening. Apply sealant in each hole before driving screws.	
	Aluminum Support	#8 x 3/4" (provided)	NA	Available separately - consult your local Pella representative.	
Mullions*		#10 x 3"	3/16" x 1-3/4" Masonry Screw	Head: Drill holes through both walls and into the rough opening using a 1/8" bit then drill a 3/8" hole through the first wall only. Add sealant prior to driving screws at the sill.	B
Lock Strike		#8 x 3"	3/16" x 1-3/4" Masonry Screw	Grade 40 Security: Install (4) installation screws per strike. Grade 10 Security: Install (2) installation screws (diagonally) per strike. Pilot all installation screw locations with 1/8" bit into rough opening.	D

*For light gauge steel framing, use #10 self-tapping screws.

***Impact-Resistant products must be installed with frame screws. Fin fastening (if applicable) is optional for flashing purposes. Refer to Florida Product Approval documents (if applicable).

**Anchor through structural mullion end anchors, if present.

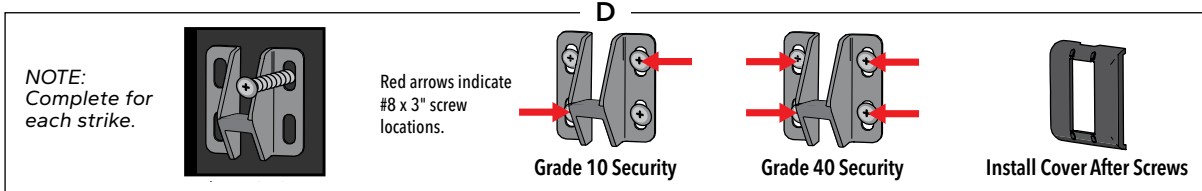
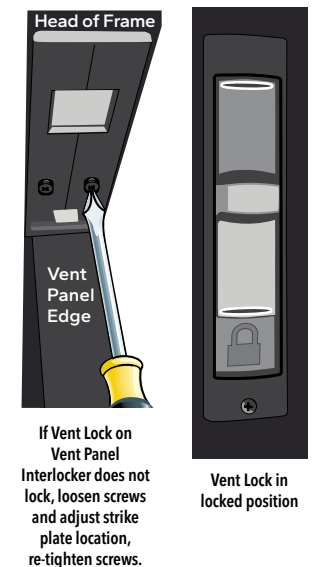
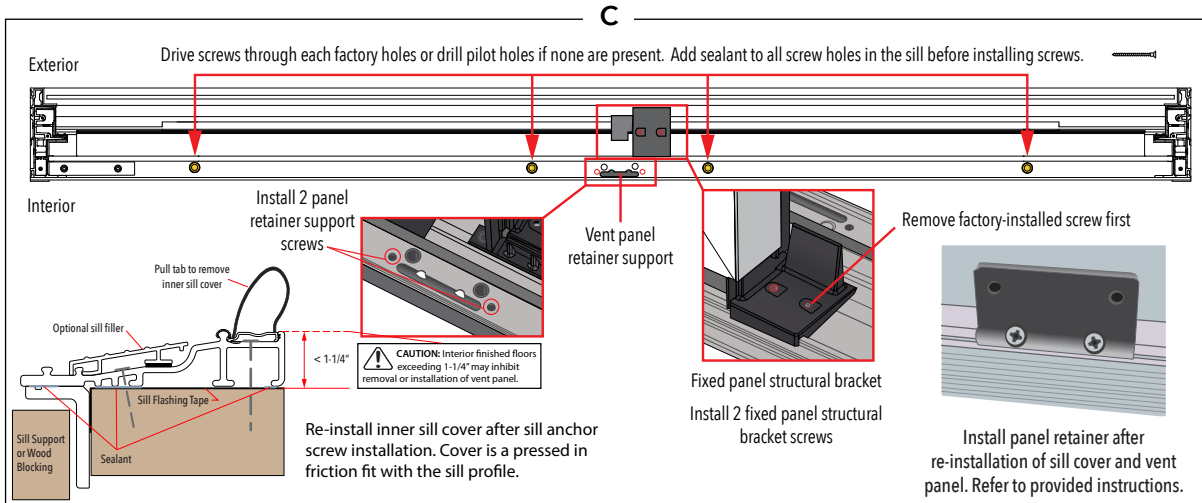
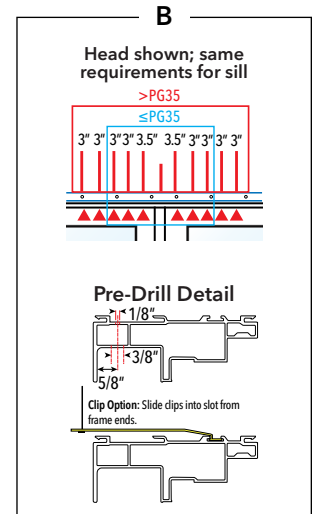
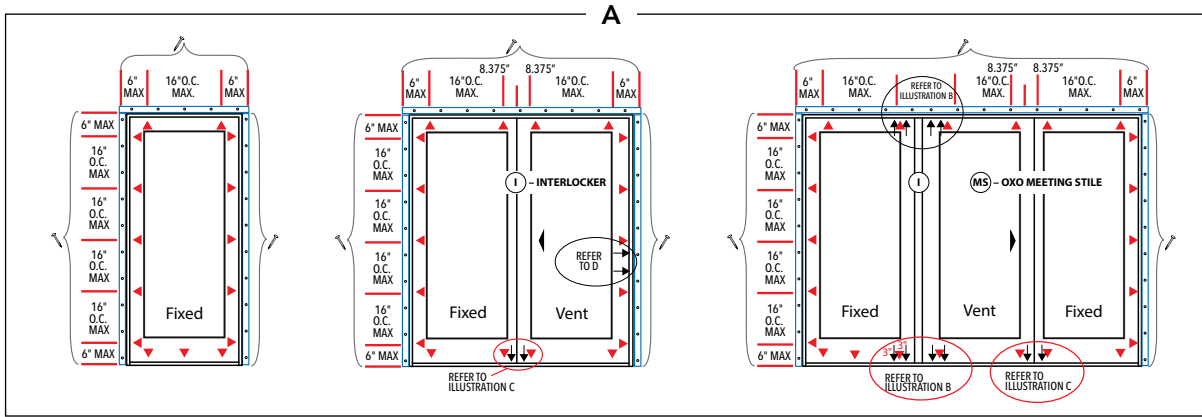



REVERSING DOOR SLIDE FOR SLIDING PATIO DOORS

Note: Doors with Blinds-Between-the-Glass are not reversible.

REVERSING DOOR SLIDE FOR ENCOMPASS BY PELLA® AND PELLA® 150 SERIES:

- A. **Remove the sill and screen tracks from the door.** (Use an Allen wrench or small hook to begin removal.)
 - B. **Rotate the main frame 180°** (so the sill becomes the head). Snap the sill and screen tracks into place at the bottom of the door. Carefully lay the panel on saw horses or a clean surface.
 - C. **Extend the lock hook** and clamp the lock hook with the vise grip.
- Note: Use of the vise grip on the lock hook will prevent the mortise lock from falling when the lock mounting screws are removed.
- D. **Remove the door handle** by removing the two attachment screws.

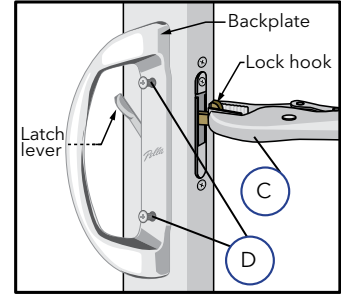

- E. **Remove the mortise lock.** Remove the two screws that attach the lock assembly to the door panel. Work the lock down, then tilt it out and pull up.

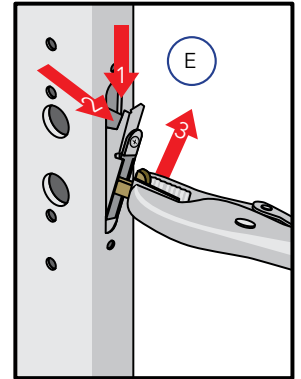
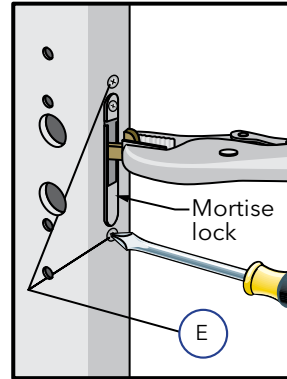

- F. **Rotate 180° and reinstall the lock.** Insert the mortise lock into the door panel with the lock adjusting screw positioned at the bottom, then tilt the top in and lift the lock into position. Insert the two mounting screws into the lock mounting holes.

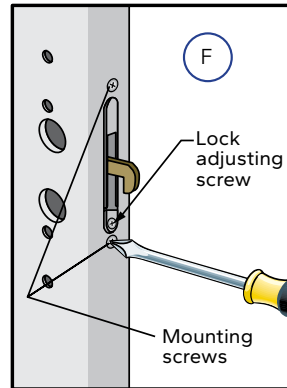

- G. **Rotate the handle 180°** and install the door handle by inserting the two backplate screws through the door panel and into the exterior handle.
- Note: Rotating the handle will result in "Pella" script being upside down. A new handle must be ordered for "Pella" to be in correct orientation.
- Note: The latch lever must engage the slot in the side of the mortise lock assembly.

- H. **Remove the bottom rollers** from the slide panel by removing the upper screw. Reinstall the rollers in the opposite end of the door panel.

- I. **High Performance Doors only:** Remove the blocks from the top rail of the door panel and reinstall them at the opposite end of the panel.
- J. **High Performance Doors only:** Move the frame exterior vent plugs (white foam rods) from the head of the frame to the opposite side of the frame. A soap solution may be needed as a lubricant for re-installing the plugs.

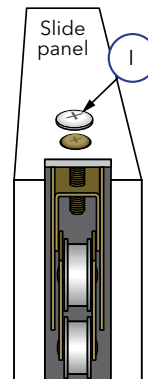



Interior Sealant Instructions



CAUTION Continuous backer rod (as necessary) and a high quality, low-odor interior sealant such as Pella Window and Door Installation Sealant (or equivalent) is recommended for commercial or high performance installations to create the continuous interior seal. Follow the directions on the cartridge. For standard performance or products with factory applied jamb extensions, use low pressure polyurethane insulating foams. Follow the directions on the can. Do not use high pressure or latex foams. Fiberglass batt or similar insulation is not recommended as it can absorb water and does not act as an air seal.

- A. **Insert the nozzle or straw** between the rough opening and door frame from the interior. Use a pliers (if necessary) to compress the end of a straw tube to allow it to fit in tight openings.
- B. **Place a 1" deep bead of foam approximately 1" from the interior of the frame** to allow for expansion. DO NOT fill the entire depth of the rough opening cavity.

Note: Apply foam between the frame and rough opening, NOT between jamb extensions and the rough opening.

- C. **Re-Check door operation** and remove remaining shipping spacers after foam installation. Excess foam may be removed with a serrated knife after it cures.
- D. **To ensure a continuous interior seal**, apply sealant over or around any shims or clips interrupting the foam seal.
- E. **Place a continuous bead of sealant across the inner sill at the intersection of the door sill and subfloor.** Continue the sealant 6" up each jamb.

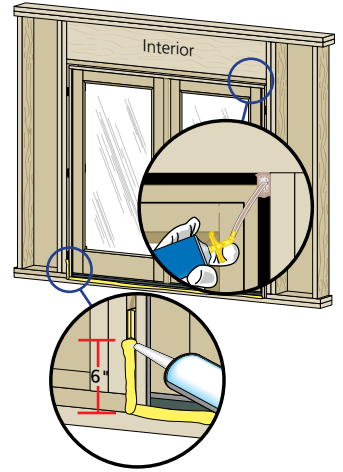

Exterior Sealant Instructions



CAUTION Use a high quality, multi-purpose exterior sealant such as Pella Door and Door Installation Sealant. Follow the directions on the cartridge.

Flush Flange Doors:

- A. **Place a corner bead of sealant** on the edge of the flush flange on the top and sides.

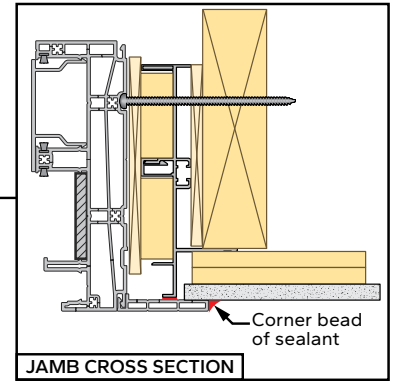
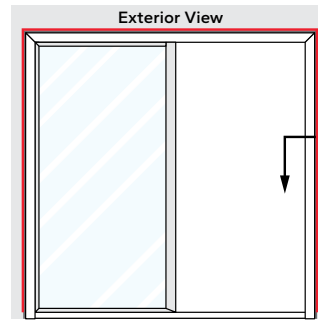

Flush Flange Doors

- B. **For a door without the flush flange at the sill**, install a corner cap at the bottom of each jamb flush flange. Remove the release paper from the adhesive strips on the back of the corner cap, and press the corner cap onto the bottom of the jamb flush flange.

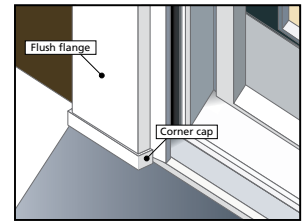
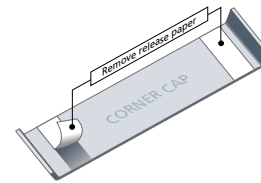

Enduraclad Exterior Trim Doors:

- A. **Insert backer rod 3/8" deep** in the space around the door. Backer rod adds shape and controls the depth of the sealant line.
- B. **Apply a continuous bead of sealant to the entire perimeter of the door.**
- C. **Shape, tool and clean excess sealant.** When finished, the sealant should be the shape of an hourglass.

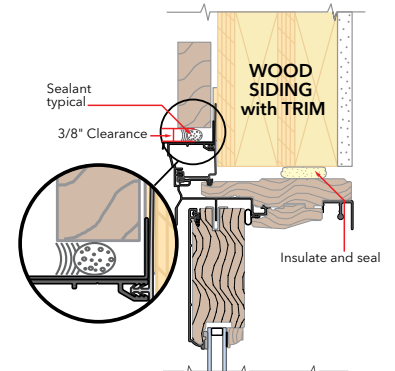
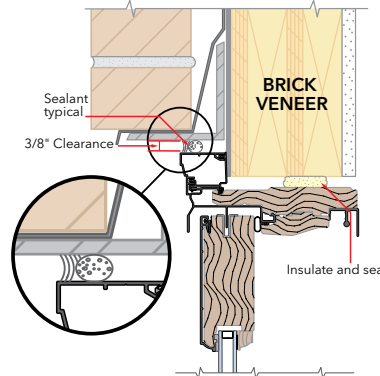



OPTIONAL SILL PAN INSTRUCTIONS

A. **Cut the sill pan** to the width of the rough opening plus 2".

NOTE: The 2" added onto the rough opening width is for a 1" bend on each end.

B. **Make a 1" cut** in each fold at both end of the sill pan.

NOTE: These cuts will allow the edges of the sill pan to be bent.

C. **Cut 1" off each end** of the interior sill pan lip.

D. **Bend each end** of the center panel up.

E. **Install the sill pan** by sliding into place until the exterior sill pan lip is flush with the exterior of the rough opening.

F. **Apply sill flashing tape.** Cut a piece of flashing tape 2" longer than the opening width. Apply at the bottom of the opening, covering the exterior sill pan lip as shown.

NOTE: If applicable, apply spray adhesive to building felt prior to applying the flashing tape.

G. **Cut a piece of flashing tape** to the width of the opening. Install tape to the sill pan and overlap the flashing tape from step 1F by 1". If needed add a second or third piece of flashing tape until the sill pan is covered to the interior sill pan lip.

NOTE: The purpose of this tape is to seal the sill screws when installing the door.

H. **Cut two 9" pieces of flashing tape** with a 1" x 3" tab at the bottom, on opposite corners as shown.

I. **Apply the tabbed 9" pieces of flashing tape.** The tape is applied so 2" will cover the inside of the rough opening and lap over the side flange of the sill pan. The 1" x 3" tab laps over the bottom flashing tape as shown.

J. **Cut two 6" pieces of flashing tape** and apply to each side of the rough opening, overlapping the first piece by 1" and lapping the bottom over the side flange of the sill pan as shown.

K. **Cut two pieces of flashing tape 1-1/2" x 6"** and apply to the bottom corners of the opening by beginning in the corner of the sill pan, with 3/4" of the tape applied to the sill pan and 3/4" of the tape applied to the side flange. The remainder of the tape is to be at a 45 degree angle onto the exterior.

L. **Attach the aluminum sill support** or wood blocking to the exterior of the box plate to support the edge of the door sill. Place the sill support flush with the subfloor.

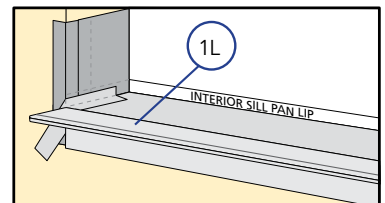
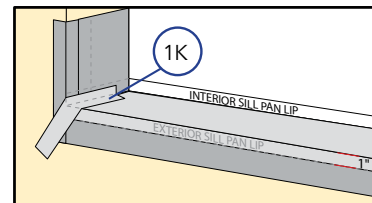
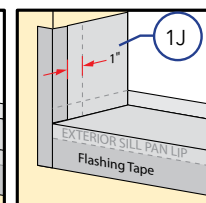
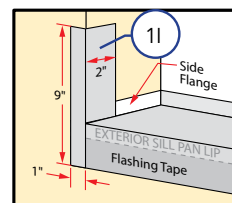
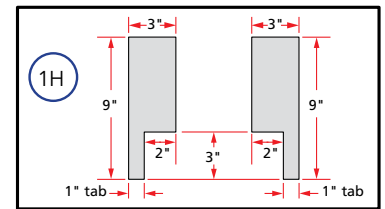
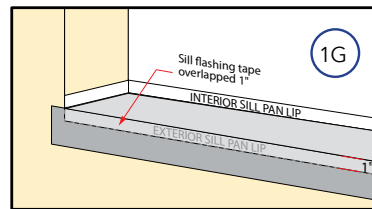
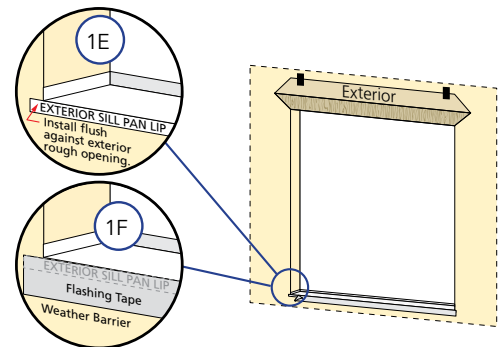
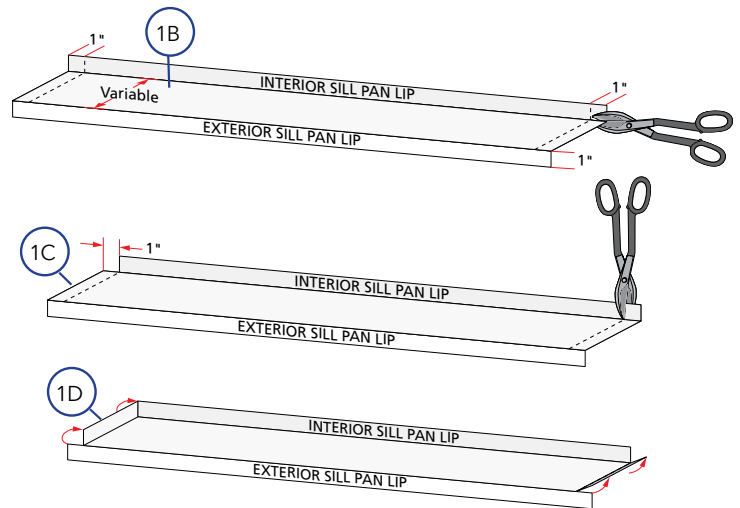

Concrete Slab (without sill pan) Instructions

NOTE: Thoroughly clean the slab where sealants will be installed. Instead of installing flashing tape across the bottom of the rough opening, complete the following:

A. **Install flashing tape** at the bottom 6" of the rough opening jambs.

B. **Cut (2) 9" pieces of flashing tape** as shown in step 1H above.

C. **Install them overlapping** the flashing tape installed in step A by 1".

D. **Place a 3/8" bead of sealant** where the bottom edge of the flashing tape meet the concrete slab.

E. **When folding building wrap in at the jambs**, cut at a 30 degree angle as illustrated.

Follow the applicable installation method pages to complete the installation except seal the door sill directly to the slab.

