



Pella® Lifestyle Series Double-Hung Hidden Screen QUICK START GUIDE

All steps performed from interior.



- 1** Unlock the window; raise lower sash 3-4".

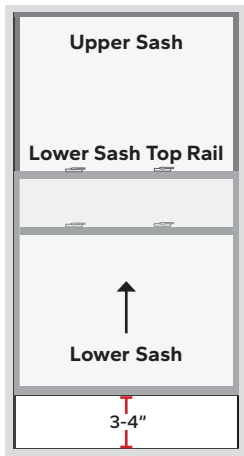

- 2** Tilt lower sash to interior. Clean lower sash bottom rail exterior metal.

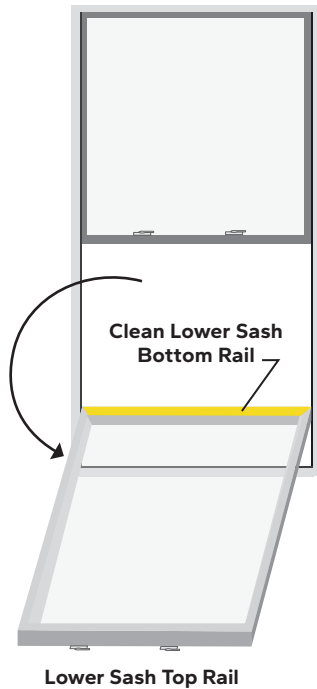

- 3** Dry fit the strike (without removing the adhesive backing paper) centered on the exterior metal surface of the bottom rail.

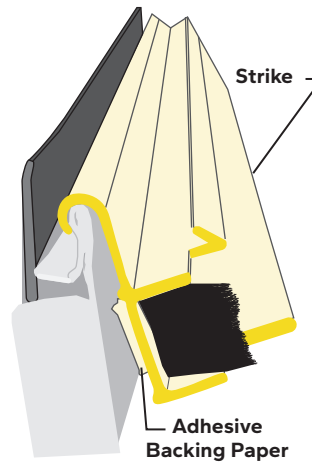

Sash shown out of frame for demonstration purposes.

- 4** Remove adhesive backing paper. Attach screen strike to lower sash bottom rail. Firmly apply pressure to secure.

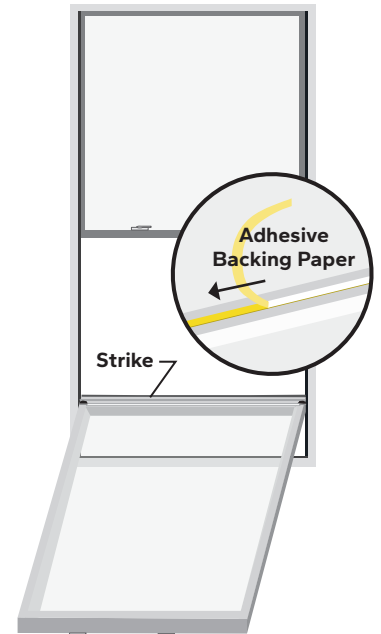

- 5** Tilt lower sash to upright and raise lower sash to fully open position.

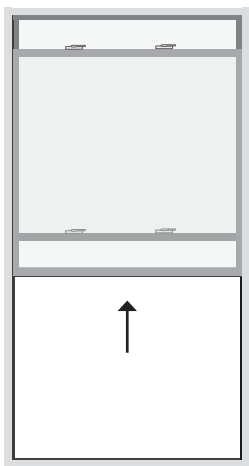

- 6** From interior, pass screen thru to exterior. Align black corner tabs in exterior jamb liner grooves.

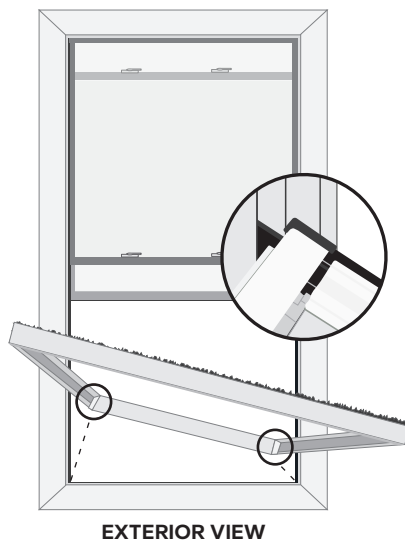

- 7** Push both ends of screen to bottom of jamb liner. Tilt screen up and snap into position.

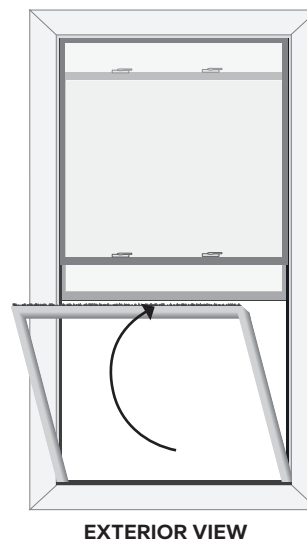

- 8** Close sash to activate screen with a "click." Raise sash to confirm screen operation.

