

Field Joining Mullion Assembly of Aluminum-Clad Transom Window to Sliding Patio Doors

IMPORTANT Determining and meeting the structural load requirements and design of the rough opening is the responsibility of the architect, engineer, and/or contractor. Windows, doors, and/or mullions are not designed to support additional elements or components of the building wall system. Refer to published technical recommendations for window and door combinations or your local distributor for more information. For applicable warranty and arbitration information, please refer to the product website. Field combinations not in accordance with the following parameters and/or the technical recommendations will void warranty.

Parameters:

- Standard tight/direct joining mull span limitation for two-way mulls is 8 feet
- Three-way door transom may require horizontal reinforcement or transom frame anchored through frame to opening header structure to carry the weight of the transom windows
- Openings exceeding 10 ft are recommended to utilize 1/2" perimeter rough opening installation clearances

WARNING Window and Door combinations can be extremely heavy. Installation will require (2) or more persons for safety reasons. Remember to use personal protective equipment. Read the entire instruction before proceeding

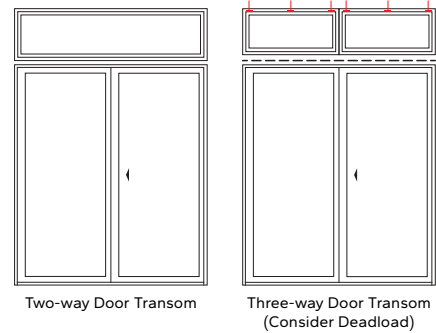

You Will Need to Supply:

- Cedar or impervious shims/spacers
- Foil backed butyl window and door flashing tape or equivalent
- High quality exterior grade polyurethane or silicone sealant
- Interior mullion cover tape (0.5" wide x 0.062" thick)
- #8 x 1" screws

Tools Required:

- Tape measure
- Utility knife
- Hammer or rubber mallet
- Wood block
- Hacksaw
- Pliers

Mullion Covers:

- Standard (direct) Exterior Mull Cover #7217
- Interior Wood Mull Cover #260A

1 Removing the Installation Fin:

- A. Remove the flexible fin corners from the joining sides of the products to be mullied together.

Note: You will remove two fin corners per product.

- B. Place the flat end of a pry bar against the front edge of the fin. Strike the pry bar with a hammer and pry up.

Note: Remove only the fin from the surfaces to be mullied.

- C. Grasp the end of the fin with pliers or vise grips and pull up on the end of the fin. Continue pulling up along the full length of the fin until it is completely removed from the product.

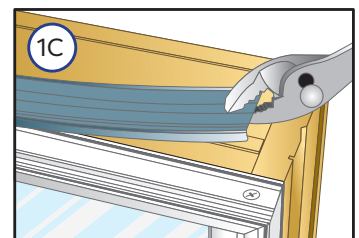
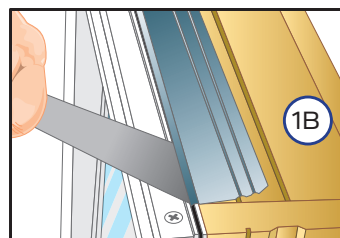
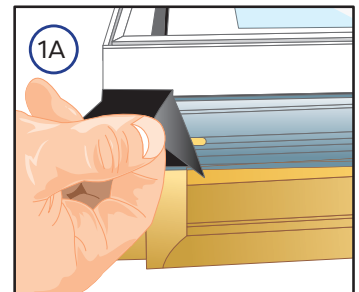

2 Mulling the Products Together:

- A. Place the products, exterior (clad) side up on a clean flat surface.
- B. On the window transom, place a 3/8" bead of sealant from end to end. Place a 2nd bead of sealant 9/16" from the interior running bead from end to end.

Note: Placing shims or wedges under the outer edges of the products will help bring the mullion grooves together.

- C. Align the two products and squeeze or clamp tightly together.
- D. Measure the frame dimension of the surface to be mullied when using lineal mullion covers. Using a hacksaw, cut the Mullion covers 3/8" shorter than the frame dimension.
- E. Insert the end of the exterior mullion cover into the accessory groove of both products. Drive the mullion cover into position with a rubber mallet or a rounded block of wood and a hammer.

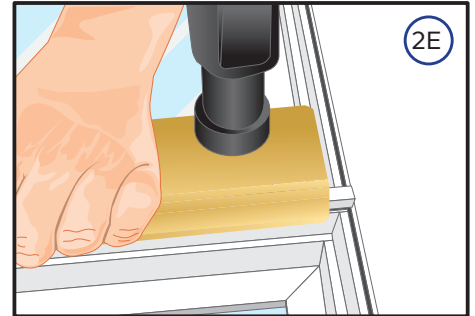
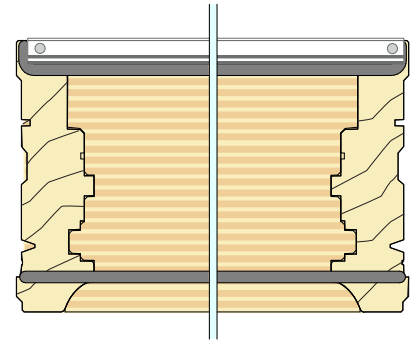

3 Joining the Nail Fins:

- A. Fold out the installation fins of the transom and the sliding patio door to at least 90 degrees.
- B. Cut two 6" long pieces of flashing tape. Remove the paper backing and apply the flashing tape over the gaps between the fins on both sides of the combination assembly.

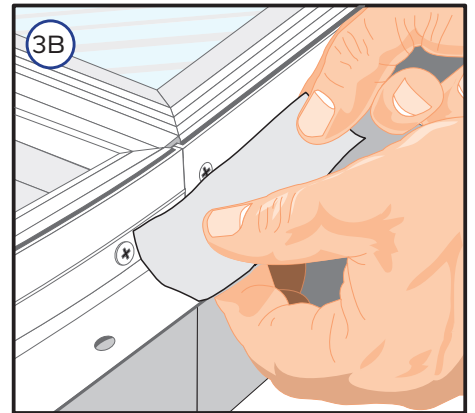

4 Interior Mullion Fastening:

- A. Turn the products over carefully, making sure they stay together.
- B. Drill 5/32" pilot holes above the vent panel at the frame groove line indicated for each screw hole location. Drill through the fiberglass and aluminum. DO NOT drill into the transom wood. Move the vent panel as needed to drill all the holes through each side of the door frame head.

Note: Vent and Fixed panels will not be installed yet.

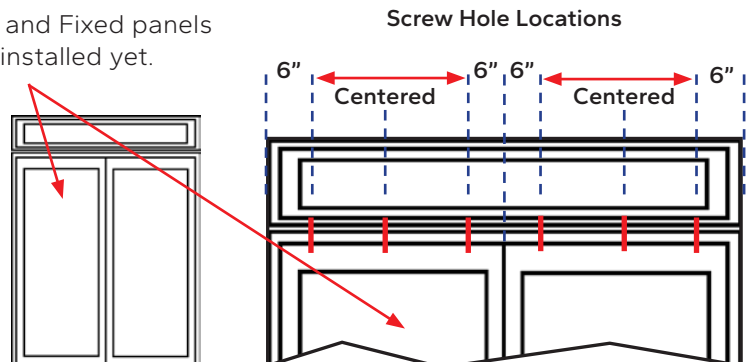
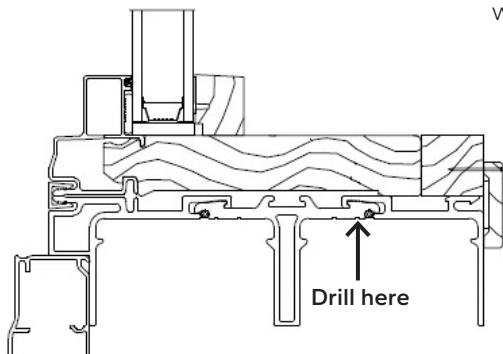

4 Interior Mullion Fastening (continued):

- C. Install the #8 x 1" screws on the interior beginning 6" from each end. Install additional screws 6" on each side of the interlocker and one aligned with the center of each panel. Move the vent panel as needed to install all the screws.

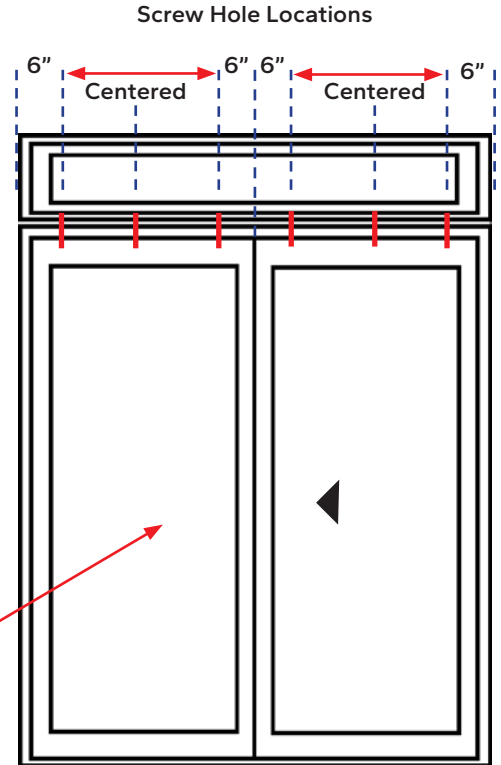
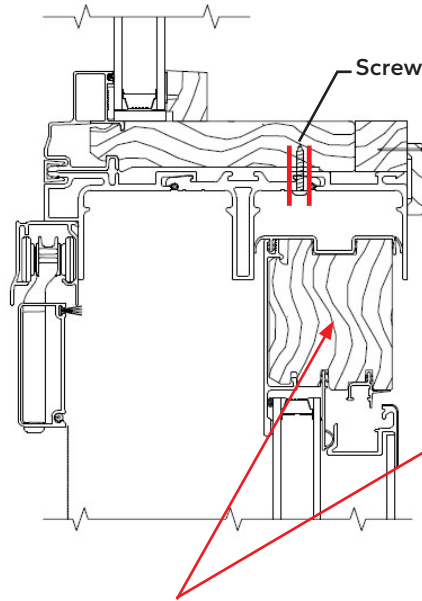
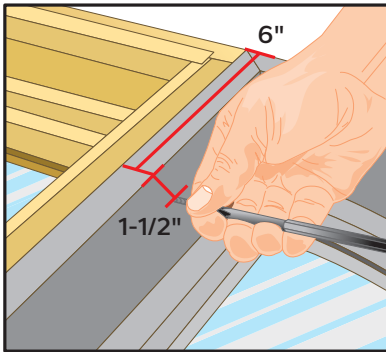

Note: Vent and Fixed panels will not be installed yet.

5 Combination Installation:

- A. Install the combination as described in the installation instructions.
- B. Trim and install interior mull covers and any jamb extensions after application of other interior trim materials.