



CAUTION: Many doors in older homes are painted with lead-based paint. Removal of old doors may disturb this paint. Proper precautions must be taken to minimize exposure to dust and debris. Consult state or local authorities and/or go to www.epa.gov/lead for more information.

WARNING: To ensure safety and security and help prevent property damage, including possible damage to your window or door, close and lock windows and doors any time they are not being used for venting on a nice day, and particularly during high winds or rain.

IMPORTANT NOTICE

Because all construction must anticipate some water infiltration, it is important that the wall system be designed and constructed to properly manage moisture. Pella Corporation is not responsible for claims or damages caused by anticipated and unanticipated water infiltration; deficiencies in building design, construction and maintenance; failure to install Pella products in accordance with Pella's installation instructions; or the use of Pella products in wall systems which do not allow for proper management of moisture within the wall systems. The determination of the suitability of all building components, including the use of Pella products, as well as the design and installation of flashing and sealing systems are the responsibility of the Buyer or User, the architect, contractor, installer, or other construction professional and are not the responsibility of Pella.

Pella products should not be used in barrier wall systems which do not allow for proper management of moisture within the wall systems, such as barrier Exterior Insulation and Finish Systems (EIFS) (also known as synthetic stucco) or other non-water managed systems. Except in the states of California, New Mexico, Arizona, Nevada, Utah and Colorado, Pella makes no warranty of any kind on and assumes no responsibility for Pella windows and doors installed in barrier wall systems. In the states listed above, the installation of Pella Products in barrier wall or similar systems must be in accordance with Pella's installation instructions. Product modifications that are not approved by Pella Corporation will void the warranty.

Care and Maintenance

Care and maintenance information is available by contacting your local Pella retailer. This information is also available at www.pella.com.

Cleaning Instructions

GLASS—Remove any protective film and labels and clean the glass, using a soft, clean, grit-free cloth and mild soap or detergent. Be sure to remove all liquid by wiping dry or use a clean squeegee.

FACTORY FINISHED PRODUCT: Pella Product that has been prefinished with stain or paint from the factory requires no additional finishing. Clean the surface with mild soap and water.

PELLA® ALUMINUM CLAD OR IMPERVIA FRAMES: The interior and exterior frame and panels are protected with a tough factory finish. Clean this surface with mild soap and water. Stubborn stains and deposits may be removed with mineral spirits. DO NOT use abrasives. DO NOT scrape or use tools that might damage the surface.

ENCOMPASS BY PELLA®, PELLA 250® SERIES AND PELLA® 150 SERIES DOOR FRAMES: The vinyl frame may be cleaned using the same method as the glass. For stubborn dirt, a "non-abrasive" cleaner such as Bon-Ami® or Soft Scrub® may be used. Do not use solvents such as mineral spirits, toluene, xylene, naphtha or muriatic acid as they can dull the finish, soften the vinyl and/or cause failure of the insulated unit seal. Do not use Isopropyl Alcohol on laminated surfaces as it will damage the finish. Keep door tracks clear of dirt and debris. Keep weep holes open and clear of obstructions.

DO NOT use abrasives. DO NOT scrape or use



PREPARING FOR SLIDING DOOR INSTALLATION WITH FLUSH FLANGE OR ENDURACLAD EXTERIOR TRIM FOR REPLACEMENT

YOU WILL NEED TO SUPPLY:

- Moisture resistant shims/spacers (12 to 20)
- 2" galvanized roofing nails (1/4 lb.)
- #10 x 3-1/2" corrosion resistant wood screws (Performance Upgrade & Impact-Resistant)
- Masonry screws for concrete applications (Minimum of 3/16" diameter x 3")
- Closed cell foam backer rod/sealant backer (21 to 30 ft.)
- Pella® SmartFlash™ foil backed butyl window and door flashing tape or equivalent
- Pella Window and Door Installation Sealant or equivalent high quality, multi-purpose sealant.
- Low Expansion, low pressure polyurethane insulating window and door foam sealant. DO NOT use high pressure or latex foams
- Sill pan (optional) 6-5/8" x (Rough Opening Width +2)
- Pella aluminum sill support or wood blocking
- Interior trim and/or jamb extensions (15 to 40 ft.)

INSTALLATION CLIP OPTION:

- 6" or 8" installation clips
- #6 x 5/8" corrosion resistant flat head wood screws
- #8 x 1-1/2" corrosion resistant screws or 3/16" x 1-1/2" masonry screws

TOOLS REQUIRED:

- Tape measure
- Level
- Square
- Hammer
- Stapler
- Sealant Gun
- Scissors or utility knife
- Tin Snips
- Screwdrivers (#2 Phillips with 8" shaft and small flat blade)
- Drill
- Drill Bits 13/64" and 1/8" and masonry bit for concrete applications

INSTALLATION WILL REQUIRE (2) OR MORE PERSONS FOR SAFETY REASONS.

Store doors in upright position, out of direct sunlight.

ROUGH OPENING VERIFICATION

A. Confirm the opening is plumb and level.

NOTE: It is critical the bottom is level and it does not slope to the interior or exterior.

B. Remove dirt, oil or debris from the opening and surrounding wall surfaces.



POCKET REPLACEMENT WITH FLUSH FLANGE

FOR THE INSTALLATION OF NEW FLUSH FLANGE DOORS IN EXISTING ALUMINUM FRAMES WITH STUCCO WALLS IN ARID CLIMATES

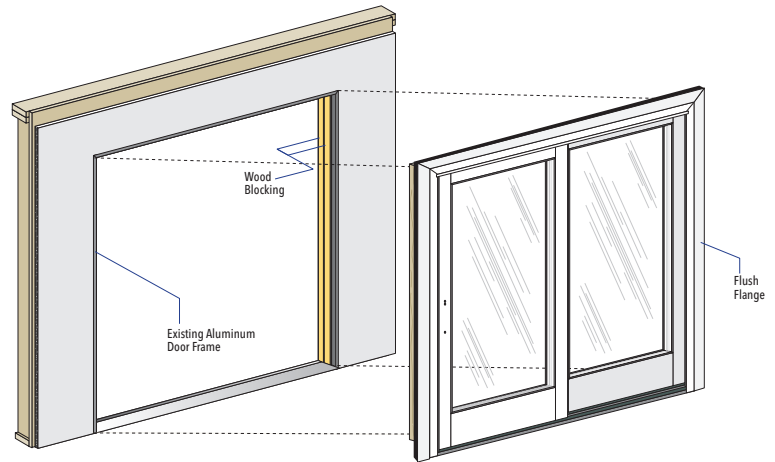
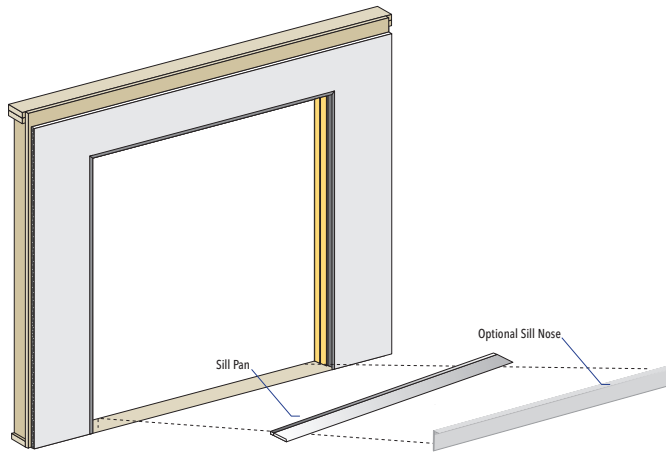

1 PREPARE THE OPENING

- A. Measure the width and height of the opening in the remaining aluminum frame after sash/glass removal. The new door must be 1/2" to 3/4" smaller in width and height.
- B. Remove the sash and/or glass from the existing aluminum door. It may be necessary to cut the divider between the venting panel and fixed glass areas with a reciprocating saw. Refer to the sash removal instructions at the beginning of this booklet.
- C. Cut the existing door sill out of the opening as close to the jamb as possible using a reciprocating saw or side grinder.
- D. Clean the existing frame and sill so it is free of dirt and debris.
- E. Remove the door lock strike from the lock jamb of the existing door frame.
- F. Place a bead of sealant at each joint where the existing door frame jams meet the existing door sill pieces. Fill any holes in the jamb and head with sealant.
- G. If the weep holes of the existing sill have been cut away, drill new weep holes in the existing door jambs. Be sure to drill weep holes in all vertical jamb legs, except the most interior leg.

NOTE: Ensure all new or existing weep holes are open before proceeding with the installation.

- H. Cut one piece of flashing tape 6" longer than the existing aluminum frame width.
- I. Cut wood blocking to fill the channels in the head and jambs of the existing door frame. The blocking will support new shims and hinge screws. The blocking should be flush with the protruding legs of the frame.
- J. Set the blocking in 3/16" sealant lines and secure with #8 x 2-1/2" screws.
- K. Construct a sill pan for the door. Measure the rough opening width and add 2". Measure 1" up from each end and cut through the vertical leg of the pan material. If there is a step down at the exterior of the door opening, make the sill pan depth equal to the door frame depth - 2-1/8". If there is NO step down, make the sill pan depth equal to the frame depth. Bend the bottom (side) flaps of the pan material up, then bend the back leg around the end of the pan.

Dry fit the sill pan and the door into



POCKET REPLACEMENT WITH FLUSH FLANGE

FOR THE INSTALLATION OF NEW FLUSH FLANGE DOORS IN EXISTING ALUMINUM FRAMES WITH STUCCO WALLS IN ARID CLIMATES

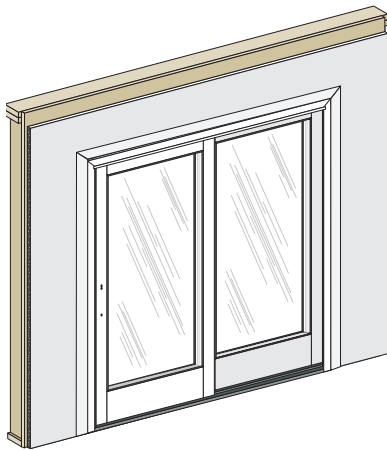

2 SET AND FASTEN THE DOOR

- A. Apply a 3/8" bead of sealant to the back of the flush flange. On 4-sided flush flange doors, leave 1" gaps in the sealant at each end of the door sill.

- B. Center the bottom of the door in the opening and tilt the door into position. Do not slide the door into the opening. Sliding will damage the sealant lines.

Check the jambs for plumb and confirm there is room for shimming between the jambs and opening on each side.

- C. Plumb and square the door. Place shims at the lock strike. Keep shims 1/2" short of door frame depth. Insert additional shims starting 6" from the bottom as needed to keep jambs straight and plumb.

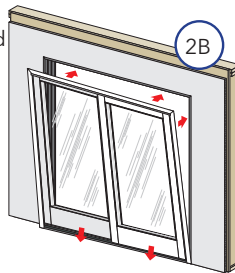

NOTE: Additional shims are required at screw locations for advanced performance, impact-resistant units and combinations and combinations. See the nail fin anchor instructions at the end of this booklet.

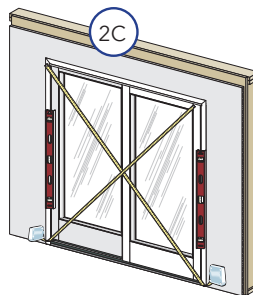

- D. Check the door placement by measuring from the interior surface of the door frame or jamb extension to the interior surface of the wall for consistency.
- E. Drive screw(s) into the keeper strike on the vent side of 2 panel doors. Refer to the anchoring instructions at the end of this booklet.
- F. Drive additional anchor screws through the frame. Shim as required at each location. Refer to anchoring instructions at the end of this booklet.
- G. Install the sliding panel. From the exterior, tilt the top of the panel and insert it into the top track. Move the bottom of the panel toward the door frame and set it on the bottom track. Be careful not to pinch your fingers between the two panels. DO NOT close the sliding panel until the hardware is installed. The door may lock when closed.
- H. Check door operation.

NOTE: Adjust shims to correct any issues with plumb, square, operation or reveal.

2 SET AND FASTEN THE DOOR (CONTINUED)

- I. Install panel



**ANCHOR INSTRUCTIONS - FLUSH FLANGE AND ENDURA CLAD EXTERIOR TRIM FOR REPLACEMENT
INSTALLATION METHODS FOR CLAD EXTERIOR ARCHITECT SERIES® RESERVE, ARCHITECT SERIES®,
AND PELLA® LIFESTYLE SERIES SLIDING PATIO DOORS (INCLUDING IMPACT-RESISTANT)**

Pella® Impact-Resistant Products have been tested in accordance with the large missile impact testing requirements of ASTM E 1886 and ASTM E 1996. Pella Impact-Resistant Products are neither hurricane proof nor are they shatter proof. Severe wind and rain may produce temporary conditions which exceed product performance standards. When these units are subjected to intense storms or extreme conditions, which exceed the intended design pressures, air, water and flying debris infiltration may occur. Advanced performance and Impact-Resistant require the use of installation clips or screws through the frame. The use of fins or brickmould is optional and will not affect anchorage requirements. Local building codes may have additional anchoring requirements.

Units with Pella Enduraclad exterior trim with narrow fins and NO pre-punched holes must be anchored using frame screws or installation clips.

An "X" in the chart below indicates the fastener (row) to be used, under a specific installation method column. All fasteners marked with an "X" in an installation method column are necessary to meet documented performance values.

| FASTENER LETTER ALPHA CHARACTER | INSTALLATION METHOD | | | OPENING SUBSTRATE TYPE | | ILLUSTRATION |
|------------------------------------|---------------------|----------------------|---------------|------------------------|------------------------------|--------------|
| | Nail Fin & Screws | Screws Through Frame | Clip & Screws | Wood | Masonry | |
| A | X* | | | 2" 11 Ga. Roof Nail | | I, II, IV |
| B | X* | X | X | #8 x 2-1/2" | 3/16" x 2-1/2" Masonry Screw | VI, VII |
| C | | X | | #10 x 3-1/2" | 1/4" x 3-1/2" Masonry Screw | V |
| D | X* | X | X | #8 x 3" | 3/16" x 3" Masonry Screw | I, II, VII |
| E | | | X | #6 x 1-1/4" ** | 3/16" x 1-1/4" Masonry Screw | III, V |

* Impact-Resistant products **must** be installed with either Screw Through Frame or Clip & Screw method, but may also have nail fins.

** For light gauge steel framing, use #10 self-tapping screws.



ANCHOR INSTRUCTIONS - FLUSH FLANGE AND ENDURA CLAD EXTERIOR TRIM FOR REPLACEMENT INSTALLATION METHODS FOR CLAD EXTERIOR ARCHITECT SERIES® RESERVE, ARCHITECT SERIES®, AND PELLA® LIFESTYLE SERIES SLIDING PATIO DOORS (INCLUDING IMPACT-RESISTANT)

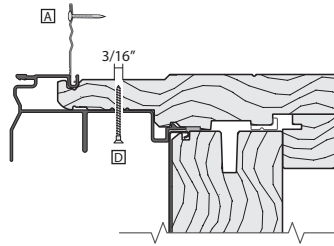

Head, 1-Panel, 2-Panel

Illustration I

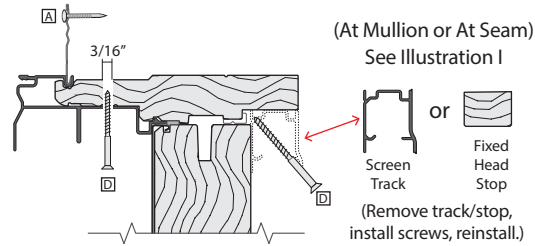

Head, 3-Panel, 4-Panel

Illustration II

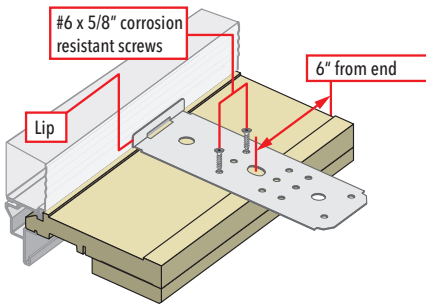

Clip and Screw Installation Method

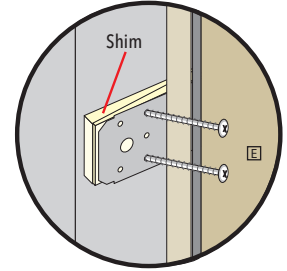
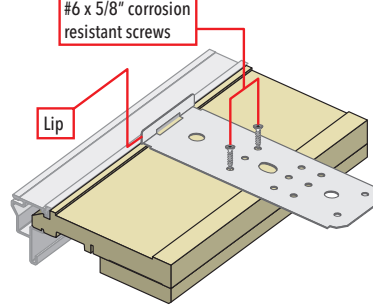

Jamb Clips

Illustration III

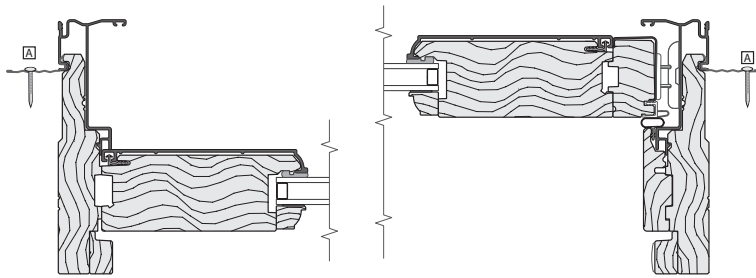

Nail Fin, Jamb

<



ANCHOR INSTRUCTIONS - FLUSH FLANGE INSTALLATION METHODS FOR ENCOMPASS BY PELLA®, PELLA® 250 SERIES AND PELLA® 150 SERIES SLIDING PATIO DOORS

Note: Standard performance only. Additional anchoring may be required for performance upgrade, impact-resistant products or to comply with local building code requirements.

| Product | Location | | Anchor Type | | Instructions | Illustration |
|--|---|------------------------|--|------------------------------|---|--------------|
| | | | Wood | Masonry | | |
| Pella® 150 Series and Encompass by Pella | Head / Jamb / Sill Frame Screws | | #10 x 2" Corrosion Resistant (provided) | N/A | Pre-drill through both walls with 5/32" pilot hole. Drill through the first wall only with a 3/8" bit. Then drive screws. Refer to the illustrations for location and spacing. Screws through the sill require sealant and self-sealing washer. | A, B |
| | Head and Sill - Interlockers only | | #10 x 2" Corrosion Resistant (provided) | N/A | Pre-drill through both walls with 5/32" pilot hole. Drill through the first wall only with a 3/8" bit. Then drive screws. Refer to the illustrations for location and spacing. Screws through the sill require sealant and self-sealing washer. | A, B |
| | Jamb | Strike / Lock / Keeper | #6 x 1/2" starter screw and 3" screws (provided) | 1/4" x 3-1/2" Masonry Screw | Refer to installing the keeper instructions on page BMFFSD - 16 and illustrations below. | C |
| Pella 250 Series | Head / Jamb / Sill Frame Screws | | #10 x 2" Corrosion Resistant (provided) | 1/4" x 2" Masonry Screw | Drive screws at each pre-drilled installation hole. Apply sealant prior to driving screws in the sill. | A, B |
| | Head and Sill - Interlockers and Mullions | | #10 x 2" Corrosion Resistant (provided) | 3/16" x 1-1/2" Masonry Screw | Drive screws at each pre-drilled installation hole at interlockers. Pre-drill and drive screws on each side of mullions. Refer to the illustrations for location and spacing. Apply sealant prior to driving screws through the sill. | A, B |
| | Jamb | Strike / Lock | #8 x 2" (provided) | N/A | OX / XO / OOX / XOO: Drive screws at each hole in the lock strike (4 total). | C |
| | Astragal | Strike / Lock | #8 x 3/4" (provided) | N/A | OXO / OXXO: Drive screws at each hole in the lock strike (4 total). | C |



ANCHOR INSTRUCTIONS - FLUSH FLANGE INSTALLATION METHODS FOR PELLA® IMPERVIA SLIDING PATIO DOORS (INCLUDING IMPACT-RESISTANT)

NOTE: Standard performance only. Additional anchoring may be required for performance upgrade or to comply with local building code requirements.

| Location | | Anchor Type | | Instructions | Illustration | |
|---------------|--------------------------------|----------------------------|------------------------------|--|--------------|--|
| | | Wood | Masonry | | | |
| Head/ Jamb | Nail Fin* | 2", 11 Ga. Roofing Nail | N/A | Within 3.5" from each corner and 7" on center (every other pre-punched hole). All PG 35 and PG 50 up to 71.25" x 81.50" frame size. | A | |
| | Nail Fin with Frame Screws | #10 x 3" (provided) | 3/16" x 1-3/4" Masonry Screw | Use factory-drilled installation holes if present. Drill holes through both walls and into the rough opening using a 1/8" bit then drill a 3/8" hole through the first wall only. Required to meet PG 50 if >71.25" x frame width or >81.50" frame height. | | |
| | Frame Screws | #10 x 3" (provided) | 3/16" x 1-3/4" Masonry Screw | | | |
| | Installation Clips | #8 x 1 1/4" | 3/16" x 1 1/2" | Slide clips into slot from frame ends. Adhere clip with tape. Not applicable with nail fin | | |
| Sill | Frame Screws | #8 x 3" (provided) | 3/16" x 2 1/2" Masonry Screw | Remove inner sill cover. Use factory-drilled installation holes, pilot with 1/8" bit into rough opening. Apply sealant in each hole before driving screws. | C | |
| | Vent Panel Retainer Support | #8 x 3" (provided) | 3/16" x 2 1/2" Masonry Screw | Apply sealant in each hole before driving screws. Reinstall sill cover. | | |
| | Fixed Panel Structural Bracket | #10 x 3" (provided) | 3/16" x 2 1/2" Masonry Screw | Remove one factory-installed screw first. Pre-drill 3/16". Pilot with 1/8" bit into rough opening. Apply sealant in each hole before driving screws. | | |
| | Aluminum Support | #8 x 3/4" (provided) | NA | Available separately - consult your local Pella representative. | | |



INSTALLING THE KEEPER FOR PELLA® 250 SERIES, PELLA® 150 SERIES AND ENCOMPASS BY PELLA® SLIDING PATIO DOORS AND REVERSING DOOR SLIDE FOR PELLA® 150 SERIES AND ENCOMPASS BY PELLA®

KEEPER INSTALLATION FOR PELLA® 150 SERIES AND ENCOMPASS BY PELLA®:

D. **Identify the keeper** in the hardware package and perform the keeper attachment steps based on which keeper is in the package. Determine the keeper location by opening the panel a few inches and extending the lock hook. With a pencil, mark the location on the jamb directly across from the top of the shank.

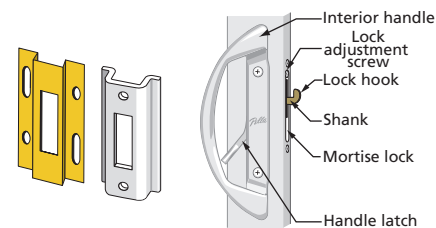

E. **Place the keeper with 4 screw holes** on the jamb so the top of the slot is aligned with the pencil mark. Attach by inserting a #6 x 1/2" starter screw into one of the slotted keeper holes.

F. **Place the keeper with 2 screw holes** on the jamb by "snapping" it into the frame jamb at the desired location. The keeper may be moved up or down to align with the pencil mark. The keeper will stay in position until attached with screws.

G. **Insert a shim** between the frame jamb and the rough opening at the keeper location.

H. **Adjust the lock hook** by turning the door lock adjustment screw clockwise to loosen or counter-clockwise to tighten until the mortise lock is aligned properly, the door locks easily, and there is less than 1/16" movement when the door is locked.

I. **Install the keeper** by inserting 3" long screws (provided) through the keeper holes, the shim and into the rough opening frame members. Remove the starter screw from the 4 screw hole keeper and replace it with a 3" long screw.

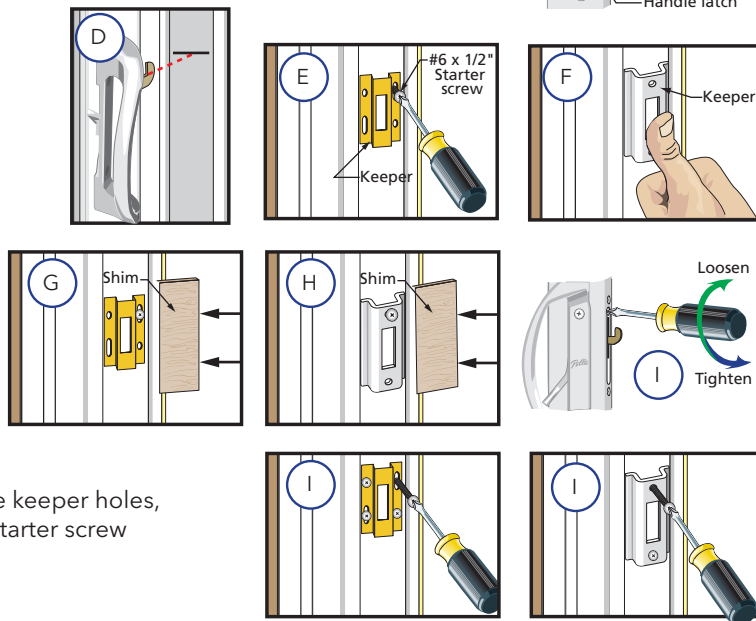

Note: Doors with Blinds-Between-the-Glass are not reversible.

REVERSING DOOR SLIDE FOR PELLA® 150 SERIES AND ENCOMPASS BY PELLA®:



Interior Sealant Instructions

CAUTION: Continuous backer rod (as necessary) and a high quality, low-odor interior sealant such as Pella Window and Door Installation Sealant (or equivalent) is recommended for commercial or high performance installations to create the continuous interior seal. Follow the directions on the cartridge. For standard performance or products with factory applied jamb extensions, use low pressure polyurethane insulating foams. Follow the directions on the can. Do not use high pressure or latex foams. Fiberglass batt or similar insulation is not recommended as it can absorb water and does not act as an air seal.

- Insert the nozzle or straw between the rough opening and door frame from the interior. Use a pliers (if necessary) to compress the end of a straw tube to allow it to fit in tight openings.
- Place a 1" deep bead of foam approximately 1" from the interior of the frame to allow for expansion. DO NOT fill the entire depth of the rough opening cavity.

NOTE: Apply foam between the frame and rough opening, NOT between jamb extensions and the rough opening.

- Re-Check door operation and remove remaining shipping spacers after foam installation. Excess foam may be removed with a serrated knife after it cures.
- To ensure a continuous interior seal, apply sealant over or around any shims or clips interrupting the foam seal.
- Place a continuous bead of sealant across the inner sill at the intersection of the door sill and subfloor. Continue the sealant 6" up each jamb.

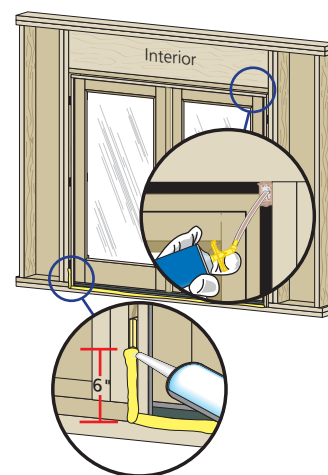

Exterior Sealant Instructions

CAUTION: Use a high quality, multi-purpose exterior sealant such as Pella Door and Door Installation Sealant. Follow the directions on the cartridge.

Flush Flange Doors:

- Place a corner bead of sealant on the edge of the flush flange on the top and sides.

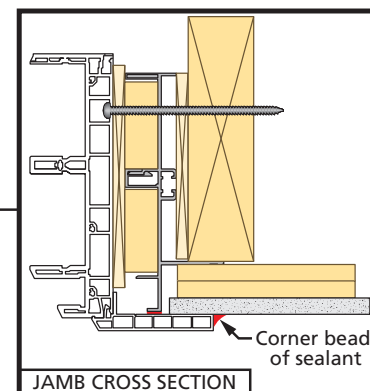
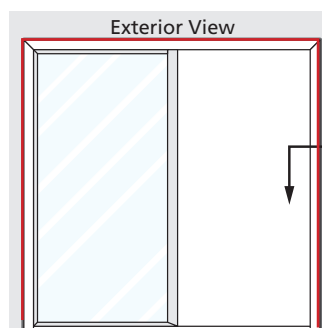



OPTIONAL SILL PAN INSTRUCTIONS

A. **Cut the sill pan** to the width of the rough opening plus 2".

NOTE: The 2" added onto the rough opening width is for a 1" bend on each end.

B. **Make a 1" cut** in each fold at both end of the sill pan.

NOTE: These cuts will allow the edges of the sill pan to be bent.

C. **Cut 1" off each end** of the interior sill pan lip.

D. **Bend each end** of the center panel up.

E. **Install the sill pan** by sliding into place until the exterior sill pan lip is flush with the exterior of the rough opening.

F. **Apply sill flashing tape.** Cut a piece of flashing tape 2" longer than the opening width. Apply at the bottom of the opening, covering the exterior sill pan lip as shown.

NOTE: If applicable, apply spray adhesive to building felt prior to applying the flashing tape.

G. **Cut a piece of flashing tape** to the width of the opening. Install tape to the sill pan and overlap the flashing tape from step 1F by 1". If needed add a second or third piece of flashing tape until the sill pan is covered to the interior sill pan lip.

NOTE: The purpose of this tape is to seal the sill screws when installing the door.

H. **Cut two 9" pieces of flashing tape** with a 1" x 3" tab at the bottom, on opposite corners as shown.

I. **Apply the tabbed 9" pieces of flashing tape.** The tape is applied so 2" will cover the inside of the rough opening and lap over the side flange of the sill pan. The 1" x 3" tab laps over the bottom flashing tape as shown.

J. **Cut two 6" pieces of flashing tape** and apply to each side of the rough opening, overlapping the first piece by 1" and lapping the bottom over the side flange of the sill pan as shown.

K. **Cut two pieces of flashing tape 1-1/2" x 6"** and apply to the bottom corners of the opening by beginning in the corner of the sill pan, with 3/4" of the tape applied to the sill pan and 3/4" of the tape applied to the side flange. The remainder of the tape is to be at a 45 degree angle onto